

site design group, ltd.

LAYOUT		
DRAWN		
REVIEWED		

TEMPORARY FENCING			
PAY ITEM 20101000			
STATION	OFFSET	FENCING LN FT	SIDE
1001	90.24	73	N
1002	64.8	69	N
1003	18.48	69	S
1003	65.46	69	S
1004	17.07	69	S
1004	61.66	69	S
1004	68.53	68	S
1004	68.76	71	S
1004	93.48	86	S
1005	99.25	66	S
1006	48.17	68	S
1006	51.73	66	N
1007	1.69	69	S
1007	13.51	68	N
1007	56.93	69	S
1007	65.36	73	S
1007	74.44	65	N
1008	63.38	67	N
1009	14.61	67	N
1010	14.55	68	N
1010	33.15	59	S
1011	12.83	74	N
1012	56.19	68	S
1014	33.68	67	N
1015	98.29	68	S
1016	51.71	56	N
1017	67.05	56	N
1018	15.63	66	S
1018	17.23	67	N
1018	74.87	68	N
1019	32.16	67	N
1019	91.96	69	N
1020	56.78	66	N
1021	18.84	67	S
1022	33.65	61	N
1022	76.53	69	N
1023	1.72	68	N
1023	37.77	68	N
1024	40.92	72	N
1024	48.58	69	S
1025	29.97	69	S
1025	75.55	69	S
1026	19.51	69	S
1026	61.28	69	S
1027	39.27	70	N
1027	48.57	69	S
1027	68.57	119	S
1027	81.27	N/A	S
1027	81.49	N/A	S
1027	96.48	156	N
1027	96.81	N/A	N
1027	98.92	N/A	N
1030	24.91	150	S
1030	24.94	58	N
1030	42.65	N/A	S
1030	62.46	N/A	S
1030	78.01	67	N
TOTAL LN FT		3679 LN FT	

LANDSCAPE SCHEDULE													
PLAN CODE	PAY ITEM	LAND PLN 1	LAND PLN 2	LAND PLN 3	LAND PLN 4	LAND PLN 5	UNION PLAN	TOTAL QUANTITY	BOTANICAL NAME	COMMON NAME	SIZE	ROOT	REMARKS
AS	A2001722	1	2				2	5	Acer saccharum 'Bailsta'	Fall Fiesta Sugar Maple	2.5" cal	B&B	matching heads
CO	A2002924		4					4	Celtis occidentalis	Common Hackberry	3"-4" cal	B&B	matching heads
QB	A2006524	3						3	Querus bicolor	Swamp White Oak	3"-4" cal	B&B	matching heads
CC	B2001167						6	6	Cercis canadensis	Eastern Redbud	8' ht	B&B	matching heads
TREES (SPECIAL)													
AG	XX006570		1			2		3	Acer saccharum 'Green Mountain'	Green Mountain Sugar Maple	3"-4" cal	B&B	matching heads
UF	XX006570			5				5	Ulmus 'Frontier'	Frontier Elm	3"-4" cal	B&B	matching heads
TT	XX006570				1			1	Tilia tomentosa	Silver Linden	3"-4" cal	B&B	matching heads
CB	XX006570						4	4	Carpinus betulus	Common Hornbeam	8' ht	B&B	matching heads
TOTAL TREES (SPECIAL) - XX006570								13	EACH				
SHRUBS													
HA	XX008639						137	137	Hydrangea arborescens	Smooth Hydrangea	#5	pot	36" o.c. per plan
SC	XX008639		13				223	236	Spiraea x cinerea 'Grefsheim'	Grefsheim Spirea	#5	pot	36" o.c. per plan
TOTAL SHRUBS - XX008639								373	EACH				
PERENNIALS, GALLON POT													
AH	K0012990						271	271	Amsonia hubrichtii	Threadleaf Bluestar	pot	#1	24" o.c.
CN	K0012990						529	529	Calamintha nepeta	Lesser Calamint	pot	#1	18" o.c.
GR	K0012990						424	424	Geranium 'Rozanne'	Rozanne Geranium	pot	#1	18" o.c.
SS	K0012990						725	725	Schizachyrium scoparium	Little Bluestem	pot	#1	18" o.c.
TOTAL PERENNIALS - K0012990								1949	EACH				
								19.49	UNIT				
PERENNIAL PLANTS, PRAIRIE TYPE, 2" DIAMETER BY 4" DEEP PLUG													
LS	K0013000				1870		3276	5146	Liriope spicata	Lilyturf	2"	plug	8" o.c.
TOTAL PERENNIALS - K0013000								5146	EACH				
								51.46	UNIT				

				25200110 SODDING, SALT TOLERANT	20101400 NITROGEN FERTILIZER NUTRIENT	20101500 PHOSPHORUS FERTILIZER NUTRIENT	20101600 POTASSIUM FERTILIZER NUTRIENT	25200200 SUPPLEMENTAL WATERING	21101615 TOPSOIL FURNISH AND PLACE, 4"	21101685 TOPSOIL FURNISH AND PLACE, 24"
				SQ YD	POUND	POUND	POUND	UNIT	SQ YD	SQ YD
STREET	STATION START	STATION STOP	SIDE							
WORK BETWEEN FRONT OF SIDEWALK - BACK OF CURB										
GREEN	1001+95.55	1003+8.27	N	250	3.10	3.10	3.10	2.50	250	
GREEN	1003+17.89	1004+57.13	N	213	2.64	2.64	2.64	2.13	213	
GREEN	1005+2.65	1007+93.45	N	262	3.24	3.24	3.24	2.62	262	
GREEN	1008+36.02	1010+35.10	N	177	2.19	2.19	2.19	1.77	177	
GREEN	1011+10.73	1011+46.72	N	27	0.34	0.34	0.34	0.27	27	
GREEN	1014+37.96	1014+92.39	N	43	0.53	0.53	0.53	0.43	43	
GREEN	1015+80.37	1018+85.53	N	269	3.34	3.34	3.34	2.69	269	
GREEN	1019+23.04	1019+54.79	N	28	0.35	0.35	0.35	0.28	28	
GREEN	1020+73.93	1021+14.04	N	31	0.39	0.39	0.39	0.31	31	
GREEN	1022+62.91	1024+61.04	N	168	2.08	2.08	2.08	1.68	168	
GREEN	1025+22.16	1026+93.45	N	151	1.88	1.88	1.88	1.51	151	
GREEN	1027+28.48	1027+84.38	N	46	0.56	0.56	0.56	0.46	46	
GREEN	1029+83.76	1030+86.29	N	61	0.75	0.75	0.75	0.61	61	
GREEN	1031+6.27	1031+16.95	N	8	0.10	0.10	0.10	0.08	8	
GREEN	1002+41.02	1004+59.32	S	243	3.01	3.01	3.01	2.43	243	
GREEN	1006+0.49	1007+80.14	S	92	1.14	1.14	1.14	0.92	92	
GREEN	1007+86.49	1008+18.66	S	57	0.71	0.71	0.71	0.57	57	
GREEN	1008+60.15	1010+35.96	S	311	3.85	3.85	3.85	3.11	311	
GREEN	1011+11.85	1014+93.14	S	341	4.23	4.23	4.23	3.41	341	
GREEN	1015+81.49	1016+63.58	S	65	0.81	0.81	0.81	0.65	65	
GREEN	1018+12.46	1018+37.25	S	17	0.22	0.22	0.22	0.17	17	
GREEN	1018+75.24	1019+48.40	S	65	0.80	0.80	0.80	0.65	65	
GREEN	1019+94.39	1020+53.87	S	53	0.66	0.66	0.66	0.53	53	
GREEN	1020+65.87	1023+54.32	S	252	3.12	3.12	3.12	2.52	252	
GREEN	1024+94.13	1025+14.17	S	15	0.19	0.19	0.19	0.15	15	
GREEN	1025+23.17	1027+85.89	S	231	2.86	2.86	2.86	2.31	231	
GREEN	1030+92+42	1031+24.64	S	13	0.16	0.16	0.16	0.13	13	
MATTHEWS	1100+63.99	1101+1.33	W	28	0.35	0.35	0.35	0.28	28	
MATTHEWS	1100+63.99	1100+96.44	E	21	0.27	0.27	0.27	0.21	21	
GOODWIN	1201+35.31	1201+54.08	W	14	0.18	0.18	0.18	0.14	14	
GREGORY	1250+44.1	1250+61.00	W	21	0.26	0.26	0.26	0.21	21	
		Subtotal		3575	44	44	44	36	3575	0
WORK BETWEEN BACK OF SIDEWALK - CONSTRUCTION LIMIT										
GREEN	Wright	Matthews	N	373	4.63	4.63	4.63	3.73	202	172
GREEN	Matthews	Goodwin	N	553	6.85	6.85	6.85	5.53	437	116
GREEN	Goodwin	Gregory	N	190	2.35	2.35	2.35	1.90	151	35
GREEN	Gregory	Lincoln	N	139	1.72	1.72	1.72	1.39	139	
GREEN	Wright	Matthews	S	1260	15.61	15.61	15.61	12.60	1015	245
GREEN	Matthews	Goodwin	S	34	0.43	0.43	0.43	0.34	34	
GREEN	Goodwin	Lincoln	S	833	10.33	10.33	10.33	8.33	736	97
		Subtotal		3382	42	42	42	34	2714	665
		TOTAL		6958	86	86	86	70	6289	665

				K1005481 SHREDDED BARK MULCH 3"	X0327802 PLANTING SOIL MIX FURNISH AND PLACE, 12"
				SQ YD	SQ YD
	STATION START	STATION STOP	SIDE		
WORK BETWEEN FRONT OF SIDEWALK - BACK OF CURB					
GREEN	1002+79.27	1003+10.80	N	25.44	25.44
GREEN	1004+78.95	1006+76.51	MEDIAN	212.11	212.11
GREEN	1011+44.10	1011+94.37	N	69.67	69.67
GREEN	1014+18.70	1014+35.11	N	8.67	8.67
GREEN	1021+09.90	1021+63.18	N	66.22	66.22
GREEN	1022+28.73	1022+59.18	N	17.78	17.78
GREEN	1004+95.20	1005+27.63	S	31.33	31.33
GREEN	1007+88.94	1007+97.04	S	3.67	3.67
GREEN	1016+67.33	1016+97.78	S	17.78	17.78
GREEN	1017+63.33	1018+16.61	S	66.22	66.22
GREEN	1020+11.17	1021+16.66	MEDIAN	79.89	79.89
GREEN	1023+58.06	1023+88.51	S	17.78	17.78
GREEN	1024+54.07	1024+96.61	S	50.78	50.78
WORK BETWEEN BACK OF SIDEWALK - CONSTRUCTION LIMITS					
GREEN	Goodwin	Gregory	N	9	9
GREEN	Wright	Matthews	S	828	828
GREEN	Goodwin	Lincoln	S	18	18
		TOTAL		1522.44	1522.33

FILE NAME = \$FILEL\$				DESIGNED - BK	REVISED -	STATE OF ILLINOIS DEPARTMENT OF TRANSPORTATION				LANDSCAPE SCHEDULE				F.A.U. RTE.	SECTION	COUNTY	TOTAL SHEETS	SHEET NO.
PLOT DATE = \$DATES \$TIMES				DRAWN - JR	REVISED -										15-00304-01-PV	CHAMPAIGN	236	127
				CHECKED - BM	REVISED -										MCORE PROJECT 1	CONTRACT NO.91539		
				DATE - MARCH 2016	REVISED -					SCALE: 1"=20'	SHEET NO. 127 OF 236 SHEETS	STA.	TO STA.	JOB NO. C-95-305-16 ILLINOIS FED. AID PROJECT TIC-51810571				

LAYOUT	
DRAWN	
REVIEWED	

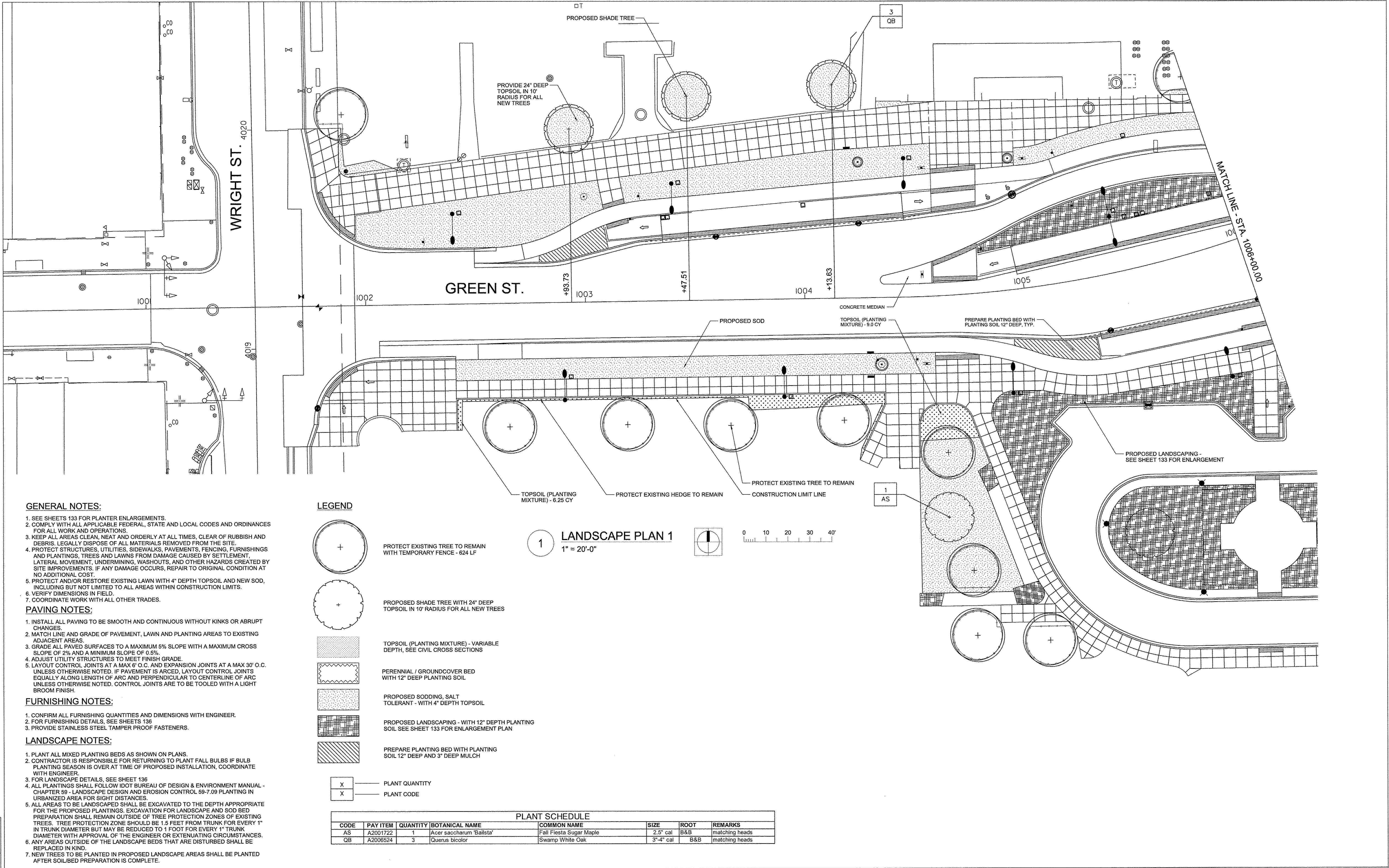

FILE NAME = P1-sht-GRNE-land01.dgn	DESIGNED - BK	REVISED -	STATE OF ILLINOIS DEPARTMENT OF TRANSPORTATION	LANDSCAPE PLAN - GREEN STREET		F.A.U. RTE.	SECTION	COUNTY	TOTAL SHEETS	SHEET NO.
PLOT DATE = 3/23/2016 11:41:03 AM	DRAWN - JR	REVISED -					15-00304-01-PV	CHAMPAIGN	236	128
	CHECKED - BM	REVISED -		SCALE: 1"=20'		SHEET NO. 128 OF 236 SHEETS		STA. TO STA. 1006+00.00		
	DATE - MARCH 2016	REVISED -						JOB NO. C-95-305-16 ILLINOIS FED. AID PROJECT TIG-518(0571)		



FILE NAME =	DESIGNED - BK	REVISED -
P1-sht-GRNE-1and02.dgn	DRAWN - JR	REVISED -
PLOT DATE =	CHECKED - BM	REVISED -
3/23/2016 11:42:07 AM	DATE - MARCH 2016	REVISED -

SCALE: : 1"=20'	SHEET NO. 129 OF 236 SHEETS	STA. 1006+00.00 TO STA. 1011+50.00
-----------------	-----------------------------	------------------------------------

F.A.U. RTE.	SECTION	COUNTY	TOTAL SHEETS	SHEET NO.
	15-00304-01-PV	CHAMPAIGN	236	129
MCORE PROJECT 1		CONTRACT NO.91539		
JOB NO. C-95-305-16	ILLINOIS	FED. AID PROJECT TIG-518(057)		

LAYOUT	
DRAWN	
REVIEWED	

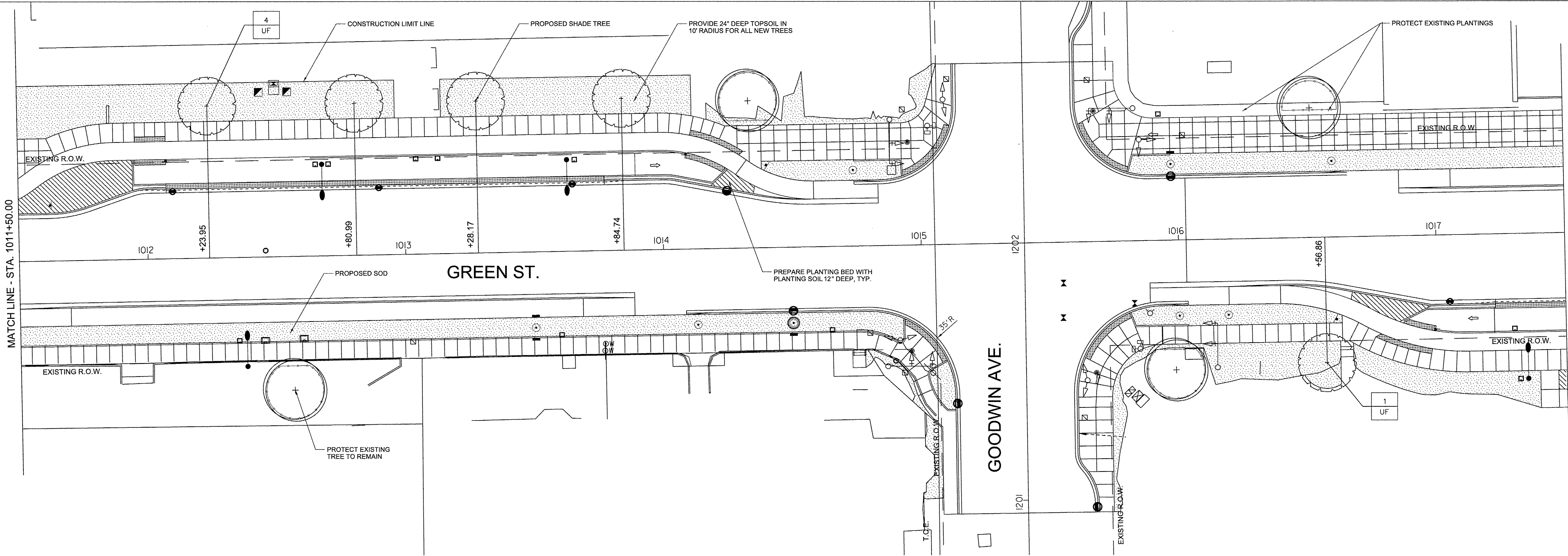

GENERAL NOTES:

1. SEE SHEETS 133 FOR PLANTER ENLARGEMENTS.
2. COMPLY WITH ALL APPLICABLE FEDERAL, STATE AND LOCAL CODES AND ORDINANCES FOR ALL WORK AND OPERATIONS.
3. KEEP ALL AREAS CLEAN, NEAT AND ORDERLY AT ALL TIMES. CLEAR OF RUBBISH AND DEBRIS. LEGALLY DISPOSE OF ALL MATERIALS REMOVED FROM THE SITE.
4. PROTECT STRUCTURES, UTILITIES, SIDEWALKS, PAVEMENTS, FENCING, FURNISHINGS AND PLANTINGS, TREES AND LAWNS FROM DAMAGE CAUSED BY SETTLEMENT, LATERAL MOVEMENT, UNDERMINING, WASHOUTS, AND OTHER HAZARDS CREATED BY SITE IMPROVEMENTS. IF ANY DAMAGE OCCURS, REPAIR TO ORIGINAL CONDITION AT NO ADDITIONAL COST.
5. PROTECT AND/OR RESTORE EXISTING LAWN WITH 4" DEPTH TOPSOIL AND NEW SOD, INCLUDING BUT NOT LIMITED TO ALL AREAS WITHIN CONSTRUCTION LIMITS.
6. VERIFY DIMENSIONS IN FIELD.
7. COORDINATE WORK WITH ALL OTHER TRADES.

PAVING NOTES:

1. INSTALL ALL PAVING TO BE SMOOTH AND CONTINUOUS WITHOUT KINKS OR ABRUPT CHANGES.
2. MATCH LINE AND GRADE OF PAVEMENT, LAWN AND PLANTING AREAS TO EXISTING ADJACENT AREAS.
3. GRADE ALL PAVED SURFACES TO A MAXIMUM 5% SLOPE WITH A MAXIMUM CROSS SLOPE OF 2% AND A MINIMUM SLOPE OF 0.5%.
4. ADJUST UTILITY STRUCTURES TO MEET FINISH GRADE.
5. LAYOUT CONTROL JOINTS AT A MAX 6' O.C. AND EXPANSION JOINTS AT A MAX 30' O.C. UNLESS OTHERWISE NOTED. IF PAVEMENT IS ARCED, LAYOUT CONTROL JOINTS EQUALLY ALONG LENGTH OF ARC AND PERPENDICULAR TO CENTERLINE OF ARC UNLESS OTHERWISE NOTED. CONTROL JOINTS ARE TO BE TOOLED WITH A LIGHT BROOM FINISH.

FURNISHING NOTES:

1. CONFIRM ALL FURNISHING QUANTITIES AND DIMENSIONS WITH ENGINEER.
2. FOR FURNISHING DETAILS, SEE SHEETS 136.
3. PROVIDE STAINLESS STEEL TAMPER PROOF FASTENERS.

LANDSCAPE NOTES:

1. PLANT ALL MIXED PLANTING BEDS AS SHOWN ON PLANS.
2. CONTRACTOR IS RESPONSIBLE FOR RETURNING TO PLANT FALL BULBS IF BULB PLANTING SEASON IS OVER AT TIME OF PROPOSED INSTALLATION, COORDINATE WITH ENGINEER.
3. FOR LANDSCAPE DETAILS, SEE SHEET 136.
4. ALL PLANTINGS SHALL FOLLOW IDOT BUREAU OF DESIGN & ENVIRONMENT MANUAL - CHAPTER 59 - LANDSCAPE DESIGN AND EROSION CONTROL 59-7.09 PLANTING IN URBANIZED AREA FOR SIGHT DISTANCES.
5. ALL AREAS TO BE LANDSCAPED SHALL BE EXCAVATED TO THE DEPTH APPROPRIATE FOR THE PROPOSED PLANTINGS. EXCAVATION FOR LANDSCAPE AND SOD BED PREPARATION SHALL REMAIN OUTSIDE OF TREE PROTECTION ZONES OF EXISTING TREES. TREE PROTECTION ZONE SHOULD BE 1.5 FEET FROM TRUNK FOR EVERY 1" IN TRUNK DIAMETER BUT MAY BE REDUCED TO 1 FOOT FOR EVERY 1" TRUNK DIAMETER WITH APPROVAL OF THE ENGINEER OR EXTENUATING CIRCUMSTANCES.
6. ANY AREAS OUTSIDE OF THE LANDSCAPE BEDS THAT ARE DISTURBED SHALL BE REPLACED IN KIND.
7. NEW TREES TO BE PLANTED IN PROPOSED LANDSCAPE AREAS SHALL BE PLANTED AFTER SOIL/BED PREPARATION IS COMPLETE.

LEGEND

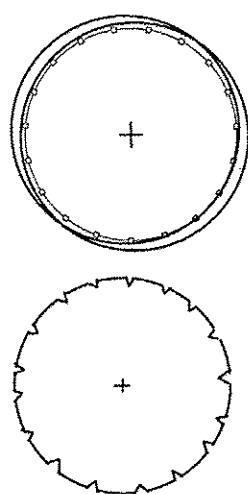

PROTECT EXISTING TREE TO REMAIN
WITH TEMPORARY FENCE - 260 LF

PROPOSED SHADE TREE WITH 24" DEEP
TOPSOIL IN 10' RADIUS FOR ALL NEW TREES



TOPSOIL (PLANTING MIXTURE) - VARIABLE
DEPTH, SEE CIVIL CROSS SECTIONS

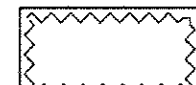

PERENNIAL / GROUNDCOVER BED
WITH 12" DEEP PLANTING SOIL

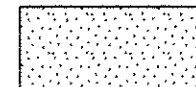

PROPOSED SODDING, SALT TOLERANT
- WITH 4" DEPTH TOPSOIL

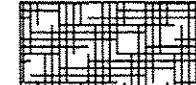

PROPOSED LANDSCAPING - WITH 12" DEPTH PLANTING
SOIL SEE SHEET 133 FOR ENLARGEMENT PLAN



PREPARE PLANTING BED WITH PLANTING
SOIL 12" DEEP AND 3" DEEP MULCH

X	PLANT QUANTITY
X	PLANT CODE

1 LANDSCAPE PLAN 3
1" = 20'-0"

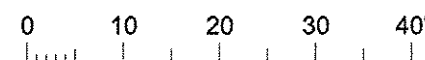
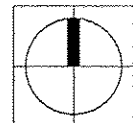

PLANT SCHEDULE						
CODE	PAY ITEM	QUANTITY	BOTANICAL NAME	COMMON NAME	SIZE	ROOT
UF	XX006570	5	Ulmus 'Frontier'	Frontier Elm	3"-4" cal	B&B

REMARKS
matching heads

FILE NAME =
P1-sht-GRNE-1and03.dgn

PLOT DATE =
3/23/2016 11:42:56 AM

DESIGNED - BK
DRAWN - JR
CHECKED - BM
DATE - MARCH 2016

REVISED -
REVISED -
REVISED -
REVISED -

STATE OF ILLINOIS
DEPARTMENT OF TRANSPORTATION

LANDSCAPE PLAN - GREEN STREET

SCALE: 1"=20' SHEET NO. 130 OF 236 SHEETS STA. 1011+50.00 TO STA. 1017+50.00

F.A.U. RTE.	SECTION	COUNTY	TOTAL SHEETS	SHEET NO.
	I5-00304-01-PV	CHAMPAIGN	236	130
MCORE PROJECT I		CONTRACT NO.91539		
JOB NO. C-95-305-16	ILLINOIS	FED. AID PROJECT TIG-518(057)		

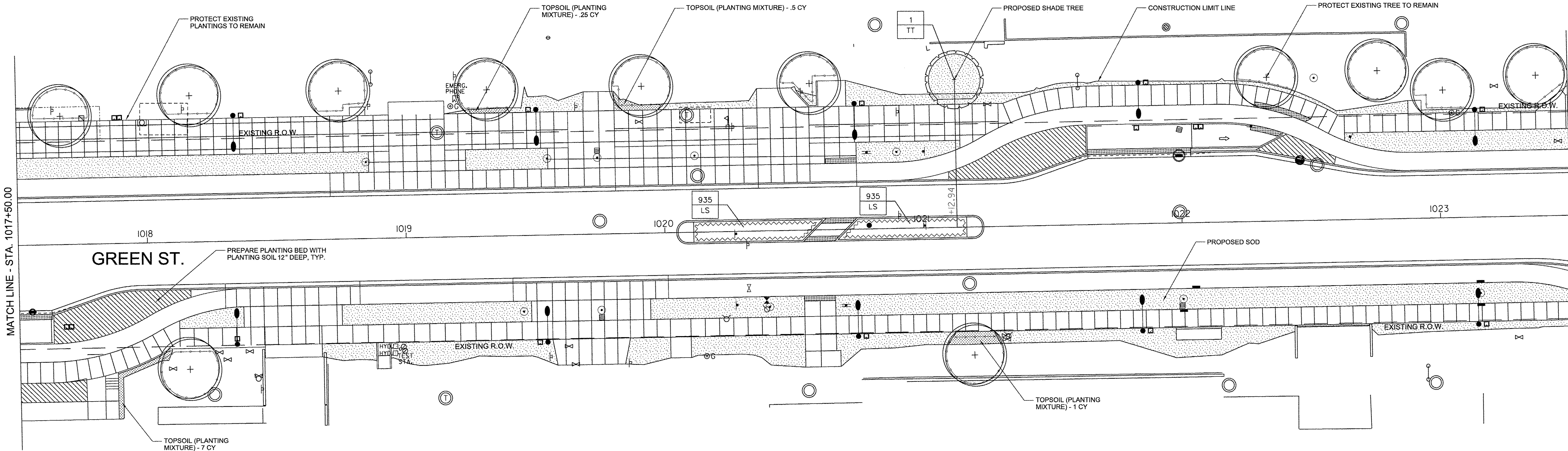

GENERAL NOTES:

1. SEE SHEETS 133 FOR PLANTER ENLARGEMENTS.
2. COMPLY WITH ALL APPLICABLE FEDERAL, STATE AND LOCAL CODES AND ORDINANCES FOR ALL WORK AND OPERATIONS.
3. KEEP ALL AREAS CLEAN, NEAT AND ORDERLY AT ALL TIMES, CLEAR OF RUBBISH AND DEBRIS. LEGALLY DISPOSE OF ALL MATERIALS REMOVED FROM THE SITE.
4. PROTECT STRUCTURES, UTILITIES, SIDEWALKS, PAVEMENTS, FENCING, FURNISHINGS AND PLANTINGS, TREES AND LAWNS FROM DAMAGE CAUSED BY SETTLEMENT, LATERAL MOVEMENT, UNDERMINING, WASHOUTS, AND OTHER HAZARDS CREATED BY SITE IMPROVEMENTS. IF ANY DAMAGE OCCURS, REPAIR TO ORIGINAL CONDITION AT NO ADDITIONAL COST.
5. PROTECT AND/OR RESTORE EXISTING LAWN WITH 4" DEPTH TOPSOIL AND NEW SOD, INCLUDING BUT NOT LIMITED TO ALL AREAS WITHIN CONSTRUCTION LIMITS.
6. VERIFY DIMENSIONS IN FIELD.
7. COORDINATE WORK WITH ALL OTHER TRADES.

PAVING NOTES:

1. INSTALL ALL PAVING TO BE SMOOTH AND CONTINUOUS WITHOUT KINKS OR ABRUPT CHANGES.
2. MATCH LINE AND GRADE OF PAVEMENT, LAWN AND PLANTING AREAS TO EXISTING ADJACENT AREAS.
3. GRADE ALL PAVED SURFACES TO A MAXIMUM 5% SLOPE WITH A MAXIMUM CROSS SLOPE OF 2% AND A MINIMUM SLOPE OF 0.5%.
4. ADJUST UTILITY STRUCTURES TO MEET FINISH GRADE.
5. LAYOUT CONTROL JOINTS AT A MAX 6' O.C. AND EXPANSION JOINTS AT A MAX 30' O.C. UNLESS OTHERWISE NOTED. IF PAVEMENT IS ARCED, LAYOUT CONTROL JOINTS EQUALLY ALONG LENGTH OF ARC AND PERPENDICULAR TO CENTERLINE OF ARC UNLESS OTHERWISE NOTED. CONTROL JOINTS ARE TO BE TOOLED WITH A LIGHT BROOM FINISH.

FURNISHING NOTES:

1. CONFIRM ALL FURNISHING QUANTITIES AND DIMENSIONS WITH ENGINEER.
2. FOR FURNISHING DETAILS, SEE SHEETS 136
3. PROVIDE STAINLESS STEEL TAMPER PROOF FASTENERS.

LANDSCAPE NOTES:

1. PLANT ALL MIXED PLANTING BEDS AS SHOWN ON PLANS.
2. CONTRACTOR IS RESPONSIBLE FOR RETURNING TO PLANT FALL BULBS IF BULB PLANTING SEASON IS OVER AT TIME OF PROPOSED INSTALLATION, COORDINATE WITH ENGINEER.
3. FOR LANDSCAPE DETAILS, SEE SHEET 136
4. ALL PLANTINGS SHALL FOLLOW IDOT BUREAU OF DESIGN & ENVIRONMENT MANUAL - CHAPTER 59 - LANDSCAPE DESIGN AND EROSION CONTROL 59-7.09 PLANTING IN URBANIZED AREA FOR SIGHT DISTANCES.
5. ALL AREAS TO BE LANDSCAPED SHALL BE EXCAVATED TO THE DEPTH APPROPRIATE FOR THE PROPOSED PLANTINGS. EXCAVATION FOR LANDSCAPE AND SOD BED PREPARATION SHALL REMAIN OUTSIDE OF TREE PROTECTION ZONES OF EXISTING TREES. TREE PROTECTION ZONE SHOULD BE 1.5 FEET FROM TRUNK FOR EVERY 1" IN TRUNK DIAMETER BUT MAY BE REDUCED TO 1 FOOT FOR EVERY 1" TRUNK DIAMETER WITH APPROVAL OF THE ENGINEER OR EXTENUATING CIRCUMSTANCES.
6. ANY AREAS OUTSIDE OF THE LANDSCAPE BEDS THAT ARE DISTURBED SHALL BE REPLACED IN KIND.
7. NEW TREES TO BE PLANTED IN PROPOSED LANDSCAPE AREAS SHALL BE PLANTED AFTER SOIL/BED PREPARATION IS COMPLETE.

LEGEND

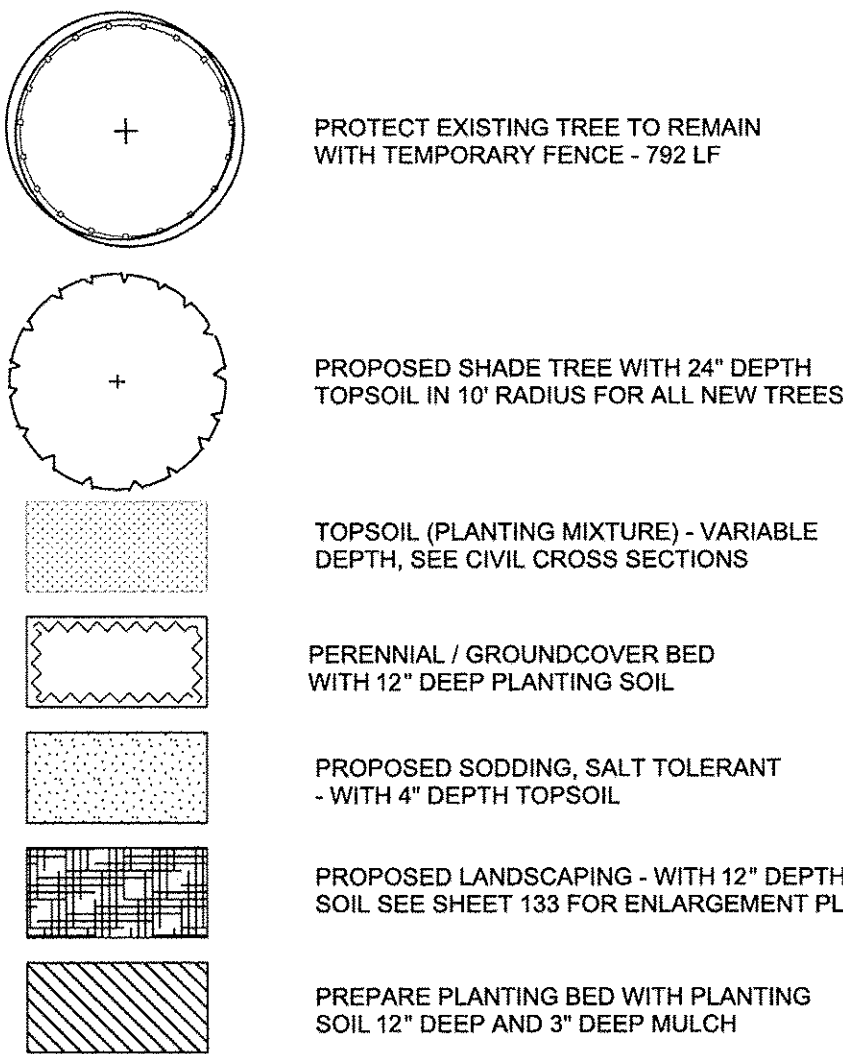

- X — PLANT QUANTITY
X — PLANT CODE

1 LANDSCAPE PLAN 4
1" = 20'-0"

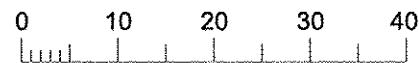
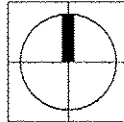

PLANT SCHEDULE

CODE	PAY ITEM	QUANTITY	BOTANICAL NAME	COMMON NAME	SIZE	ROOT	REMARKS
TT	XX006570	1	Tilia tomentosa	Silver Linden	3'-4" cal	B&B	matching heads
LS	K0013000	1870	Liriope spicata	Lilyturf	2"	plug	8" o.c.

LAYOUT	
DRAWN	
REVIEWED	

FILE NAME =
P1-sht-GRNE-land04.dgn

PLOT DATE =
3/23/2016 11:44:01 AM

DESIGNED - BK
DRAWN - JR
CHECKED - BM
DATE - MARCH 2016

REVISED -
REVISED -
REVISED -
REVISED -

STATE OF ILLINOIS
DEPARTMENT OF TRANSPORTATION

LANDSCAPE PLAN - GREEN STREET

SCALE: 1"=20' SHEET NO. 131 OF 236 SHEETS STA. 1017+50.00 TO STA. 1023+50.00

F.A.U. RTE.	SECTION	COUNTY	TOTAL SHEETS	SHEET NO.
	I5-00304-01-PV	CHAMPAIGN	236	131
MCORE PROJECT I		CONTRACT NO.91539		
JOB NO. C-95-305-16		ILLINOIS	FED. AID PROJECT TIG-5181057	

LAYOUT	
DRAWN	
REVIEWED	

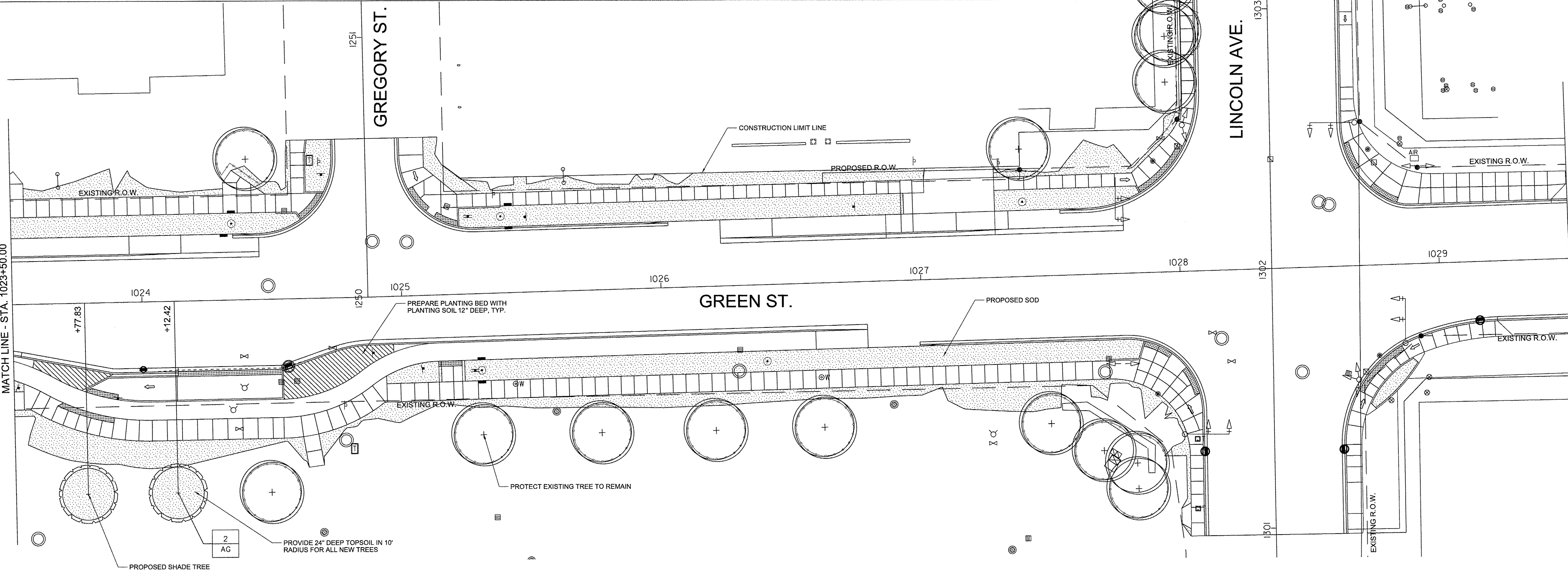

GENERAL NOTES:

1. SEE SHEETS 133 FOR PLANTER ENLARGEMENTS.
2. COMPLY WITH ALL APPLICABLE FEDERAL, STATE AND LOCAL CODES AND ORDINANCES FOR ALL WORK AND OPERATIONS.
3. KEEP ALL AREAS CLEAN, NEAT AND ORDERLY AT ALL TIMES. CLEAR OF RUBBISH AND DEBRIS. LEGALLY DISPOSE OF ALL MATERIALS REMOVED FROM THE SITE.
4. PROTECT STRUCTURES, UTILITIES, SIDEWALKS, PAVEMENTS, FENCING, FURNISHINGS AND PLANTINGS, TREES AND LAWNS FROM DAMAGE CAUSED BY SETTLEMENT, LATERAL MOVEMENT, UNDERMINING, WASHOUTS, AND OTHER HAZARDS CREATED BY SITE IMPROVEMENTS. IF ANY DAMAGE OCCURS, REPAIR TO ORIGINAL CONDITION AT NO ADDITIONAL COST.
5. PROTECT AND/OR RESTORE EXISTING LAWN WITH 4" DEPTH TOPSOIL AND NEW SOD, INCLUDING BUT NOT LIMITED TO ALL AREAS WITHIN CONSTRUCTION LIMITS.
6. VERIFY DIMENSIONS IN FIELD.
7. COORDINATE WORK WITH ALL OTHER TRADES.

PAVING NOTES:

1. INSTALL ALL PAVING TO BE SMOOTH AND CONTINUOUS WITHOUT KINKS OR ABRUPT CHANGES.
2. MATCH LINE AND GRADE OF PAVEMENT, LAWN AND PLANTING AREAS TO EXISTING ADJACENT AREAS.
3. GRADE ALL PAVED SURFACES TO A MAXIMUM 5% SLOPE WITH A MAXIMUM CROSS SLOPE OF 2% AND A MINIMUM SLOPE OF 0.5%.
4. ADJUST UTILITY STRUCTURES TO MEET FINISH GRADE.
5. LAYOUT CONTROL JOINTS AT A MAX 6' O.C. AND EXPANSION JOINTS AT A MAX 30' O.C. UNLESS OTHERWISE NOTED. IF PAVEMENT IS ARCED, LAYOUT CONTROL JOINTS EQUALLY ALONG LENGTH OF ARC AND PERPENDICULAR TO CENTERLINE OF ARC UNLESS OTHERWISE NOTED. CONTROL JOINTS ARE TO BE TOOLED WITH A LIGHT BROOM FINISH.

FURNISHING NOTES:

1. CONFIRM ALL FURNISHING QUANTITIES AND DIMENSIONS WITH ENGINEER.
2. FOR FURNISHING DETAILS, SEE SHEETS 136
3. PROVIDE STAINLESS STEEL TAMPER PROOF FASTENERS.

LANDSCAPE NOTES:

1. PLANT ALL MIXED PLANTING BEDS AS SHOWN ON PLANS.
2. CONTRACTOR IS RESPONSIBLE FOR RETURNING TO PLANT FALL BULBS IF BULB PLANTING SEASON IS OVER AT TIME OF PROPOSED INSTALLATION, COORDINATE WITH ENGINEER.
3. FOR LANDSCAPE DETAILS, SEE SHEET 136
4. ALL PLANTINGS SHALL FOLLOW IDOT BUREAU OF DESIGN & ENVIRONMENT MANUAL - CHAPTER 59 - LANDSCAPE DESIGN AND EROSION CONTROL 59-7.09 PLANTING IN URBANIZED AREA FOR SIGHT DISTANCES.
5. ALL AREAS TO BE LANDSCAPED SHALL BE EXCAVATED TO THE DEPTH APPROPRIATE FOR THE PROPOSED PLANTINGS. EXCAVATION FOR LANDSCAPE AND SOD BED PREPARATION SHALL REMAIN OUTSIDE OF TREE PROTECTION ZONES OF EXISTING TREES. TREE PROTECTION ZONE SHOULD BE 1.5 FEET FROM TRUNK FOR EVERY 1" IN TRUNK DIAMETER BUT MAY BE REDUCED TO 1 FOOT FOR EVERY 1" TRUNK DIAMETER WITH APPROVAL OF THE ENGINEER OR EXTENUATING CIRCUMSTANCES.
6. ANY AREAS OUTSIDE OF THE LANDSCAPE BEDS THAT ARE DISTURBED SHALL BE REPLACED IN KIND.
7. NEW TREES TO BE PLANTED IN PROPOSED LANDSCAPE AREAS SHALL BE PLANTED AFTER SOIL/BED PREPARATION IS COMPLETE.

LEGEND

- PROTECT EXISTING TREE TO REMAIN WITH TEMPORARY FENCE - 831 LF
- PROPOSED SHADE TREE WITH 24" DEEP TOPSOIL IN 10' RADIUS FOR ALL NEW TREES
- ORNAMENTAL SHRUBS
- TOPSOIL (PLANTING MIXTURE) - VARIABLE DEPTH, SEE CIVIL CROSS SECTIONS
- PERENNIAL / GROUNDCOVER BED WITH 12" DEEP PLANTING SOIL
- PROPOSED SODDING, SALT TOLERANT - WITH 4" DEPTH TOPSOIL
- PROPOSED LANDSCAPING - WITH 12" DEPTH PLANTING SOIL SEE SHEET 133 FOR ENLARGEMENT PLAN
- PREPARE PLANTING BED WITH PLANTING SOIL 12" DEEP AND 3" DEEP MULCH
- PLANT QUANTITY
- PLANT CODE

1 LANDSCAPE PLAN 5
1" = 20'-0"

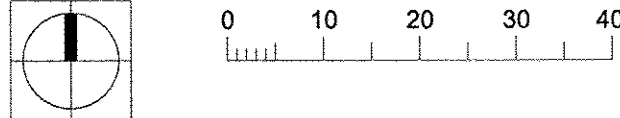

PLANT SCHEDULE							
CODE	PAY ITEM	QUANTITY	BOTANICAL NAME	COMMON NAME	SIZE	ROOT	REMARKS
AG	XX006570	2	Acer saccharum 'Green Mountain'	Green Mountain Sugar Maple	3"-4" cal	B&B	matching heads

FILE NAME =	DESIGNED - BK	REVISED -
P1-sht-GRNE-land05.dgn	DRAWN - JR	REVISED -
PLOT DATE =	CHECKED - BM	REVISED -
3/23/2016 2:40:51 PM	DATE - MARCH 2016	REVISED -

DESIGNED - BK	REVISED -
DRAWN - JR	REVISED -
CHECKED - BM	REVISED -
DATE - MARCH 2016	REVISED -

STATE OF ILLINOIS
DEPARTMENT OF TRANSPORTATION

LANDSCAPE PLAN - GREEN STREET

SCALE: 1"=20' SHEET NO. 132 OF 236 SHEETS STA. 1023+50.00 TO STA. 1029+50.00

F.A.U. RTE.	SECTION	COUNTY	TOTAL SHEETS	SHEET NO.
	I5-00304-01-PV	CHAMPAIGN	236	132
MCORE PROJECT I		CONTRACT NO.91539		
JOB NO. C-95-305-16		ILLINOIS	FED. AID PROJECT TIG-51810571	

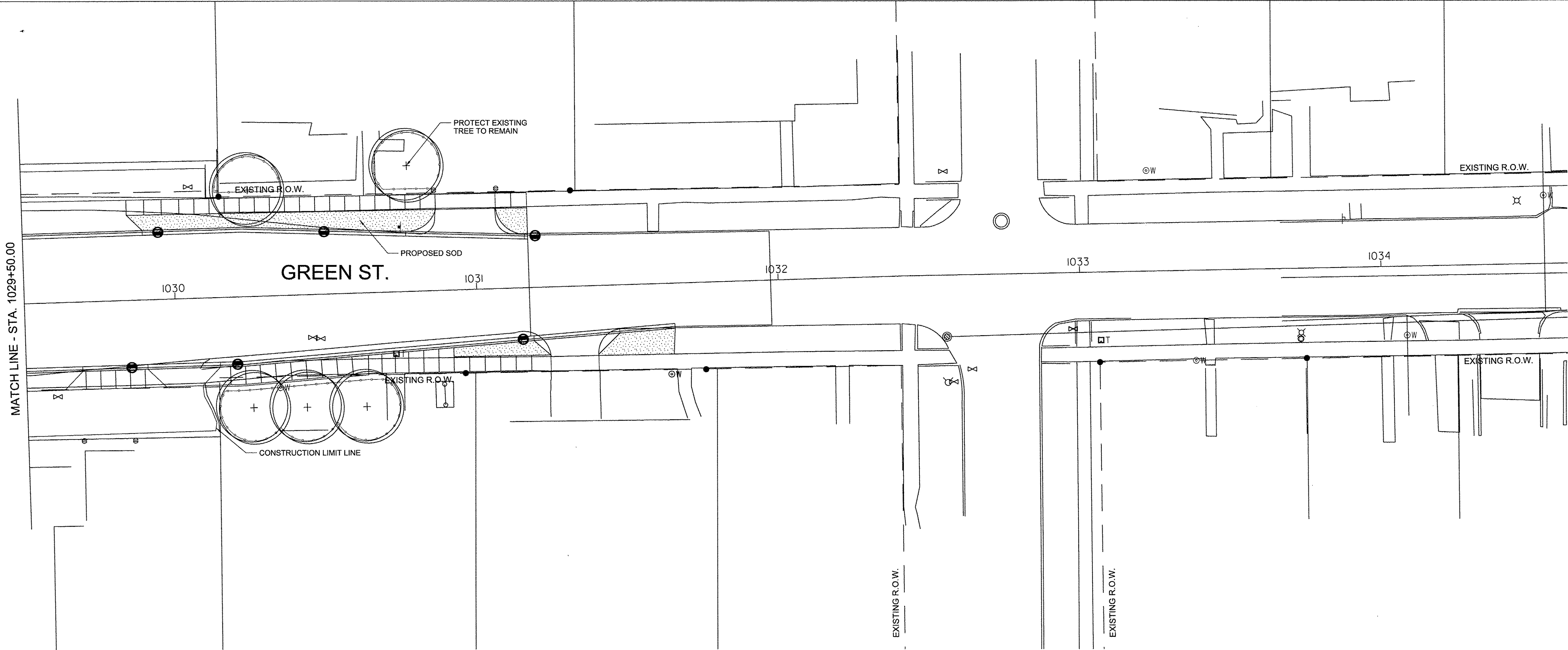

GENERAL NOTES:

- 1. SEE SHEETS 133 FOR PLANTER ENLARGEMENTS.
- 2. COMPLY WITH ALL APPLICABLE FEDERAL, STATE AND LOCAL CODES AND ORDINANCES FOR ALL WORK AND OPERATIONS.
- 3. KEEP ALL AREAS CLEAN, NEAT AND ORDERLY AT ALL TIMES. CLEAR OF RUBBISH AND DEBRIS. LEGALLY DISPOSE OF ALL MATERIALS REMOVED FROM THE SITE.
- 4. PROTECT STRUCTURES, UTILITIES, SIDEWALKS, PAVEMENTS, FENCING, FURNISHINGS AND PLANTINGS. TREES AND LAWNS FROM DAMAGE CAUSED BY SETTLEMENT, LATERAL MOVEMENT, UNDERMINING, WASHOUTS, AND OTHER HAZARDS CREATED BY SITE IMPROVEMENTS. IF ANY DAMAGE OCCURS, REPAIR TO ORIGINAL CONDITION AT NO ADDITIONAL COST.
- 5. PROTECT AND/OR RESTORE EXISTING LAWN WITH 4" DEPTH TOPSOIL AND NEW SOD, INCLUDING BUT NOT LIMITED TO ALL AREAS WITHIN CONSTRUCTION LIMITS.
- 6. VERIFY DIMENSIONS IN FIELD.
- 7. COORDINATE WORK WITH ALL OTHER TRADES.

PAVING NOTES:

- 1. INSTALL ALL PAVING TO BE SMOOTH AND CONTINUOUS WITHOUT KINKS OR ABRUPT CHANGES.
- 2. MATCH LINE AND GRADE OF PAVEMENT, LAWN AND PLANTING AREAS TO EXISTING ADJACENT AREAS.
- 3. GRADE ALL PAVED SURFACES TO A MAXIMUM 5% SLOPE WITH A MAXIMUM CROSS SLOPE OF 2% AND A MINIMUM SLOPE OF 0.5%.
- 4. ADJUST UTILITY STRUCTURES TO MEET FINISH GRADE.
- 5. LAYOUT CONTROL JOINTS AT A MAX 6' O.C. AND EXPANSION JOINTS AT A MAX 30' O.C. UNLESS OTHERWISE NOTED. IF PAVEMENT IS ARCED, LAYOUT CONTROL JOINTS EQUALLY ALONG LENGTH OF ARC AND PERPENDICULAR TO CENTERLINE OF ARC UNLESS OTHERWISE NOTED. CONTROL JOINTS ARE TO BE TOOLED WITH A LIGHT BROOM FINISH.

FURNISHING NOTES:

- 1. CONFIRM ALL FURNISHING QUANTITIES AND DIMENSIONS WITH ENGINEER.
- 2. FOR FURNISHING DETAILS, SEE SHEETS 136
- 3. PROVIDE STAINLESS STEEL TAMPER PROOF FASTENERS.

LANDSCAPE NOTES:

- 1. PLANT ALL MIXED PLANTING BEDS AS SHOWN ON PLANS.
- 2. CONTRACTOR IS RESPONSIBLE FOR RETURNING TO PLANT FALL BULBS IF BULB PLANTING SEASON IS OVER AT TIME OF PROPOSED INSTALLATION, COORDINATE WITH ENGINEER.
- 3. FOR LANDSCAPE DETAILS, SEE SHEET 136
- 4. ALL PLANTINGS SHALL FOLLOW IDOT BUREAU OF DESIGN & ENVIRONMENT MANUAL - CHAPTER 59 - LANDSCAPE DESIGN AND EROSION CONTROL 59-7.09 PLANTING IN URBANIZED AREA FOR SIGHT DISTANCES.
- 5. ALL AREAS TO BE LANDSCAPED SHALL BE EXCAVATED TO THE DEPTH APPROPRIATE FOR THE PROPOSED PLANTINGS. EXCAVATION FOR LANDSCAPE AND SOD BED PREPARATION SHALL REMAIN OUTSIDE OF TREE PROTECTION ZONES OF EXISTING TREES. TREE PROTECTION ZONE SHOULD BE 1.5 FEET FROM TRUNK FOR EVERY 1" IN TRUNK DIAMETER BUT MAY BE REDUCED TO 1 FOOT FOR EVERY 1" TRUNK DIAMETER WITH APPROVAL OF THE ENGINEER OR EXTENUATING CIRCUMSTANCES.
- 6. ANY AREAS OUTSIDE OF THE LANDSCAPE BEDS THAT ARE DISTURBED SHALL BE REPLACED IN KIND.
- 7. NEW TREES TO BE PLANTED IN PROPOSED LANDSCAPE AREAS SHALL BE PLANTED AFTER SOIL/BED PREPARATION IS COMPLETE.

LEGEND

PROTECT EXISTING TREE TO REMAIN WITH TEMPORARY FENCE - 275 LF

PROPOSED SHADE TREE WITH 24" DEEP TOPSOIL IN 10' RADIUS FOR ALL NEW TREES

TOPSOIL (PLANTING MIXTURE) - VARIABLE DEPTH, SEE CIVIL CROSS SECTIONS

PERENNIAL / GROUND COVER BED WITH 12" DEEP PLANTING SOIL

PROPOSED SODDING, SALT TOLERANT - WITH 4" DEPTH TOPSOIL

PROPOSED LANDSCAPING - WITH 12" DEPTH PLANTING SOIL SEE SHEET 133 FOR ENLARGEMENT PLAN

PREPARE PLANTING BED WITH PLANTING SOIL 12" DEEP AND 3" DEEP MULCH

X PLANT QUANTITY

X PLANT CODE

1

LANDSCAPE PLAN 6

1" = 20'-0"

LAYOUT	
DRAWN	
REVIEWED	

FILE NAME =	DESIGNED - BK	REVISED -
P1-sht-GRNE-land06.dgn	DRAWN - JR	REVISED -
PLOT DATE =	CHECKED - BM	REVISED -
3/23/2016 11:45:49 AM	DATE - MARCH 2016	REVISED -

STATE OF ILLINOIS DEPARTMENT OF TRANSPORTATION

LANDSCAPE PLAN - GREEN STREET
SCALE: 1"=20'
SHEET NO. 133 OF 236 SHEETS
STA. 1029+50.00 TO STA.

F.A.U. RTE.	SECTION		COUNTY	TOTAL SHEETS	SHEET NO.
	I5-00304-01-PV		CHAMPAIGN	236	133
MCORE PROJECT I			CONTRACT NO.91539		
JOB NO. C-95-305-16		ILLINOIS	FED. AID PROJECT TIG-518(057)		

LAYOUT	
DRAWN	
REVIEWED	

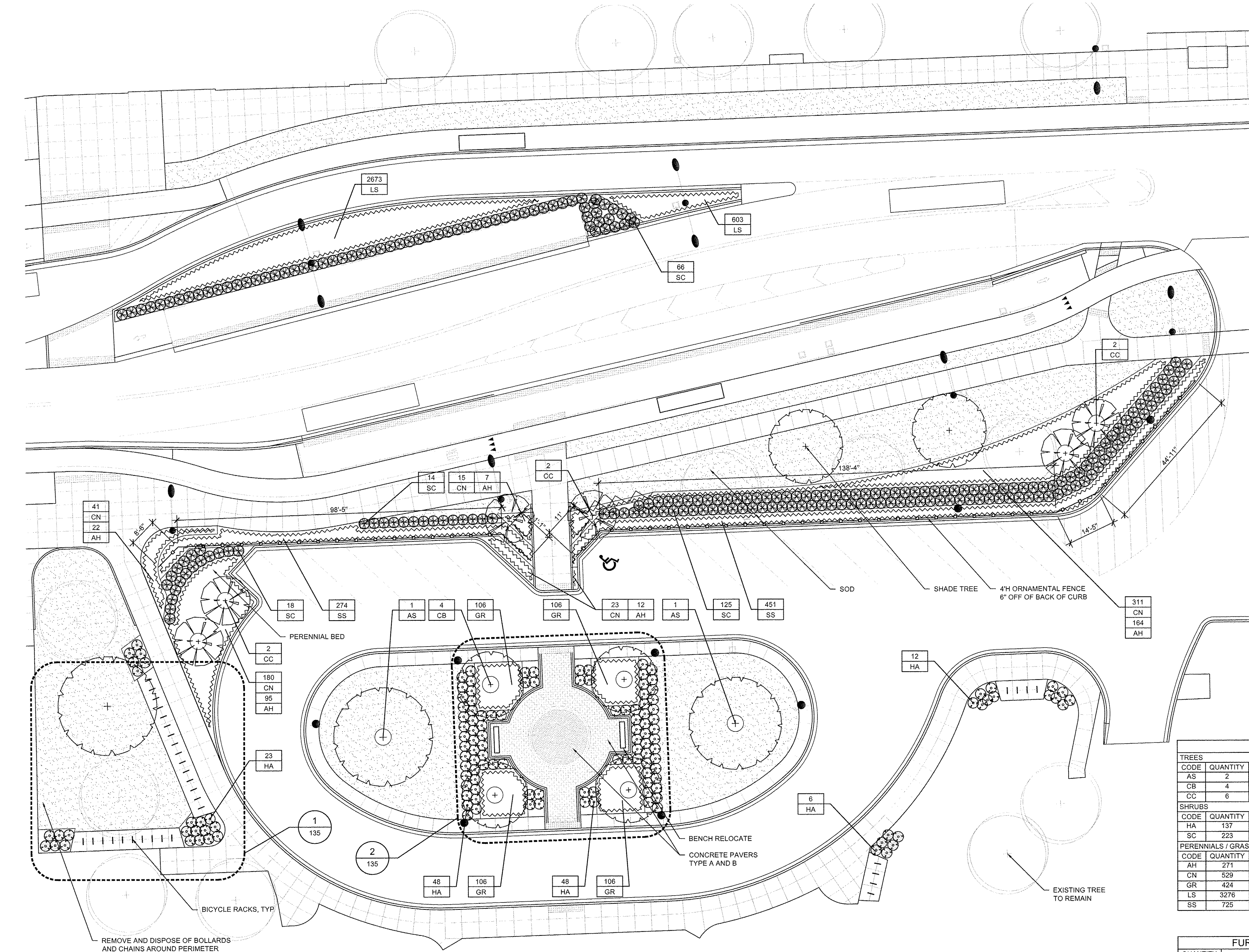

LEGEND:

- EXISTING TREE
- SHADE TREE WITH 24" DEEP SOIL - FOR TREES WITHIN SODDED AREAS PROVIDE A 20' DIAMETER OF TOPSOIL AT 24" DEEP
- ORNAMENTAL TREE WITH 12" DEEP PLANTING SOIL
- ORNAMENTAL SHRUBS WITH 12" DEEP PLANTING SOIL
- SOD WITH 4" DEEP TOPSOIL
- PERENNIAL BED WITH 12" DEEP PLANTING SOIL
- CONCRETE PAVERS TYPE A AND B, SEE ENLARGEMENT PLAN FOR LAYOUT
- 4"H ORNAMENTAL FENCE
- BICYCLE RACKS
- BENCH RELOCATE

LANDSCAPE NOTES:

- PLANT ALL MIXED PLANTING BEDS AS PER INTERPLANTED DETAIL ON SHEET 136.
- CONTRACTOR IS RESPONSIBLE FOR RETURNING TO PLANT FALL BULBS IF BULB PLANTING SEASON IS OVER AT TIME OF PROPOSED INSTALLATION, COORDINATE WITH AOR.
- FOR LANDSCAPE DETAILS, SEE SHEET 136
- ALL PLANTINGS SHALL FOLLOW IDOT BUREAU OF DESIGN & ENVIRONMENT MANUAL - CHAPTER 59 - LANDSCAPE DESIGN AND EROSION CONTROL 59-7.09 PLANTING IN URBANIZED AREA FOR SIGHT DISTANCES.
- ALL AREAS TO BE LANDSCAPED SHALL BE EXCAVATED TO THE DEPTH APPROPRIATE FOR THE PROPOSED PLANTINGS.
- CONTRACTOR SHALL PROVIDE PLANT MATERIALS SUFFICIENT TO COVER AREAS SHOWN ON PLANS AT THE SPACINGS INDICATED.
- ANY AREAS OUTSIDE OF THE LANDSCAPE BEDS THAT ARE DISTURBED SHALL BE REPLACED IN KIND.

FENCING NOTES:

- CONFIRM ALL FENCING QUANTITIES AND DIMENSIONS.
- FOR FENCING DETAILS, SEE SHEETS 135
- PROVIDE STAINLESS STEEL TAMPER PROOF FASTENERS.

PLANT SCHEDULE

TREES						
CODE	QUANTITY	PAY ITEM	BOTANICAL NAME	COMMON NAME	SIZE	REMARKS
AS	2	A2001722	Acer saccharum 'Ballista'	Fall Fiesta Sugar Maple	2.5" Cal	B&B matching heads
CB	4	XX006570	Carpinus betulus	Common Hornbeam	8" H	B&B matching heads
CC	6	B2001167	Cercis canadensis	Eastern Redbud	8" H	B&B matching heads
SHRUBS						
CODE	QUANTITY		BOTANICAL NAME	COMMON NAME	SIZE	REMARKS
HA	137	XX008639	Hydrangea arborescens	Smooth Hydrangea	#5	pot 36" o.c., per plan
SC	223	XX008639	Spiraea x cinerea 'Grefsheim'	Grefsheim Spiraea	#5	pot 36" o.c., per plan
PERENNIALS / GRASSES / GROUNDCOVERS						
CODE	QUANTITY		BOTANICAL NAME	COMMON NAME	SIZE	REMARKS
AH	271	K0012990	Amsonia hubrichtii	Threadleaf Bluestar	#1	pot 24" o.c.
CN	529	K0012990	Calamintha nepeta	Lesser Calamint	#1	pot 18" o.c.
GR	424	K0012990	Geranium 'Rozanne'	Rozanne Geranium	#1	pot 18" o.c.
LS	3276	K0013000	Liriope spicata	Lily Turf	2"	plug 8" o.c.
SS	725	K0012990	Schizachyrium scoparium	Little Bluestem	#1	pot 18" o.c.

FURNISHING SCHEDULE

QUANTITY	ITEM	REMARKS
33	Bike Rack	--

1 ILLINI UNION LANDSCAPE PLAN
1/16" = 1'-0"

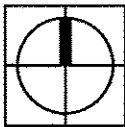

0 8 16 24 32'

FILE NAME = 7523_SITE.DWG
PLOT DATE = 3/22/16 5:57:03 PM

DESIGNED — BK
DRAWN — JR
CHECKED — BM
DATE — MARCH 2016

REVISED —
REVISED —
REVISED —
REVISED —

STATE OF ILLINOIS
DEPARTMENT OF TRANSPORTATION

ILLINI UNION
LANDSCAPE PLAN

SCALE: SHEET NO. 134 OF 236 SHEETS STA. TO STA.

F.A.U. RTE.	SECTION	COUNTY	TOTAL SHEETS	SHEET NO.
	15-00304-01-PV	CHAMPAIGN	236	134
MCORE PROJECT 1		CONTRACT NO.91539		
JOB NO. C-95-305-16		ILLINOIS	FED. AID PROJECT	

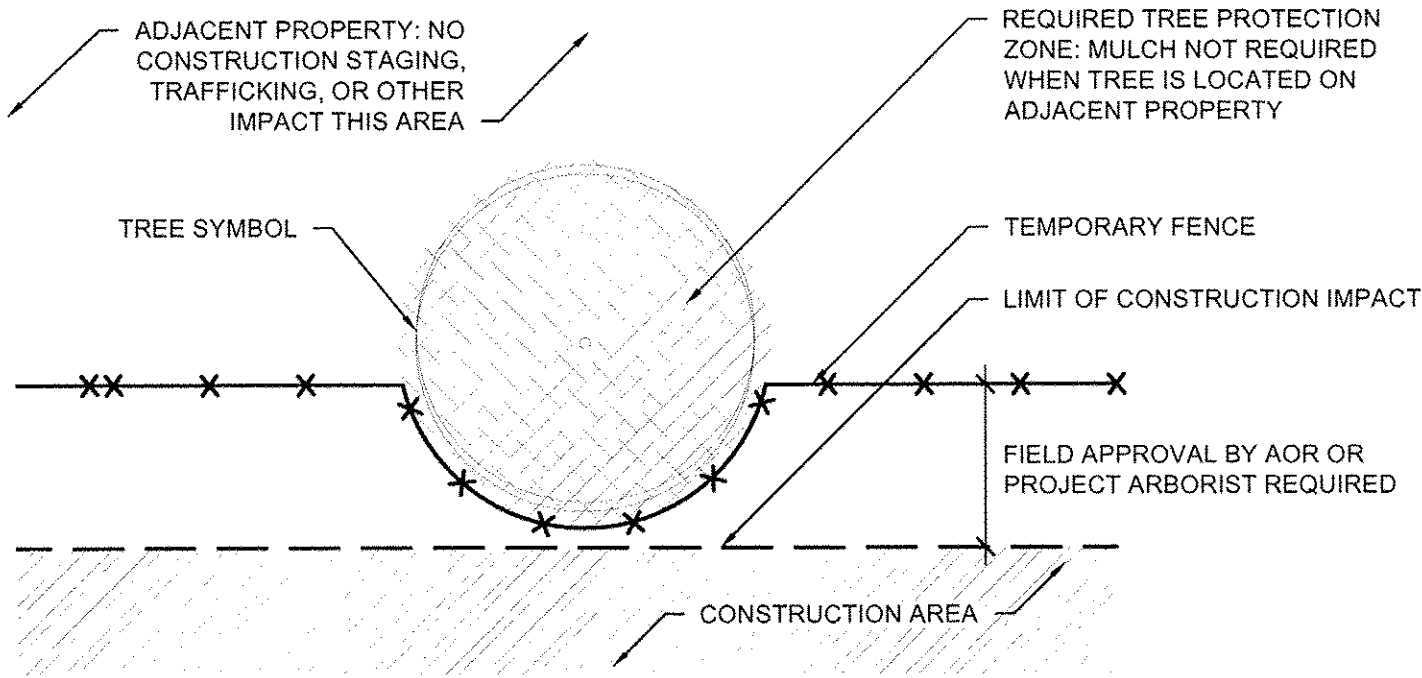

1A TEMPORARY FENCE INTERSECTS PROPERTY LIMIT;
NO ROOT PRUNING REQUIRED PLAN
NOT TO SCALE

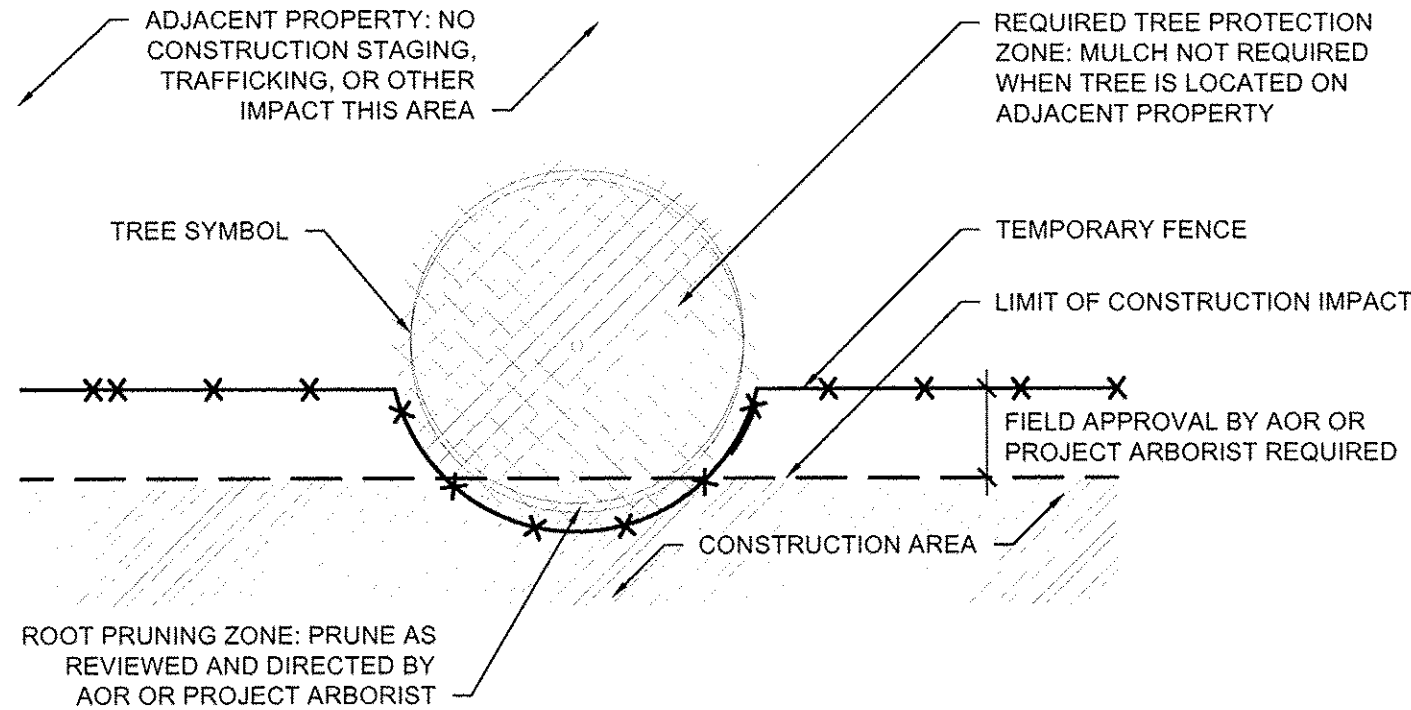

1B TEMPORARY FENCE INTERSECTS PROPERTY LIMIT;
ROOT PRUNING REQUIRED PLAN
NOT TO SCALE

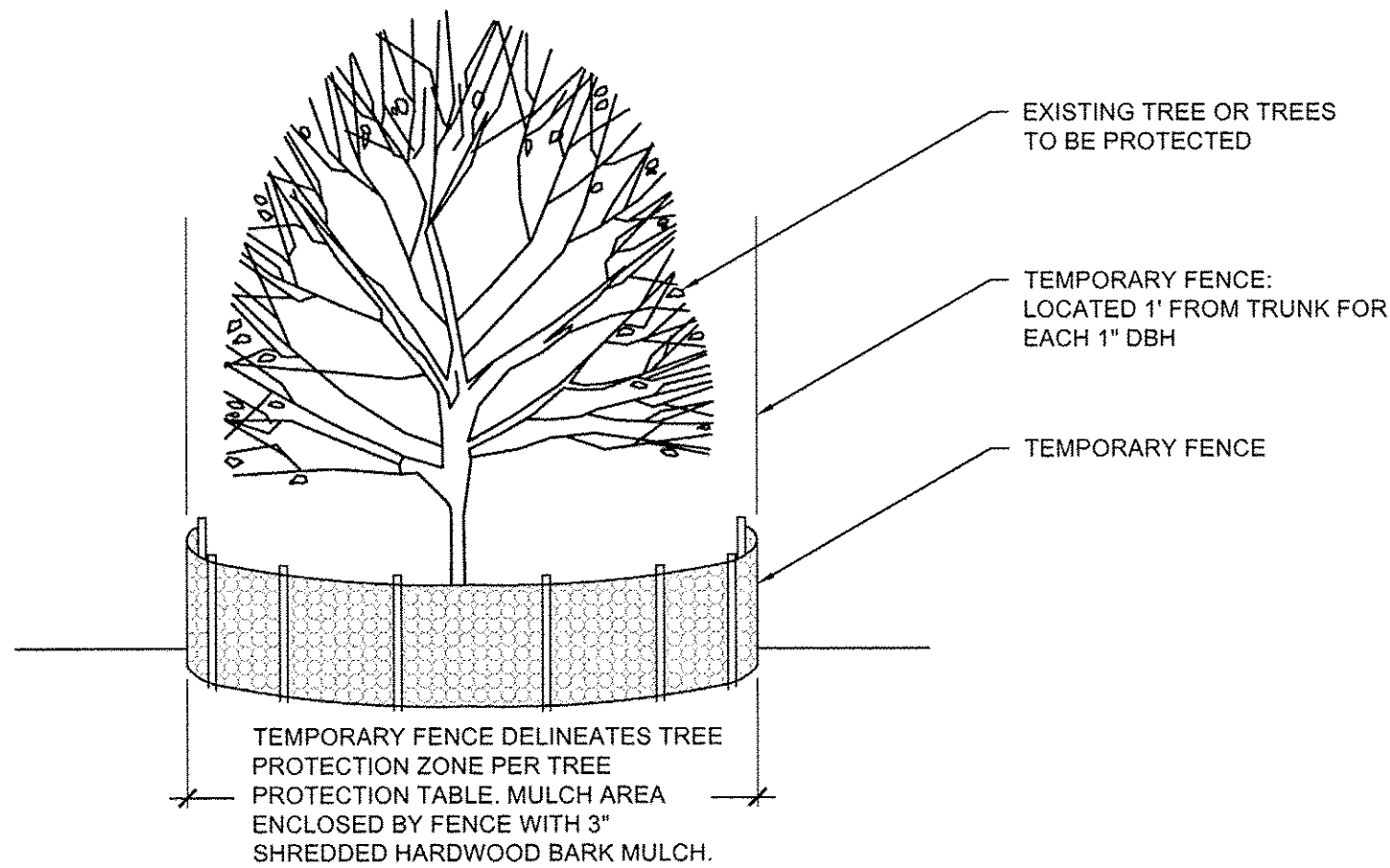

1C TEMPORARY FENCE INTERSECTS PROPERTY LIMIT;
NO ROOT PRUNING REQUIRED ELEVATION
NOT TO SCALE

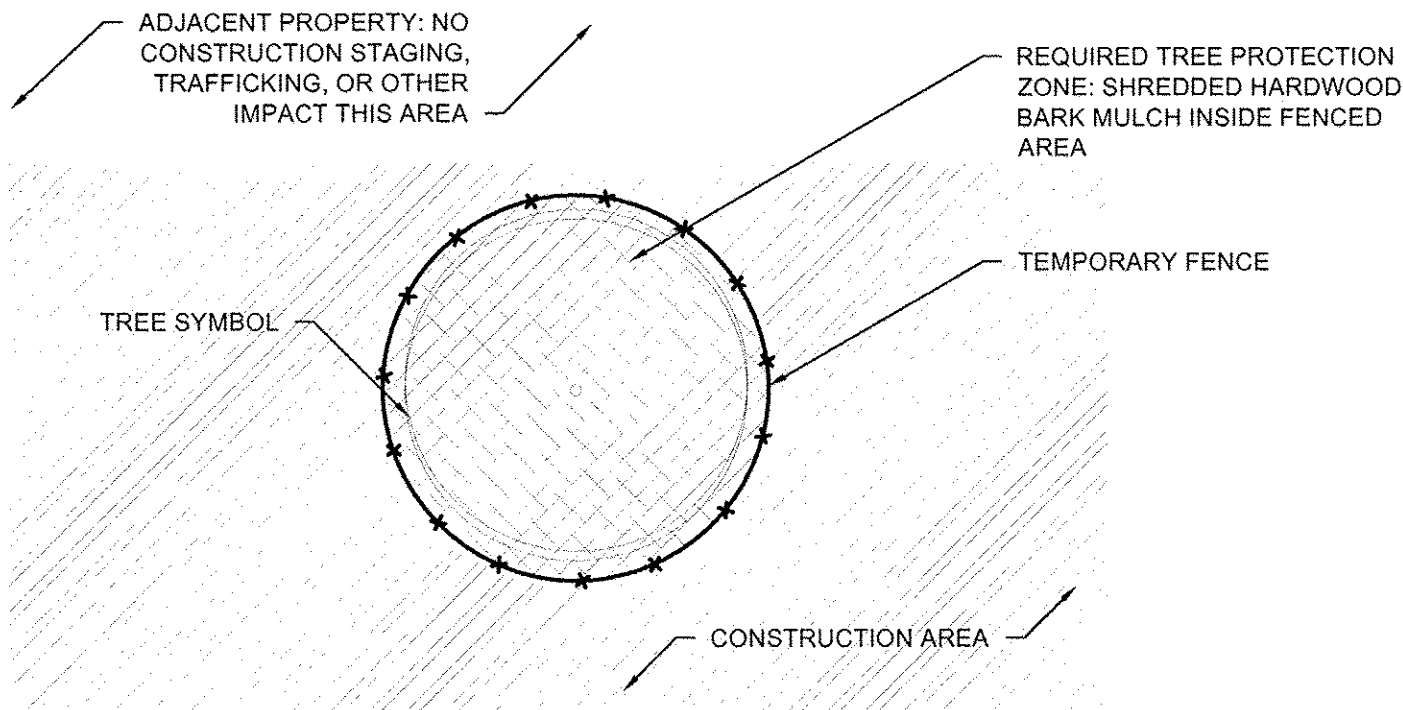

2A TREE PROTECTION ENTIRELY
WITHIN CONSTRUCTION AREA PLAN
NOT TO SCALE

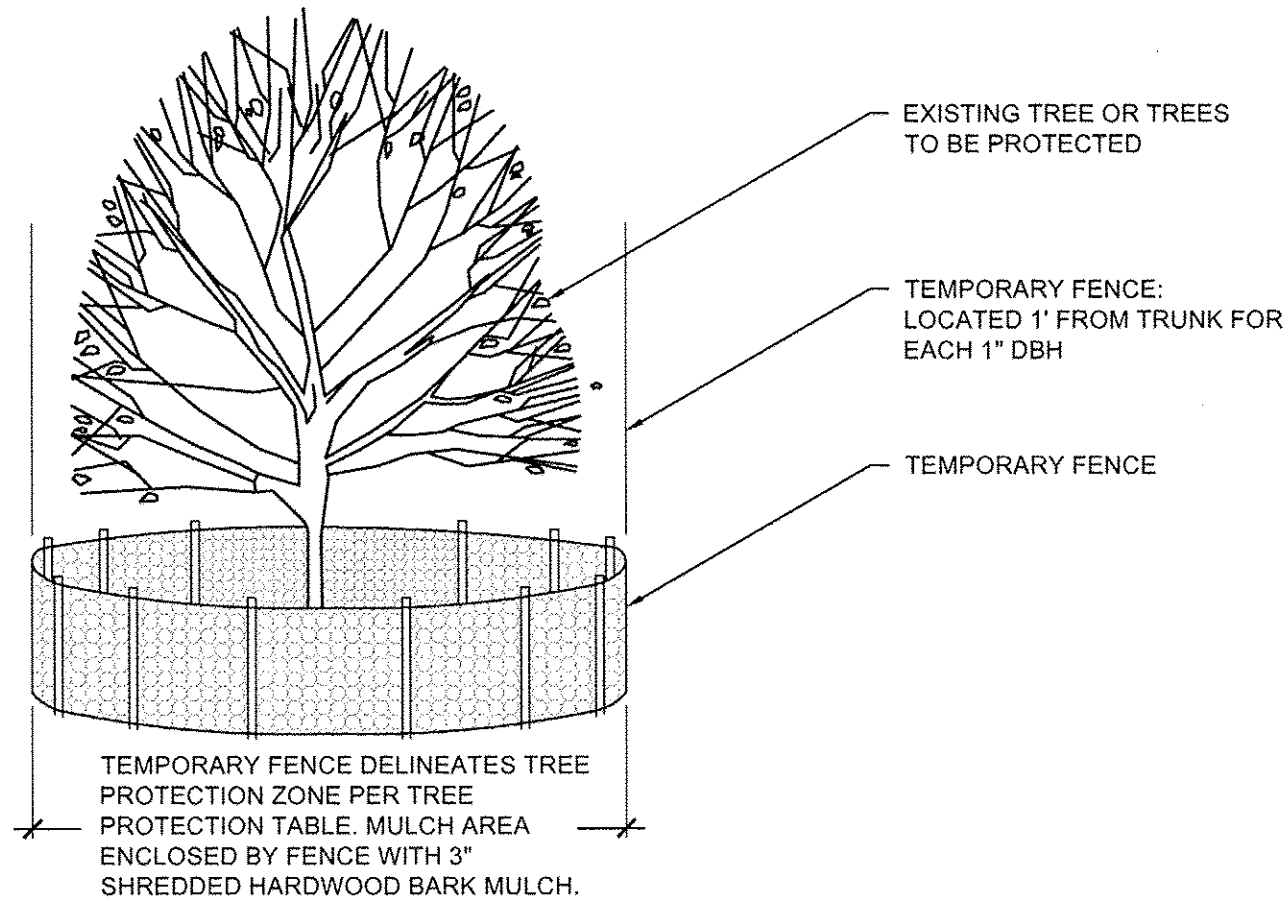

2B TREE PROTECTION ENTIRELY
WITHIN CONSTRUCTION AREA ELEVATION
NOT TO SCALE

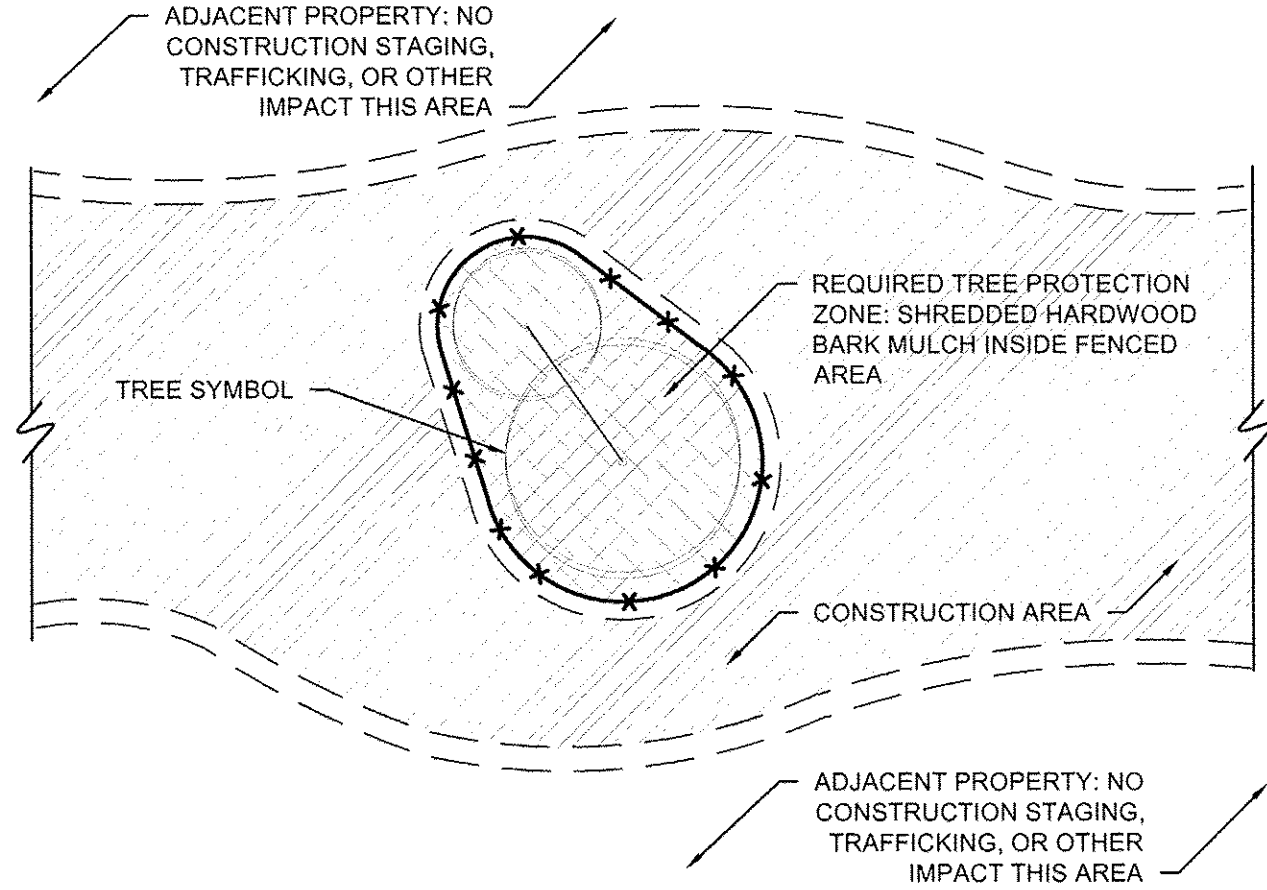

3A GROUP TREE PROTECTION
ENTIRELY WITHIN CONSTRUCTION AREA PLAN
NOT TO SCALE

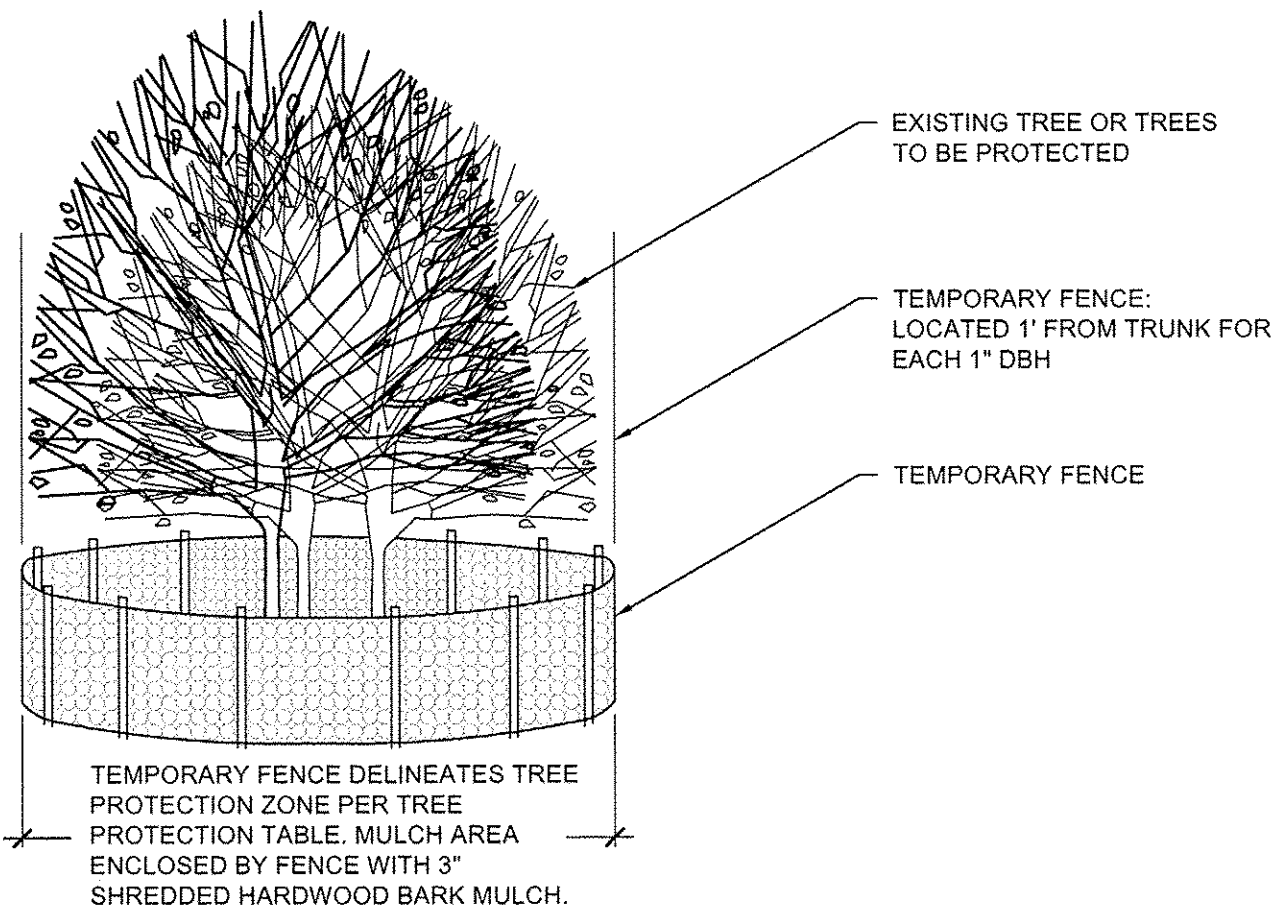

3B GROUP TREE PROTECTION
ENTIRELY WITHIN CONSTRUCTION AREA ELEVATION
NOT TO SCALE

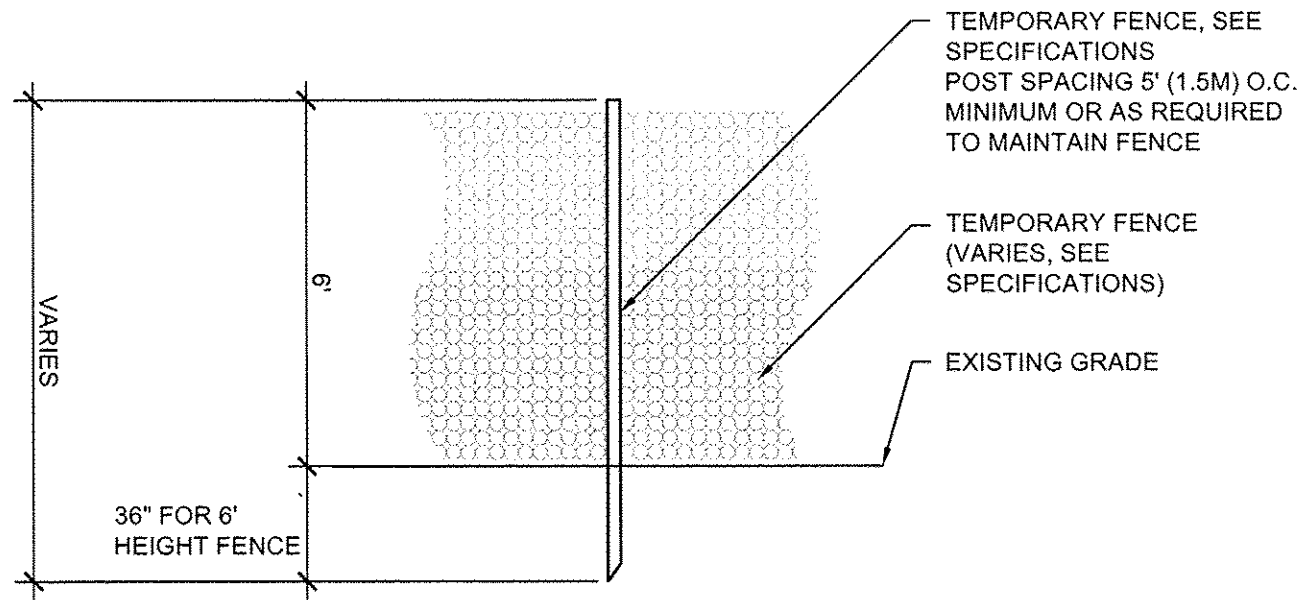

4 TEMPORARY FENCE
NOT TO SCALE

TREE PROTECTION	FLAG TAPE COLOR	RADIUS OF TREE CHAIN LINK PROTECTION FENCE FROM TRUNK	MULCH TREE PROTECTION ZONE
ADJACENT PROPERTY	NONE	NONE, TREE PROTECTED BY TEMPORARY FENCE AT PROJECT LIMITS	NO
TREE WITH TEMPORARY FENCE	GREEN	1'-5" RADIUS FOR EACH 1" (2.54 cm) DBH*, OR AS APPROVED BY ENGINEER OR PROJECT ARBORIST	YES, 3" DEPTH OF HARDWOOD BARK MULCH, NOT IN CONTACT WITH THE TRUNK
TREE WITH TEMPORARY FENCE, ROOTPRUNED	GREEN & YELLOW	1'-5" RADIUS FOR EACH 1" (2.54 cm) DBH*, OR AS APPROVED BY ENGINEER OR PROJECT ARBORIST	YES, 3" DEPTH OF HARDWOOD BARK MULCH, NOT IN CONTACT WITH THE TRUNK
TREE TO BE REMOVED	RED	NONE, TREES MUST BE REMOVED PRIOR TO START OF CONSTRUCTION	NO

*DBH - DIAMETER AT BREAST HEIGHT MEASURED AT 4.5' FROM BASE OF TREE.

5 TREE PROTECTION TABLE AND NOTES
NOT TO SCALE

TREE PROTECTION NOTES:

- THE PROTECTION OF TREES IS EXTREMELY IMPORTANT. TREE PROTECTION DEFICIENCIES ARE DETERMINED BY THE CERTIFIED ARBORIST AND MAY INCLUDE BUT ARE NOT LIMITED TO:
- 1. TREE PROTECTION NOT IN PLACE AT THE START OF CONSTRUCTION.
- 2. TEMPORARY FENCING DAMAGED OR DOWN.
- 3. CONTRACTOR VEHICLES OR EQUIPMENT OR PERSONAL VEHICLES DRIVING OR PARKING UNDER TREES
- 4. ANY ENCROACHMENT IN TEMPORARY FENCING
- 5. PLACEMENT OF ANY MATERIAL WITHIN THE TEMPORARY FENCING OR TREE DRIPLINES
- 6. DAMAGE TO ANY TREE
- 7. UNAUTHORIZED REMOVAL OF TREES
- 8. UNAUTHORIZED CHANGES IN GRADE
- THE CONTRACTOR MUST HAND DIG WHEN IN THE DRIPLINE OF PROTECTED TREES.
- IN THE EVENT THAT A TREE IS DAMAGED BY THE CONTRACTOR'S OPERATION OR PERSONNEL, THE CONTRACTOR SHALL BE RESPONSIBLE FOR REPAIR OR REMEDIATION OF THE DAMAGE AS DETERMINED BY THE CERTIFIED ARBORIST AND/OR UNIVERSITY OF ILLINOIS AND BUREAU OF FORESTRY. IN THE EVENT THAT THE DAMAGE TO THE TREE IS BEYOND REPAIR AND REQUIRES REMOVAL OR THE CONTRACTOR MISTAKENLY REMOVED THE TREE, THE TREE MUST BE REPLACED AT THE CONTRACTOR'S EXPENSE. AT A MINIMUM ANY TREE GREATER THAN 4" SHALL BE REPLACED WITH A NEW TREE AS IDENTIFIED BY THE UNIVERSITY AND/OR BUREAU OF FORESTRY AND SHALL HAVE A MINIMUM OF 4" CALIPER B&B. ANY DAMAGED TREE SMALLER THAN 4" CALIPER MEASURED 6" ABOVE GROUND SHALL BE REPLACED IN KIND, INCH FOR INCH.
- THE QUALITY OF THE REPLACEMENT TREE MUST BE EQUIVALENT TO THE STANDARDS OF THE BUREAU OF FORESTRY. THE COST OF THIS WORK WILL BE THE RESPONSIBILITY OF THE CONTRACTOR.

TEMPORARY FENCING SCHEDULE		
QUANTITY	ITEM	REMARKS
3,756 LF	Temporary Fence	Temporary Fence

LAYOUT	
DRAWN	
REVIEWED	

FILE NAME =
7523_TREEPROTECT.DWG
PLOT DATE =
3/22/16 5:57:03 PM

DESIGNED — BK
DRAWN — JR
CHECKED — BM
DATE — MARCH 2016

REVISED —
REVISED —
REVISED —
REVISED —

STATE OF ILLINOIS
DEPARTMENT OF TRANSPORTATION

TREE PROTECTION DETAILS

SCALE: SHEET NO. 135 OF 236 SHEETS STA. TO STA.

F.A.U. RTE.	SECTION	COUNTY	TOTAL SHEETS	SHEET NO.
	15-00304-01-PV	CHAMPAIGN	236	135
MCORE PROJECT 1		CONTRACT NO.91539		
JOB NO. C-95-305-16 ILLINOIS FED. AID PROJECT				



NOTE:
1. CORNER POSTS: 4" SQ.
2. INTERMEDIATE POSTS: 2-1/2" SQ.

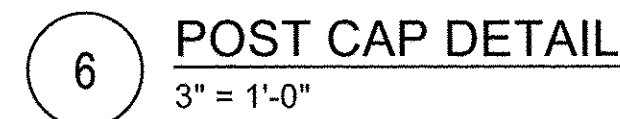

F.A.U. RTE.	SECTION	COUNTY	TOTAL SHEETS	SHEET NO.
	15-00304-01-PV	CHAMPAIGN	236	136
MCORE PROJECT 1		CONTRACT NO.91539		
JOB NO. C-95-305-16		ILLINOIS	FED. AID PROJECT	

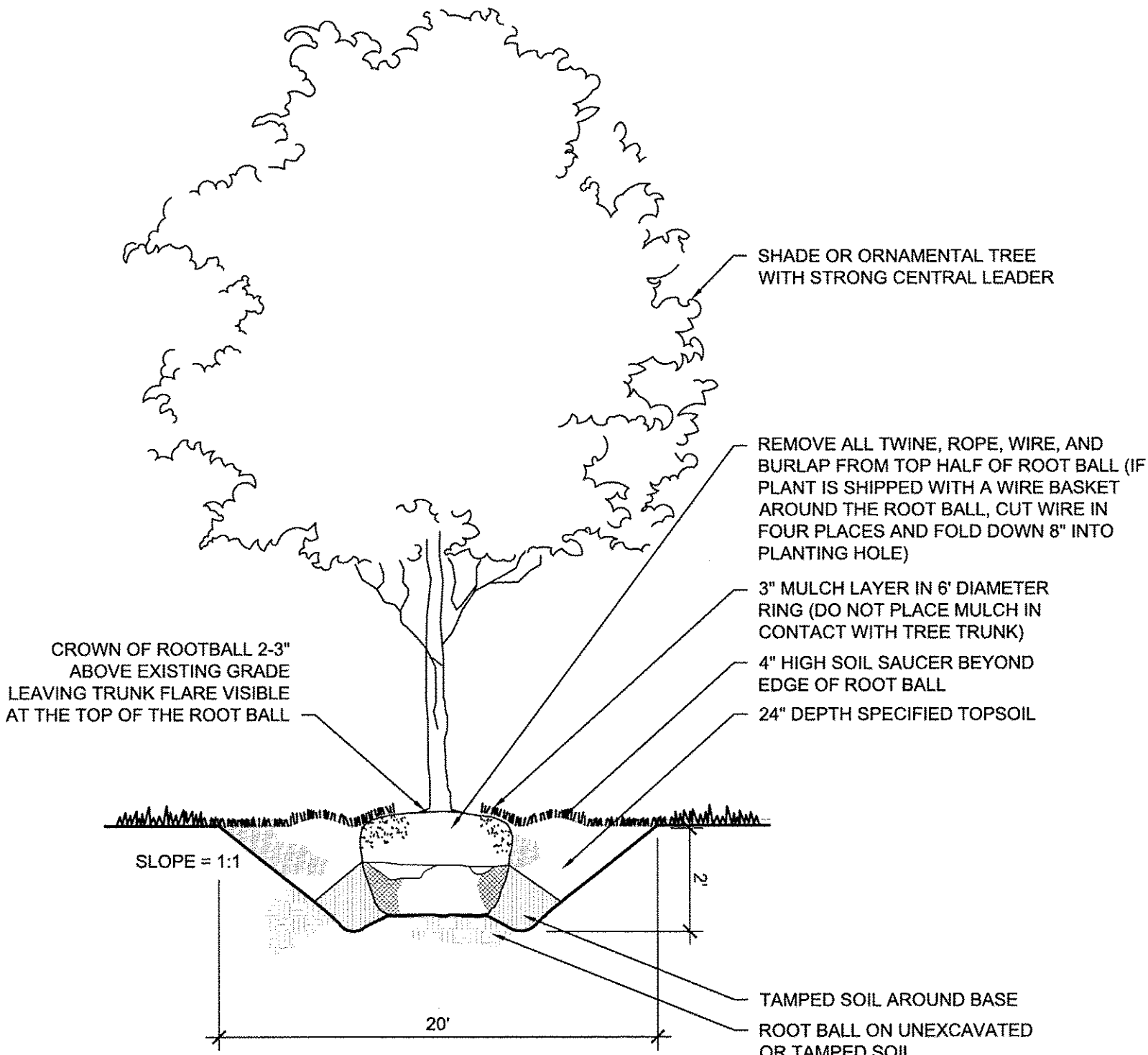

1 SHADE TREE PLANTING SECTION
NOT TO SCALE

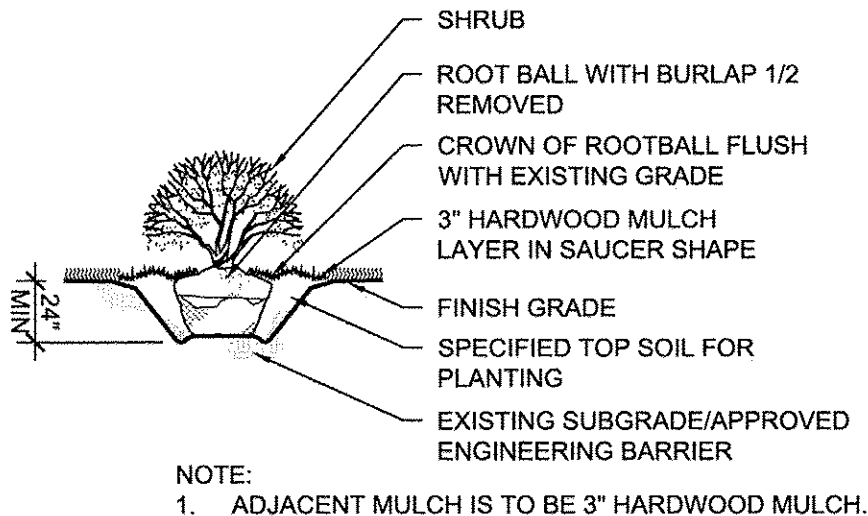

2 SHRUB PLANTING SECTION
NOT TO SCALE

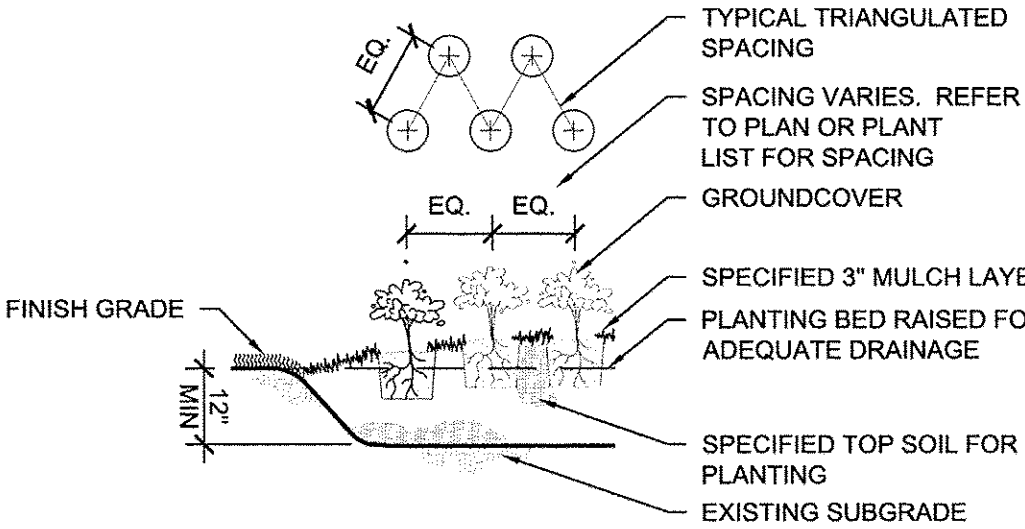

3 PERENNIAL PLANTING SECTION
NOT TO SCALE

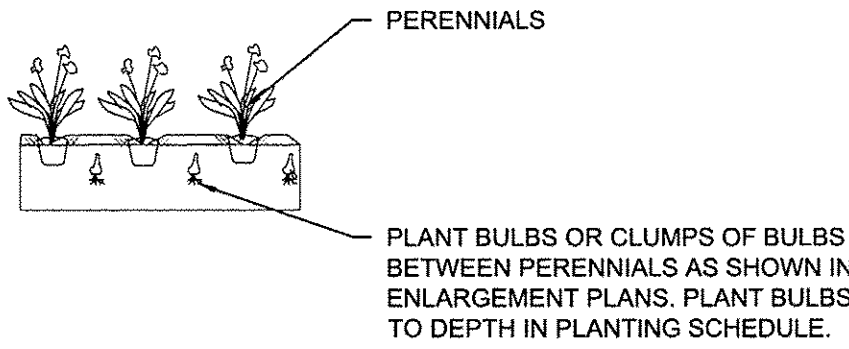

4 BULB INSTALLATION DETAIL
NOT TO SCALE

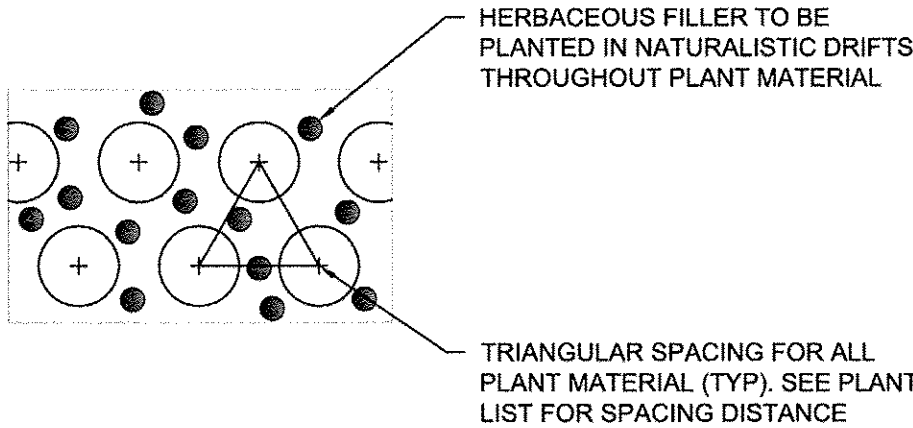

5 INTERPLANTING DETAIL
NOT TO SCALE

GENERAL PLANTING NOTES

1. DETERMINE EXACT LOCATIONS OF ALL UNDERGROUND UTILITIES AND VERIFY IN FIELD. REPORT ANY CONFLICTS TO ENGINEER PRIOR TO BEGINNING WORK.
2. INFORM ENGINEER AS EACH PHASE OF WORK IS UNDERTAKEN.
3. PROTECT EXISTING VEGETATION INCLUDING ALL EXISTING PARKWAY AND INTERIOR TREES. REPLACE DAMAGED VEGETATION WITH APPROVED SIMILAR MATERIAL.
4. MAINTAIN SITE DRAINAGE DURING LANDSCAPE INSTALLATION.
5. SLOPE ALL PLANTING AREAS AWAY FROM BUILDING AT 2% MINIMUM GRADE UNLESS NOTED OTHERWISE.
6. PRIOR TO LANDSCAPE INSTALLATION, VERIFY PLANTING AREAS ARE GRADED AT +/- 0.1 FOOT TO FINISH GRADE.
7. IN LANDSCAPE AREAS, FINISH GRADE TO 4" MINIMUM BELOW ADJACENT BUILDING FINISH FLOOR ELEVATION UNLESS NOTED OTHERWISE.
8. FINISH GRADE TO 1" BELOW FINISH PAVING SURFACE IN LAWN AREAS AND 2" BELOW IN PLANTING AREAS.
9. CONFIRM ALL PLANT QUANTITIES. PROVIDE PLANT MATERIALS SUFFICIENT TO COVER AREAS SHOWN ON PLANS AT THE SPACINGS INDICATED.
10. PROVIDE SINGLE TRUNK STANDARD TREES UNLESS NOTED OTHERWISE.
11. PROVIDE IDENTIFICATION TAG FROM THE SUPPLYING NURSERY SHOWING COMMON AND BOTANICAL PLANT NAMES FOR AT LEAST ONE PLANT OF EACH SPECIES DELIVERED TO THE SITE. PROTECT ALL PLANTS AGAINST HEAT, SUN, WIND AND FROST DURING TRANSPORTATION TO THE SITE AND WHILE BEING HELD AT THE SITE. DO NOT STORE PLANTS IN TOTAL DARKNESS MORE THAN ONE DAY.
12. DO NOT DAMAGE PLANT ROOT BALL DURING TRANSPORTATION OR PLANTING.
13. NOTIFY THE ENGINEER AT THE TIME OF DELIVERY OF ANY PLANT MATERIAL THAT IS DAMAGED OR IN POOR CONDITION.
14. ENGINEER RESERVES THE RIGHT TO INSPECT ALL PLANT MATERIALS BEFORE PLANTING. MATERIAL MAY BE REJECTED AT ANY TIME DUE TO CONDITION, FORM OR DAMAGE BEFORE OR AFTER PLANTING.
15. REMOVE ALL ROCK AND DEBRIS 1" AND LARGER FROM PLANTING AREAS. LEGALLY DISPOSE ALL EXCESS MATERIALS RESULTING FROM THE WORK.
16. IN PLANTING SOIL PIT, REMOVE CRUSHED AGGREGATE TO AN ADEQUATE DEPTH TO ENSURE THAT NO PART OF THE PLANT MATERIAL IS IN CONTACT OR AFFECTED BY THE LIME OR LIMESTONE IN THE AGGREGATE
17. PROVIDE NEW TOPSOIL THAT IS FERTILE, FRIABLE AND NATURAL LOAM SURFACE SOIL, REASONABLY FREE OF SUBSOIL, CLAY, CLAY LUMPS, BRUSH, WEEDS, AND OTHER LITTER AND FREE OF ROOTS, STUMPS, STONES LARGER THAN 2" IN ANY DIMENSION AND OTHER EXTRANEIOUS OR TOXIC MATTER HARMFUL TO PLANT GROWTH. OBTAIN TOPSOIL FROM LOCAL SOURCES OR FROM AREAS HAVING SIMILAR SOIL CHARACTERISTICS TO THAT NECESSARY FOR VIGOROUS GROWTH OF SPECIFIED PLANTINGS. OBTAIN TOPSOIL THAT OCCURS IN A DEPTH OF NOT LESS THAN 6". DO NOT OBTAIN SOIL FROM BOGS OR MARSHES.
18. MIX SOIL AMENDMENTS AND FERTILIZERS WITH TOPSOIL ON A SITE SPECIFIC BASIS AT RATES APPROPRIATE FOR PLANTINGS IN ACCORDANCE WITH IDOT'S STANDARD SPECIFICATIONS.
19. STAKE LOCATION OF ALL TREES, HEDGE LINES AND PLANTING BEDS AND NOTIFY ENGINEER FOR REVIEW PRIOR TO PLANTING.
20. THE PLANTING PLANS ARE DIAGRAMMATIC. SPOT PLANT MATERIALS APPROXIMATELY AS SHOWN ON THE LANDSCAPE DRAWING AND NOTIFY ENGINEER FOR REVIEW BEFORE REMOVING FROM CONTAINERS.
21. INSTALL ALL PLANT MATERIAL IN ACCORDANCE WITH DETAILS AND SPECIFICATIONS.
22. REMOVE ALL PLANT TYING MATERIAL AND MARKING TAPES AT THE TIME OF PLANTING.
23. INSTALL A MIN 3" LAYER OF HARDWOOD BARK MULCH AROUND ALL TREES AND IN ALL PLANTING AREAS UNLESS NOTED OTHERWISE. CREATE A NATURAL SPADED EDGE WHERE PLANTING BEDS MEET TURF AREAS.
24. WATER ALL PLANTS IMMEDIATELY AFTER PLANTING. FLOOD PLANTS TWICE DURING FIRST TWENTY-FOUR HOUR PERIOD OF PLANTING.
25. GUY AND STAKE TREES, AS DIRECTED BY ENGINEER, IMMEDIATELY AFTER PLANTING. PROVIDE A MINIMUM OF TWO GUY WIRES PER TREE ON THE UPHILL SIDE OF TREES PLANTED ON SLOPES STEEPER THAN 3:1.
26. PRUNE ALL DECIDUOUS SHADE TREES FOR A MINIMUM LOWEST BRANCH HEIGHT OF 7 FEET.
27. INSTALL AND MAINTAIN SOD TO PREVENT EVIDENT SEAMS.
28. WARRANTY ALL PLANTS AND LAWN EXPERIENCING DEATH AND DEFECTS INCLUDING UNSATISFACTORY GROWTH, EXCEPT FOR DEFECTS RESULTING FROM NEGLIGENCE BY OWNER, ABUSE OR DAMAGE BY OTHERS OR UNUSUAL PHENOMENON OR INCIDENTS WHICH ARE BEYOND CONTRACTOR'S CONTROL.

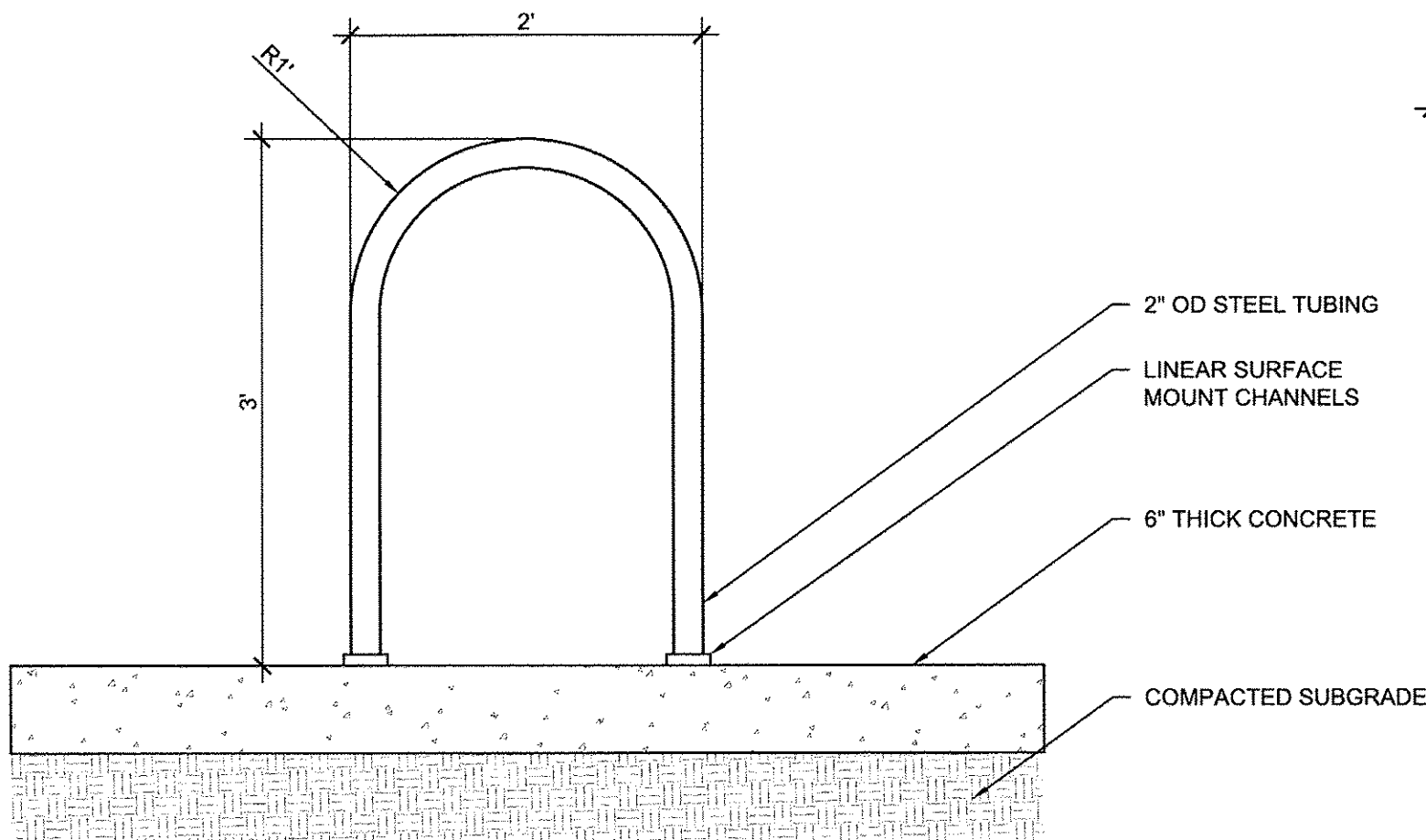

6 BIKE RACK DETAIL
1" = 1'-0"

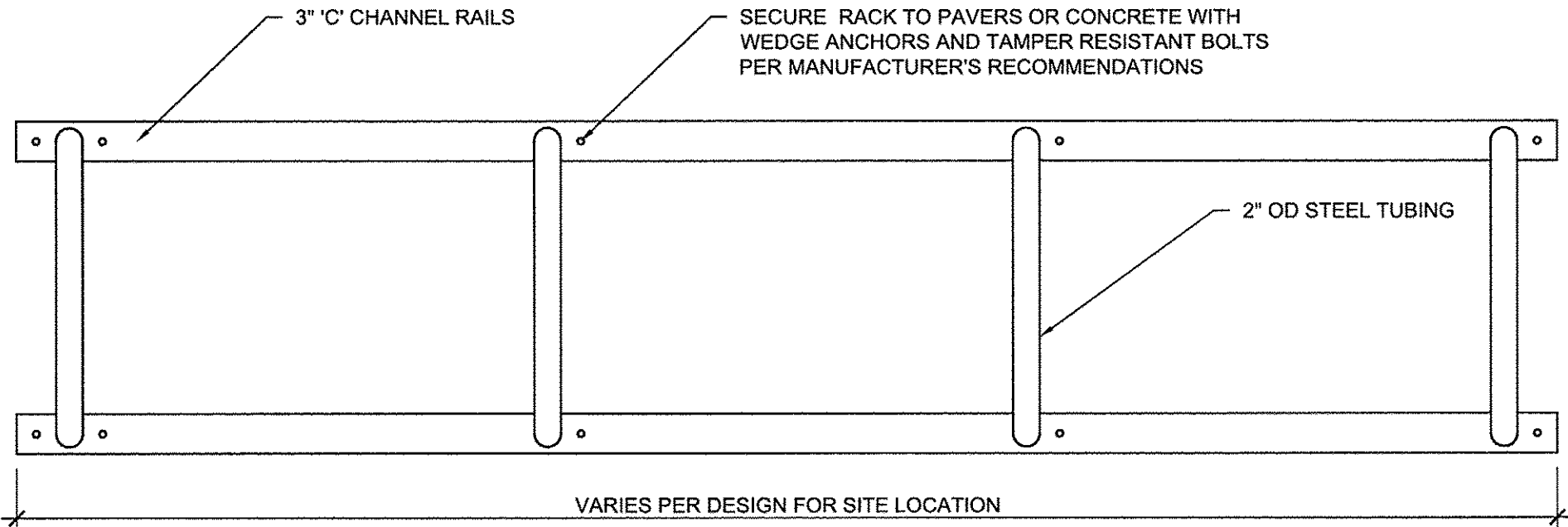

PLAN

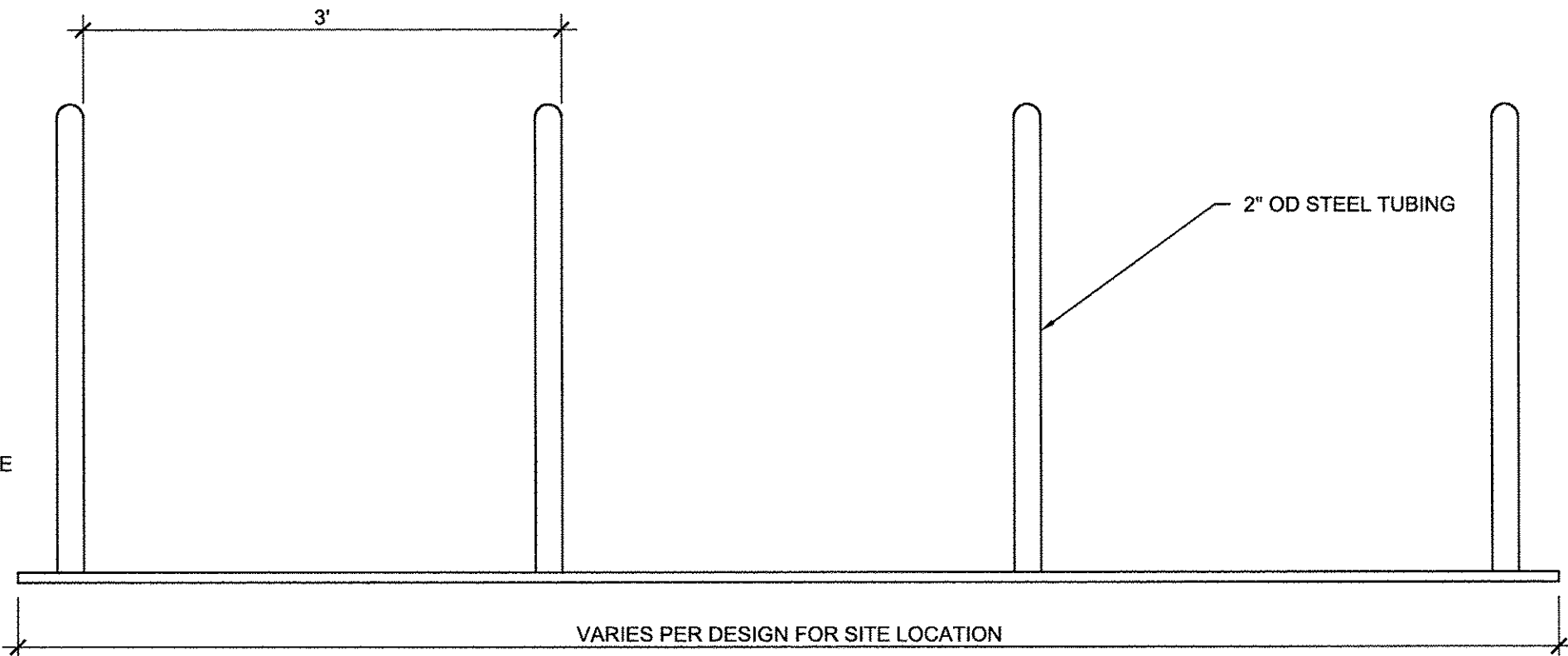

ELEVATION

LAYOUT	
DRAWN	
REVIEWED	

FILE NAME = 7523_LANDDTLS.DWG	DESIGNED — BK	REVISED —	STATE OF ILLINOIS DEPARTMENT OF TRANSPORTATION	ILLINI UNION LANDSCAPE PLAN		F.A.U. R.T.E.	SECTION	COUNTY	TOTAL SHEETS	SHEET NO.
PLOT DATE = 3/22/16 5:57:03 PM	DRAWN — JR	REVISED —					15-00304-01-PV	CHAMPAIGN	236	137
	CHECKED — BM	REVISED —				MCORE PROJECT 1		CONTRACT NO.91539		
	DATE — MARCH 2016	REVISED —				JOB NO. C-95-305-16	ILLINOIS	FED. AID PROJECT		
SCALE:		SHEET NO. 137 OF 236 SHEETS		STA. TO STA.						