

**LEGEND**

- SIDEWALK/BIKEWAY REMOVAL
- PAVEMENT REMOVAL
- DRIVEWAY PAVEMENT REMOVAL
- CONCRETE CURB AND GUTTER REMOVAL

**NOTES**

SEE SCHEDULES FOR ITEMS TO BE ADJUSTED OR REMOVED.

ALL ROW DIMENSIONS ARE APPROX. AND SHOULD BE CONFIRMED IN THE FIELD.

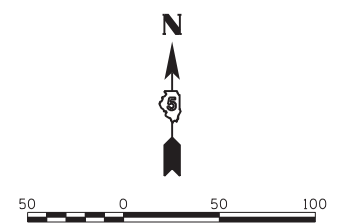
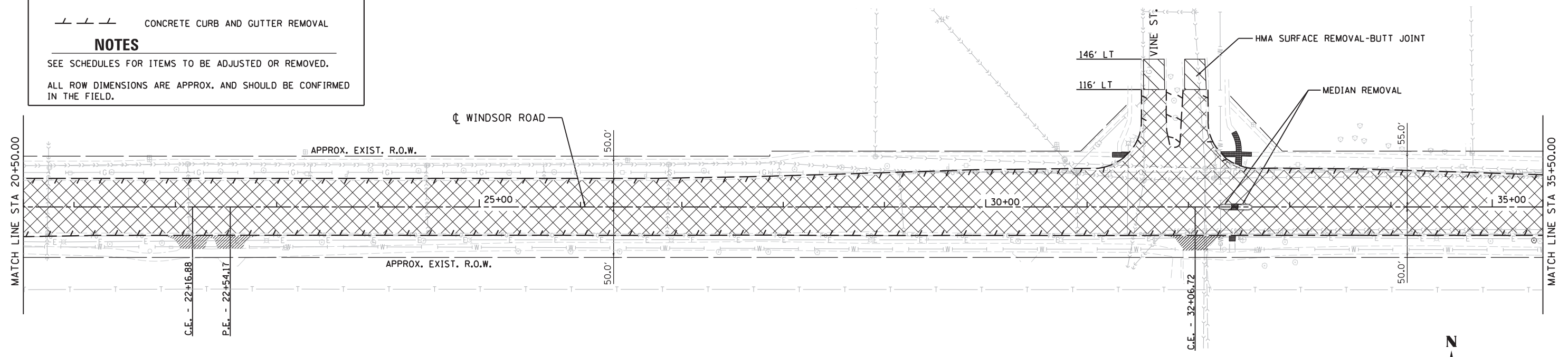

DESIGNED	DJP	4/29/14
DRAWN	DJP	4/29/14
REVIEWED	MH	4/29/14

FILE NAME = D513L0201-sht-rem-01.dgn	USER NAME = johns00944	DESIGNED - DJP	REVISED -
MODEL NAME =	PLOT SCALE = 100.0000' / in.	DRAWN - DJP	REVISED -
Sheet 1	PLOT DATE = 06/12/2014	CHECKED - MH	REVISED -
PENTABLE NAME = ...C:\ProgramData\Bentley\MicroStation V8i (SELECTseries)\Workspace\prBj06t0RPV6R\NAME.tbl...Plot\DDOT.pdf_600dpi.pltcf		DATE - 05-03-2014	REVISED -

**STATE OF ILLINOIS  
DEPARTMENT OF TRANSPORTATION**

**REMOVAL SHEETS - (WINDSOR RD.)  
WINDSOR ROAD**

SCALE: 1" = 50' SHEET 1 OF 2 SHEETS STA. TO STA.

F.A. RTE.	SECTION	COUNTY	TOTAL SHEETS	SHEET NO.
7145	13-00540-00-PV	CHAMPAIGN	80	19
	13L0201			CONTRACT NO. 91515

ILLINOIS FED. AID PROJECT

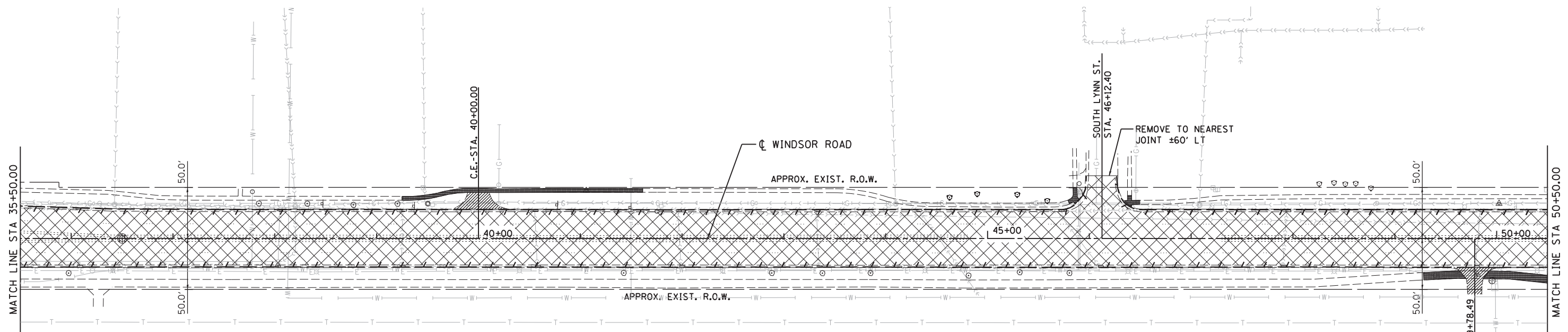

**LEGEND**

- SIDEWALK/BIKEWAY REMOVAL
- PAVEMENT REMOVAL
- DRIVEWAY PAVEMENT REMOVAL
- CONCRETE CURB AND GUTTER REMOVAL

**NOTES**

SEE SCHEDULES FOR ITEMS TO BE ADJUSTED OR REMOVED.

ALL ROW DIMENSIONS ARE APPROX. AND SHOULD BE CONFIRMED IN THE FIELD.

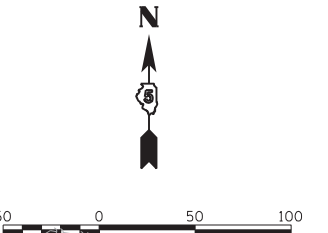
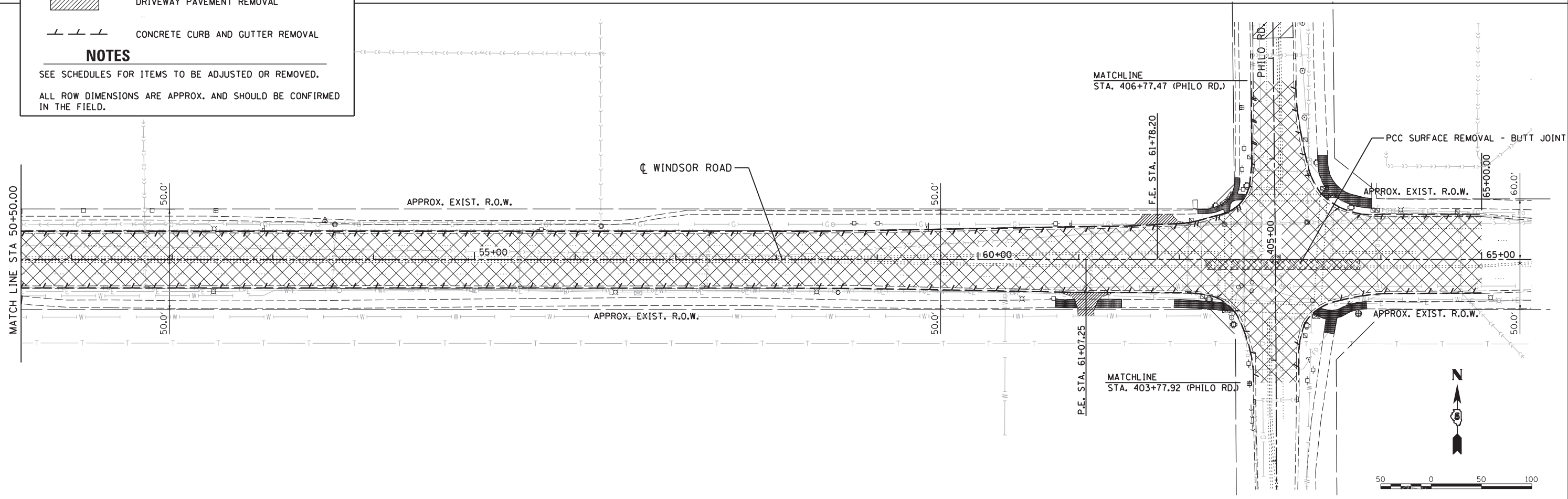
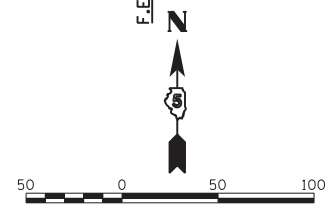

DESIGNED	DJP	4/29/14
DRAWN	DJP	4/29/14
REVIEWED	MH	4/29/14

FILE NAME =	USER NAME = johns00944	DESIGNED -	DJP	REVISED -	
D513L0201-shr-rem-02.dgn		DRAWN -	DJP	REVISED -	
MODEL NAME =	PLOT SCALE = 100.0000' / in.	CHECKED -	MH	REVISED -	
Sheet 2	PLOT DATE = 06/12/2014	DATE -	05-03-2014	REVISED -	
PENTABLE NAME = ...C:\ProgramData\Bentley\MicroStation V8i (SELECTseries)\Workspace\prBj06t0RPV6R\NAME.tbl...Plot\DDOT.pdf_600dpi.pltcf					

**STATE OF ILLINOIS  
DEPARTMENT OF TRANSPORTATION**

**REMOVAL SHEETS - (WINDSOR RD.)  
WINDSOR ROAD**

SCALE: 1" = 50'    SHEET 2 OF 2 SHEETS    STA.                      TO STA.

F.A. RTE.	SECTION	COUNTY	TOTAL SHEETS	SHEET NO.
7145	13-00540-00-PV	CHAMPAIGN	80	20
	13L0201	CONTRACT NO.	91515	
ILLINOIS FED. AID PROJECT				

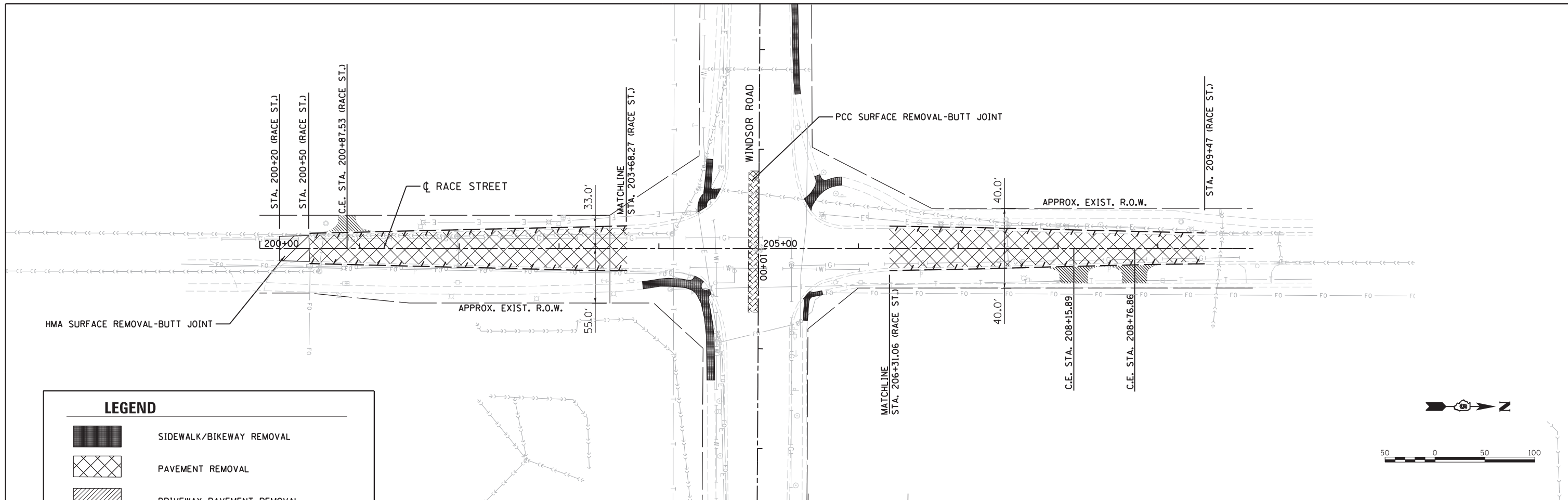

**LEGEND**

- SIDEWALK/BIKEWAY REMOVAL
- PAVEMENT REMOVAL
- DRIVEWAY PAVEMENT REMOVAL
- CONCRETE CURB AND GUTTER REMOVAL

**NOTES**

SEE SCHEDULES FOR ITEMS TO BE ADJUSTED OR REMOVED.

ALL ROW DIMENSIONS ARE APPROX. AND SHOULD BE CONFIRMED IN THE FIELD.

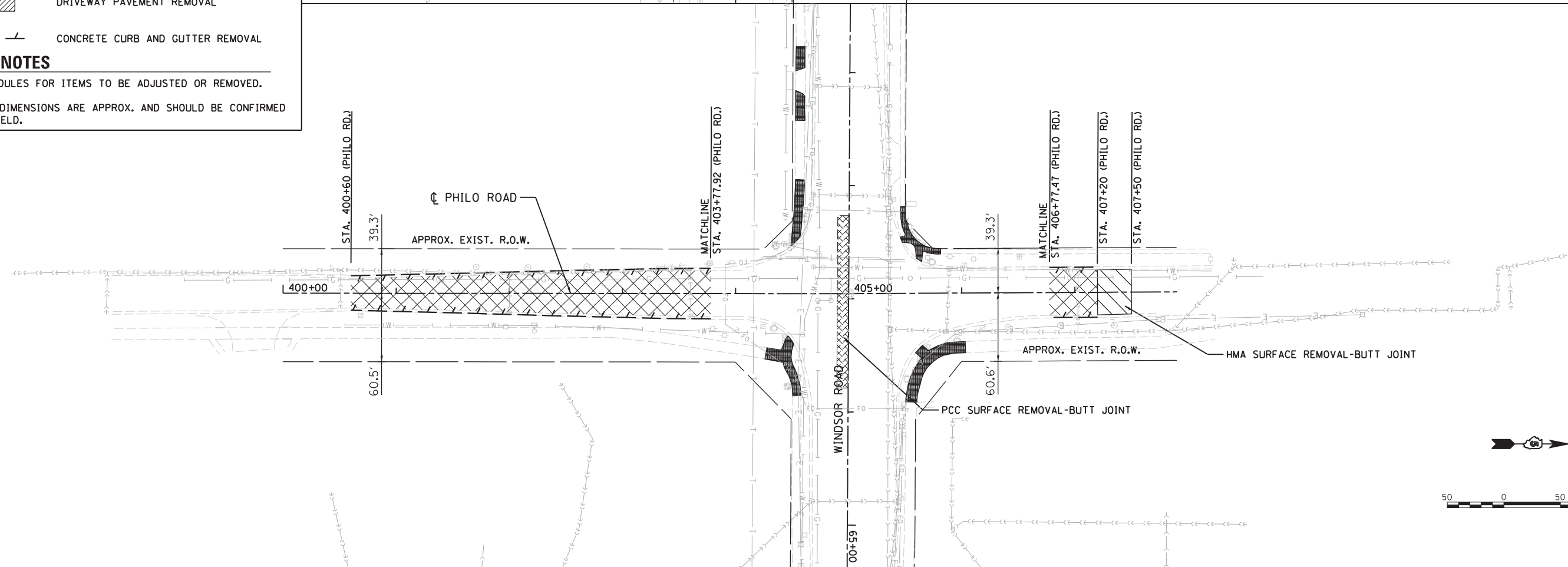

DESIGNED	DJP	4/29/14
DRAWN	DJP	4/29/14
REVIEWED	MH	4/29/14

FILE NAME =	USER NAME = johns00944	DESIGNED -	DJP	REVISED -	
D513L0201-sht-rem-03.dgn		DRAWN -	DJP	REVISED -	
MODEL NAME =		CHECKED -	MH	REVISED -	
Sheet 3		DATE -	05-03-2014	REVISED -	
PLOT DATE = 06/12/2014		PENTABLE NAME = ...\\C:\ProgramData\Bentley\MicroStation V8i (SELECTseries)\Workspace\prBj06t0P9V6R\NAME.tbl...\\Plot\IDOT.pdf_600dpi.pltcf9			

**STATE OF ILLINOIS  
DEPARTMENT OF TRANSPORTATION**

**REMOVAL SHEETS - (RACE ST./PHILO RD.)  
WINDSOR ROAD**

SCALE: 1" = 50'    SHEET 1 OF 1 SHEETS    STA.    TO STA.

F.A. RTE.	SECTION	COUNTY	TOTAL SHEETS	SHEET NO.
7145	13-00540-00-PV	CHAMPAIGN	80	21
13L0201		CONTRACT NO.	91515	
ILLINOIS FED. AID PROJECT				