

**CITY OF URBANA
PUBLIC WORKS DEPARTMENT**

WINDSOR ROAD RESURFACING	TOTAL SHEETS	SHEET NO.
	70	1
SECTION 21-00637-00-RS		

INDEX OF SHEETS

- 1 COVER SHEET
- 2 GENERAL NOTES
- 3 SUMMARY OF QUANTITIES
- 4 TYPICAL SECTIONS
- 5 SCHEDULE OF QUANTITIES
- 6-10 PLAN SHEETS
- 11-15 PAVEMENT MARKING SHEETS
- 16-17 SIGNAL SHEETS
- 18-20 CITY OF URBANA DETAILS

PROPOSED HIGHWAY PLANS

**FAU ROUTE 7145 (WINDSOR ROAD)
SECTION 21-00637-00-RS
STATE MFT FUNDS
RESURFACING
CHAMPAIGN COUNTY
FUHRMANN JOB NO. 22-1924**

IDOT HIGHWAY STANDARDS

000001-08	STANDARD SYMBOLS, ABBREVIATIONS AND PATTERNS
001006	DECIMAL OF AN INCH AND OF A FOOT
482011-03	HMA SHOULDER STRIPS/SHOULDERS WITH RESURFACING OR WIDENING AND RESURFACING PROJECTS
642001-03	SHOULDER RUMBLE STRIPS, 16 IN.
701101-05	OFF-ROAD OPERATIONS, MULTILANE, 15' (4.5 M) TO 24" (600 MM) FROM PAVEMENT EDGE
701421-08	LANE CLOSURE, MULTILANE, DAY OPERATIONS ONLY, FOR SPEEDS > 45 MPH TO 55 MPH
701422-10	LANE CLOSURE, MULTILANE, FOR SPEEDS > 45 MPH TO 55 MPH
701426-09	LANE CLOSURE, MULTILANE, INTERMITTENT OR MOVING OPERATION, FOR SPEEDS > 45 MPH
701606-10	URBAN SINGLE LANE CLOSURE, MULTILANE, 2W WITH MOUNTABLE MEDIAN
701611-01	URBAN HALF ROAD CLOSURE, MULTILANE, 2W WITH MOUNTABLE MEDIAN
701701-10	URBAN LANE CLOSURE, MULTILANE INTERSECTION
701901-08	TRAFFIC CONTROL DEVICES
780001-05	TYPICAL PAVEMENT MARKINGS
781001-04	TYPICAL APPLICATIONS RAISED REFLECTIVE PAVEMENT MARKERS
886001-01	DETECTOR LOOP INSTALLATIONS
886006-01	TYPICAL LAYOUTS FOR DETECTION LOOPS

DESIGN DESIGNATION

MINOR ARTERIAL
15600 ADT FROM PROJECT BEGINNING TO LINCOLN AVE
11500 ADT FROM LINCOLN AVE TO PROJECT END

**FOR SUMMARY OF QUANTITIES
SEE SHEET 3**

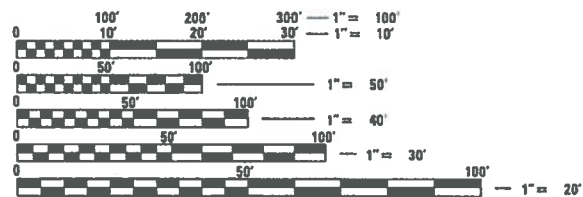

FULL SIZE PLANS HAVE BEEN PREPARED USING STANDARD ENGINEERING SCALES. REDUCED SIZED PLANS WILL NOT CONFORM TO STANDARD SCALES. IN MAKING MEASUREMENTS ON REDUCED PLANS, THE ABOVE SCALES MAY BE USED.

**J.U.L.I.E.
JOINT UTILITY LOCATION INFORMATION FOR EXCAVATION
1-800-892-0123**

CONTRACT NO.

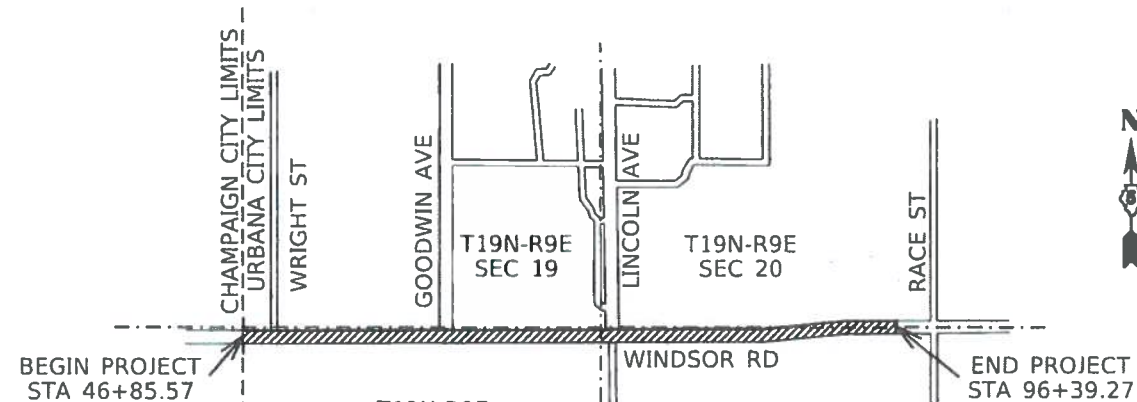

NOT TO SCALE
LOCATION MAP

GROSS LENGTH OF PROJECT = 4953.7 FEET (0.94 MILES)
NET LENGTH OF PROJECT = 4953.7 FEET (0.94 MILES)



Matthew R. Smith
3/30/2022
Date
License Expires 11/30/2023

FUHRMANN ENGINEERING
1401 REGENCY DR EAST
SUITE B
SAVOY, ILLINOIS
61874
(217) 607-2185

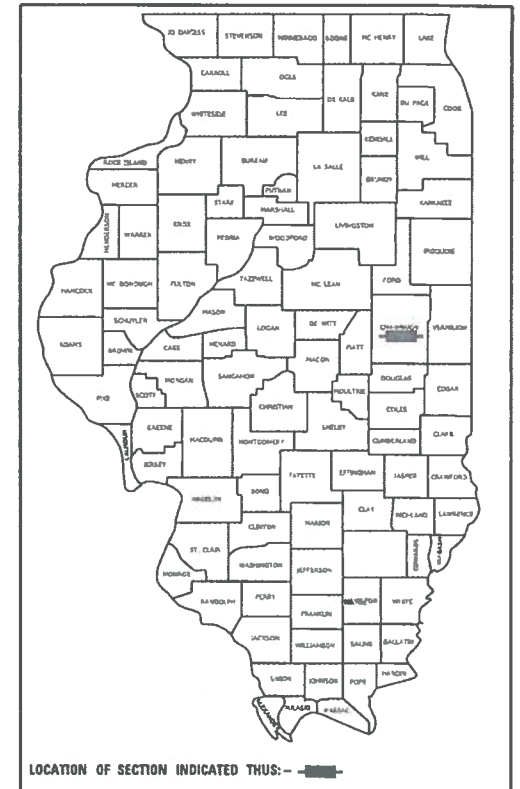

City of Urbana Phone: (217) 384-2342
706 South Glover Avenue Fax: (217)-384-0200
Urbana, IL 61802 www.urbanainillinois.us

CITY OF URBANA	
APPROVED	<i>April 8 20 22</i> <i>John C. Jones</i> CITY ENGINEER
PASSED	<i>APRIL 22 20 22</i> <i>[Signature]</i> DISTRICT 5 ENGINEER OF LOCAL ROAD & STREETS
RELEASING FOR BID BASED ON LIMITED REVIEW	<i>April 22 20 22</i> <i>[Signature]</i> REGION 3 ENGINEER

GENERAL NOTES

1. NO WORK SHALL COMMENCE UNTIL THE PROPOSED TRAFFIC CONTROL IS IN PLACE AND HAS BEEN APPROVED BY THE ENGINEER.
2. THE CONTRACTOR SHALL VERIFY ALL DIMENSIONS AND CONDITIONS IN THE FIELD PRIOR TO CONSTRUCTION AND ORDERING MATERIALS.
3. WHERE SECTION OR SUBSECTION MONUMENTS ARE ENCOUNTERED, THE ENGINEER SHALL BE NOTIFIED BEFORE SUCH MONUMENTS ARE REMOVED. THE CONTRACTOR SHALL PROTECT AND CAREFULLY PRESERVE ALL PROPERTY MARKERS AND MONUMENTS UNTIL THE OWNER AND AUTHORIZED SURVEYOR, OR AGENT HAS WITNESSED, OR OTHERWISE REFERENCED THEIR LOCATION.
4. EXISTING UNDERGROUND AND ABOVE-GRADE FACILITIES, STRUCTURES, AND UTILITIES HAVE BEEN PLOTTED ON THESE CONTRACT DOCUMENTS BASED UPON THE INFORMATION AND SURVEYS AVAILABLE AT THE TIME OF DRAWING PREPARATION. THE LOCATION OF THESE FEATURES MUST, THEREFORE, BE CONSIDERED APPROXIMATE ONLY. IN ADDITION, THERE MAY BE OTHER FACILITIES, STRUCTURES, AND UTILITIES WHICH DID NOT EXIST (OR THE EXISTENCE OF WHICH WAS NOT KNOWN) AT THE TIME OF DRAWING PREPARATION. IT IS THE SOLE RESPONSIBILITY OF THE CONTRACTOR(S) TO HAVE ALL EXISTING FACILITIES, STRUCTURES, AND UTILITIES LOCATED IN THE FIELD PRIOR TO ANY EXCAVATION OR CONSTRUCTION ACTIVITY; AND TO PROTECT ALL SUCH EXISTING FEATURES (EXCEPT THOSE SPECIFICALLY NOTED FOR REMOVAL OR DEMOLITION) DURING CONSTRUCTION.
5. THE THICKNESS OF BITUMINOUS MIXTURE SHOWN ON THE PLANS IS THE NOMINAL THICKNESS. DEVIATIONS FROM THE NOMINAL THICKNESS WILL BE PERMITTED WHEN SUCH DEVIATIONS OCCUR DUE TO IRREGULARITIES IN THE EXISTING SURFACE OR BASE ON WHICH THE BITUMINOUS MIXTURE IS PLACED.
6. FACTORS USED FOR ESTIMATING PLAN QUANTITIES ARE AS FOLLOWS AND SHALL NOT BE USED FOR THE BASIS OF FINAL QUANTITIES:

HOT-MIX ASPHALT	112	LB/SY/IN
GRANULAR MATERIALS	2.05	TONS/CY
TACK COAT	0.05	LB/SF
CRACKS JOINTS & FLANGEWAYS	0.0003	TONS/SY
SHORT TERM PAVEMENT MARKINGS	10' PER	100'
7. THE ENGINEER SHALL BE THE SOLE JUDGE CONCERNING CURING TIME FOR THE VARIOUS BITUMINOUS LIFTS.
8. FOR STABILIZATION, ALL TYPE III BARRICADES SHALL REQUIRE A MINIMUM OF FOUR SANDBAGS PER BARRICADE.
9. ALL CONSTRUCTION WARNING SIGNS SHALL BE 48" FLUORESCENT ORANGE.
10. THE FINAL PAVEMENT MARKINGS SHALL BE IN PLACE PRIOR TO PLACING THE RAISED REFLECTIVE PAVEMENT MARKERS.
11. IT IS THE CONTRACTOR'S RESPONSIBILITY TO ASCERTAIN EXISTING FIELD CONDITIONS BEFORE BIDDING ON THE PROJECT.
12. PAVEMENT CORE INFORMATION CAN BE FOUND IN THE PROPOSAL BOOKLET IF APPLICABLE.
13. SHORT TERM PAVEMENT MARKING SHALL BE APPLIED TO THE PAVEMENT AFTER ANY OF THE FOLLOWING: COLD MILLING AND/OR PLACING BITUMINOUS MATERIALS (TACK COAT), LEVELING BINDER (MACHINE METHOD), BINDER AND SURFACE COURSES. SHORT TERM PAVEMENT MARKING PLACED ON THE SURFACE SHALL COINCIDE WITH THE FINAL PAVEMENT STRIPING. SHORT TERM PAVEMENT MARKING PLACED PRIOR TO THE SURFACE SHALL COINCIDE WITH THE EXISTING PAVEMENT MARKINGS. USE 4 FEET PER 40 FEET (OR 10% PER STATION).
14. AGGREGATE SURFACE COURSE, TYPE B WILL BE PLACED AT THE LOCATIONS INDICATED, IN ORDER TO REFRESH THE SURFACE OF THE EXISTING ENTRANCES AND SHALL BE PLACED AT AN ASSUMED THICKNESS OF 2½".

MIXTURE REQUIREMENTS

THE FOLLOWING MIXTURE REQUIREMENTS ARE APPLICABLE FOR THIS PROJECT:	
LOCATION(S):	WINDSOR RD FROM STA. 46+85.57 TO STA. 96+39.27
MIXTURE USE(S):	SURFACE COURSE
AC/PG:	SBS PG 70-22
DESIGN AIR VOIDS	4.0% @ Ndes=70
MIXTURE COMP (GRADATION)	IL 9.5
FRICION	MIX D
AGGREGATE	
MIXTURE WEIGHT	112
QUALITY MANAGE-MENT PROGRAM	QC/QA
SUBLOT SIZE	N.A.
MATERIAL TRANSFER DEVICE (REQUIRED?)	NO

COMMITMENTS

THE CONTRACTOR'S TRAFFIC CONTROL PLAN SHALL BE REVIEWED AND APPROVED BY BOTH THE CITY OF URBANA AND THE CITY OF CHAMPAIGN.

SUGGESTED STAGES OF CONSTRUCTION

STAGE 1

MAINTENANCE OF TRAFFIC

1. CLOSE THE OUTSIDE LANES AND SHIFT EASTBOUND AND WESTBOUND TRAFFIC TO THE INSIDE LANES.
2. UTILIZE THE ILLINOIS DEPARTMENT OF TRANSPORTATION STANDARDS FOR LANE CLOSURES.

CONSTRUCTION

1. MILL EASTBOUND AND WESTBOUND SHOULDERS.
2. MILL EASTBOUND AND WESTBOUND OUTSIDE LANES.

STAGE 2

MAINTENANCE OF TRAFFIC

1. CLOSE THE INSIDE LANES AND SHIFT EASTBOUND AND WESTBOUND TRAFFIC TO THE OUTSIDE LANES.
2. UTILIZE THE ILLINOIS DEPARTMENT OF TRANSPORTATION STANDARDS FOR LANE CLOSURES.

CONSTRUCTION

1. MILL EASTBOUND AND WESTBOUND INSIDE LANES.
2. RESURFACE EASTBOUND AND WESTBOUND INSIDE LANES.

STAGE 3

MAINTENANCE OF TRAFFIC

1. CLOSE THE OUTSIDE LANES AND SHIFT EASTBOUND AND WESTBOUND TRAFFIC TO THE INSIDE LANES.
2. UTILIZE THE ILLINOIS DEPARTMENT OF TRANSPORTATION STANDARDS FOR LANE CLOSURES.
3. UTILIZE MOVING OPERATIONS TO INSTALL NEW DETECTOR LOOPS AT WINDSOR AND LINCOLN.

CONSTRUCTION

1. RESURFACE EASTBOUND AND WESTBOUND OUTSIDE LANES.
2. RESURFACE EASTBOUND AND WESTBOUND SHOULDERS.
3. INSTALL NEW DETECTOR LOOPS AT WINDSOR AND LINCOLN.

MODEL: Default
FILE NAME: C:\EIBS\2022\22-1924 - WINDSOR RD RESURFACING CITY OF URBANA\CADD\CADD Sheet\22-1924-02-GeneralNotes.dgn

SUMMARY OF QUANTITIES

CODE NO	ITEM	UNIT	QUANTITY TOTAL	MFT	NON-PARTICIPATING
40200800	AGGREGATE SURFACE COURSE, TYPE B	TON	26	26	
40600290	BITUMINOUS MATERIALS (TACK COAT)	POUND	18771	18771	
40600370	LONGITUDINAL JOINT SEALANT	FOOT	26561	26561	
40600400	MIXTURE FOR CRACKS, JOINTS, AND FLANGEWAYS	TON	12.5	12.5	
40600990	TEMPORARY RAMP	SQ YD	299	299	
40604162	POLYMERIZED HOT-MIX ASPHALT SURFACE COURSE, IL-9.5, MIX "D", N70	TON	5840	5840	
44000159	HOT-MIX ASPHALT SURFACE REMOVAL, 2 1/2"	SQ YD	41712	41712	
48102100	AGGREGATE WEDGE SHOULDER, TYPE B	TON	232	232	
64200116	SHOULDER RUMBLE STRIPS, 16 INCH	FOOT	9735	9735	
67100100	MOBILIZATION	L SUM	1	1	
70300100	SHORT TERM PAVEMENT MARKING	FOOT	6591	6591	
70300150	SHORT TERM PAVEMENT MARKING REMOVAL	SQ FT	17893	17893	
70306100	TEMPORARY PAVEMENT MARKING LETTERS AND SYMBOLS - TYPE III TAPE	SQ FT	313	313	
70306120	TEMPORARY PAVEMENT MARKING - LINE 4" - TYPE III TAPE	FOOT	14682	14682	

* SPECIALTY ITEM

CODE NO	ITEM	UNIT	QUANTITY TOTAL	MFT	NON-PARTICIPATING
70336130	TEMPORARY PAVEMENT MARKING - LINE 6" - TYPE III TAPE	FOOT	19827	19827	
70336160	TEMPORARY PAVEMENT MARKING - LINE 12"- TYPE III TAPE	FOOT	524	524	
70336210	TEMPORARY PAVEMENT MARKING - LINE 24"- TYPE III TAPE	FOOT	61	61	
78000100	THERMOPLASTIC PAVEMENT MARKING - LETTERS AND SYMBOLS	SQ FT	313	313	
78000200	THERMOPLASTIC PAVEMENT MARKING - LINE 4"	FOOT	14682	14682	
78000400	THERMOPLASTIC PAVEMENT MARKING - LINE 6"	FOOT	19827	19827	
78000600	THERMOPLASTIC PAVEMENT MARKING - LINE 12"	FOOT	524	524	
78000650	THERMOPLASTIC PAVEMENT MARKING - LINE 24"	FOOT	61	61	
78100100	RAISED REFLECTIVE PAVEMENT MARKER	EACH	295	295	
78300200	RAISED REFLECTIVE PAVEMENT MARKER REMOVAL	EACH	295	295	
88600600	DETECTOR LOOP REPLACEMENT	FOOT	428	428	
X6026628	VALVE BOXES TO BE REPLACED	EACH	3		3
X7010216	TRAFFIC CONTROL AND PROTECTION, (SPECIAL)	L SUM	1	1	

* SPECIALTY ITEM

MODEL: C:\EIT\Bids\2022\22-1924\WINDSOR_RD_RESURFACING_CITY_OF_URBANA\CADD\CADD_Sheets\22-1924\03-500.dgn



USER NAME = untitled	DESIGNED - MRS	REVISED -
PLOT SCALE = 2,000' / in.	DRAWN - MRS	REVISED -
PLOT DATE = 4/15/2022	CHECKED - BDS	REVISED -
	DATE - 4/18/2022	REVISED -



SUMMARY OF QUANTITIES	
SCALE: NTS	SHEET 1 OF 1 SHEETS STA. TO STA.

F.A.U. RTE. 7145	SECTION 21-00637-00-R5	COUNTY CHAMPAIGN	TOTAL SHEETS 20	SHEET NO. 3
CONTRACT NO.				
ILLINOIS FED. AID PROJECT				

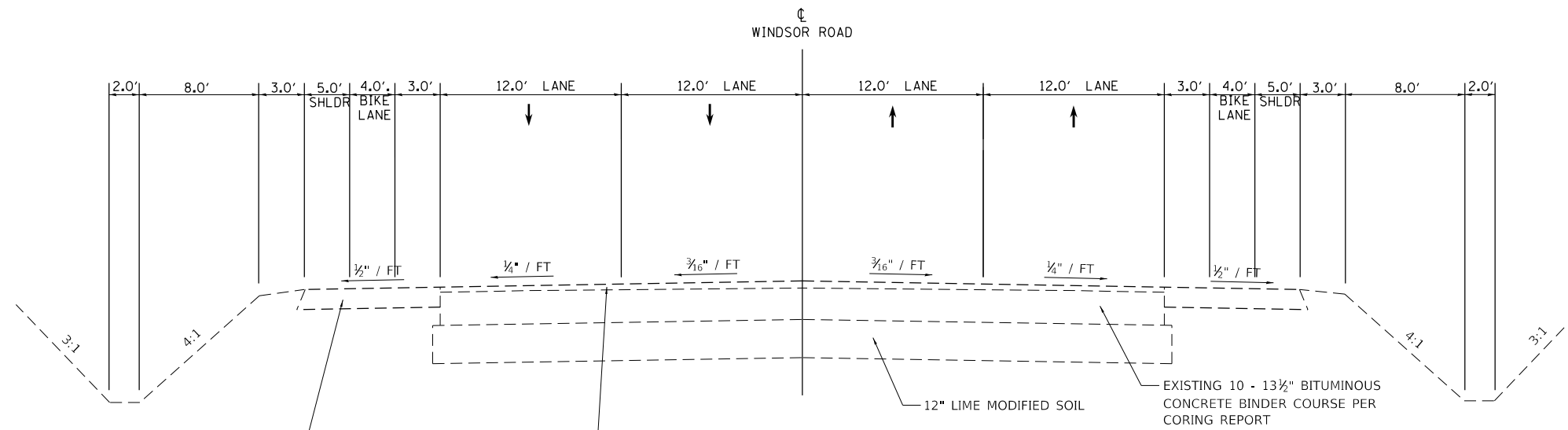

WINDSOR ROAD
EXISTING ROAD SECTION
STA 46+85.57 TO STA 96+39.27

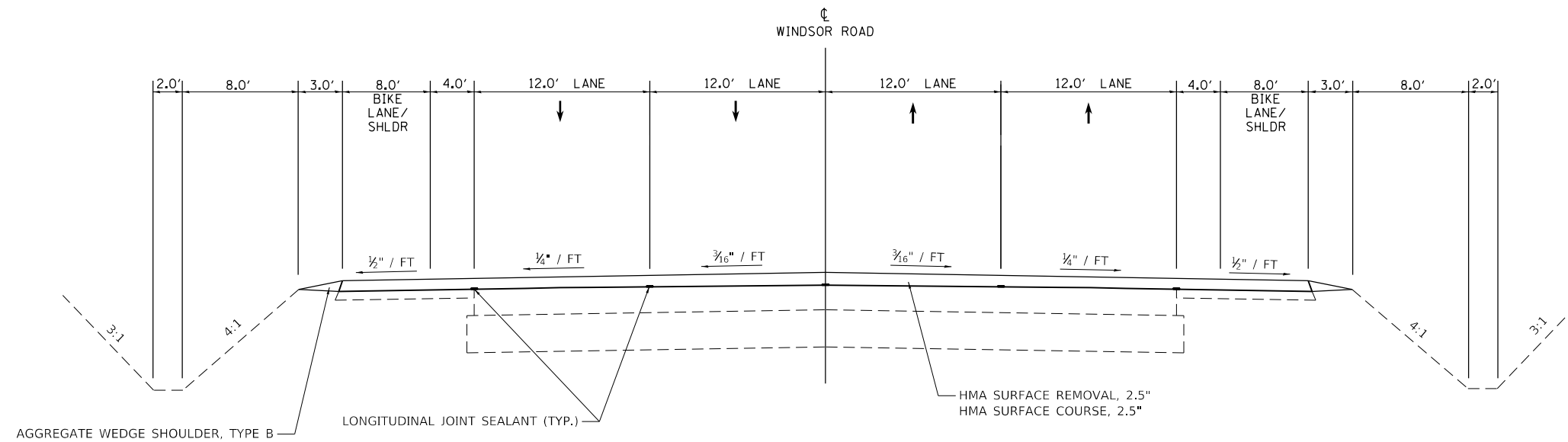

WINDSOR ROAD
PROPOSED ROAD SECTION
STA 46+85.57 TO STA 96+39.27

MODEL FILE NAME: C:\EIT\Bids\2022\22-1924-WINDSOR_RD_RESURFACING_CITY_OF_URBANA\CADD\CADD Sheets\22-1924-04-TypicalSections.dgn



USER NAME = untitled
PLOT SCALE = 10.0000 ' / in.
PLOT DATE = 4/15/2022

DESIGNED - MRS
DRAWN - MRS
CHECKED - BDS
DATE - 4/18/2022

REVISED -
REVISED -
REVISED -
REVISED -



TYPICAL SECTIONS

SCALE: 1" = 5' SHEET 1 OF 1 SHEETS STA. TO STA.

F.A.U. RTE.	SECTION	COUNTY	TOTAL SHEETS	SHEET NO.
7145	21-00637-00-RS	CHAMPAIGN	20	4
CONTRACT NO.				
SCALE: 1"=10'		ILLINOIS FED. AID PROJECT		

PAVEMENT										
LOCATION	AGGREGATE SURFACE COURSE, TYPE B	BITUMINOUS MATERIALS (TACK COAT)	LONGITUDINAL JOINT SEALANT	MIXTURE FOR CRACKS, JOINTS, AND FLANGEWAYS	TEMPORARY RAMP	POLYMERIZED HOT-MIX ASPHALT SURFACE COURSE, IL-9.5, MIX "D", N70	HOT-MIX ASPHALT SURFACE REMOVAL, 2 1/2"	AGGREGATE WEDGE SHOULDER, TYPE B	SHOULDER RUMBLE STRIPS, 16 INCH	VALVE BOXES TO BE REPLACED
	40200800	40600290	40600370	40600400	40600990	40604162	44000159	48102100	64200116	X6026628
	TON	POUND	FOOT	TON	SQ YD	TON	SQ YD	TON	FOOT	EACH
46+85.57 TO 96+39.27		18771	26561	12.5		5840	41712	232	9735	
46+85.57					53					
47+73.74										
47+74.81	4									
59+95.68	10									
60+46.14	4									
72+66.58 TO 74+39.38					192					
73+88.30										1
86+79.44	4									
86+85.14	4									
87+08.70										2
96+39.27					54					
TOTAL	26	18771	26561	12.5	299	5840	41712	232	9735	3

PAVEMENT MARKINGS														
LOCATION	SHORT TERM PAVEMENT MARKING	SHORT TERM PAVEMENT MARKING REMOVAL	TEMPORARY PAVEMENT MARKING LETTERS AND SYMBOLS - TYPE III TAPE	TEMPORARY PAVEMENT MARKING - LINE 4" - TYPE III TAPE	TEMPORARY PAVEMENT MARKING - LINE 6" - TYPE III TAPE	TEMPORARY PAVEMENT MARKING - LINE 12" - TYPE III TAPE	TEMPORARY PAVEMENT MARKING - LINE 24" - TYPE III TAPE	THERMOPLASTIC PAVEMENT MARKINGS - LETTERS AND SYMBOLS	THERMOPLASTIC PAVEMENT MARKINGS - LINE 4"	THERMOPLASTIC PAVEMENT MARKINGS - LINE 6"	THERMOPLASTIC PAVEMENT MARKINGS - LINE 12"	THERMOPLASTIC PAVEMENT MARKINGS - LINE 24"	RAISED REFLECTIVE PAVEMENT MARKER	RAISED REFLECTIVE PAVEMENT MARKER REMOVAL
	70300100	70300150						78000100	78000200	78000400	78000600	78000650	78100100	78300200
	FOOT	SQ FT						SQ FT	FOOT	FOOT	FOOT	FOOT	EACH	EACH
46+85.57 TO 96+39.27	6591	12402	313		19827			313		19827			295	295
46+85.57 TO 73+00.00		2486		7534					7534					
66+00.00 TO 70+00.00		107				107					107			
73+02.00		76					38						38	
73+10.00		136				136					136			
74+00.00 TO 96+39.27		2359		7148					7148					
74+08.00 TO 81+00.00		281				281					281			
74+08.00		46					23						23	
TOTAL	6591	17893	313	14682	19827	524	61	313	14682	19827	524	61	295	295

MODEL FILE NAME: C:\EIT\Bids_2022\22-1924_WINDSOR_RD RESURFACING CITY OF URBANA\CADD\CADD Sheets\22-1924-05-Schedule of Quantities.dgn



USER NAME = untitled	DESIGNED - MRS	REVISED -
	DRAWN - MRS	REVISED -
PLOT SCALE = 4,0000 ' / in.	CHECKED - BDS	REVISED -
PLOT DATE = 4/15/2022	DATE - 4/18/2022	REVISED -



SCHEDULE OF QUANTITIES			
SCALE: NTS	SHEET 1 OF 1 SHEETS	STA.	TO STA.

F.A.U. RTE.	SECTION	COUNTY	TOTAL SHEETS	SHEET NO.
7145	21-00637-00-RS	CHAMPAIGN	20	5
CONTRACT NO.				
ILLINOIS FED. AID PROJECT				

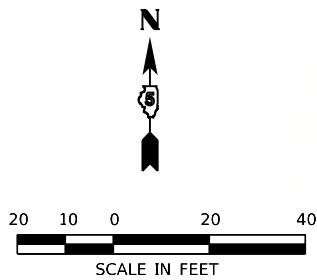
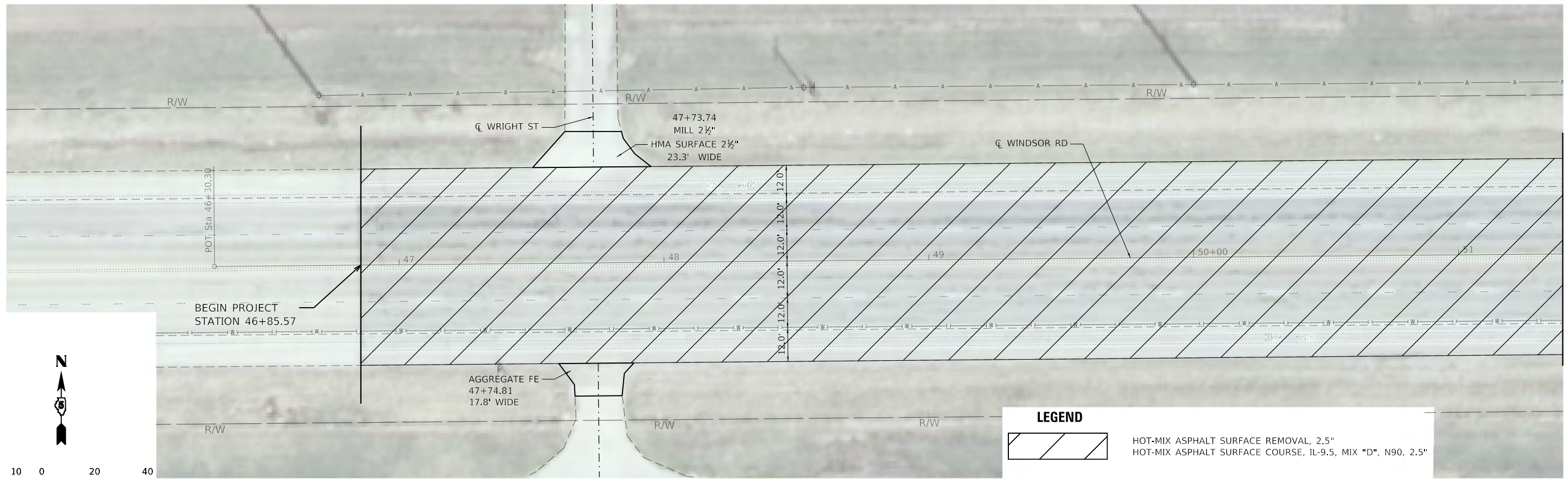

LEGEND	
	HOT-MIX ASPHALT SURFACE REMOVAL, 2.5"
	HOT-MIX ASPHALT SURFACE COURSE, IL-9.5, MIX "D", N90, 2.5"

SEE BELOW

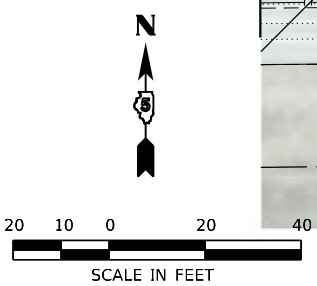

SEE ABOVE

SEE NEXT SHEET

MODEL: C:\Users\BDS\AppData\Local\Temp\20220222-1924-WINDSOR_RD_RESURFACING_CITY_OF_URBANA\CADD\CADD_Sheets\22-1924-06-R1a.dgn



USER NAME = untitled	DESIGNED - MRS	REVISED -
DRAWN - MRS	DRAWN - MRS	REVISED -
PLOT SCALE = 40.0000 ' / in.	CHECKED - BDS	REVISED -
PLOT DATE = 4/15/2022	DATE - 4/18/2022	REVISED -



PLAN SHEET

SCALE: 1" = 20' SHEET 1 OF 5 SHEETS STA. TO STA.

F.A.U. RTE.	SECTION	COUNTY	TOTAL SHEETS	SHEET NO.
7145	21-00637-00-RS	CHAMPAIGN	20	6
CONTRACT NO.				
ILLINOIS FED. AID PROJECT				

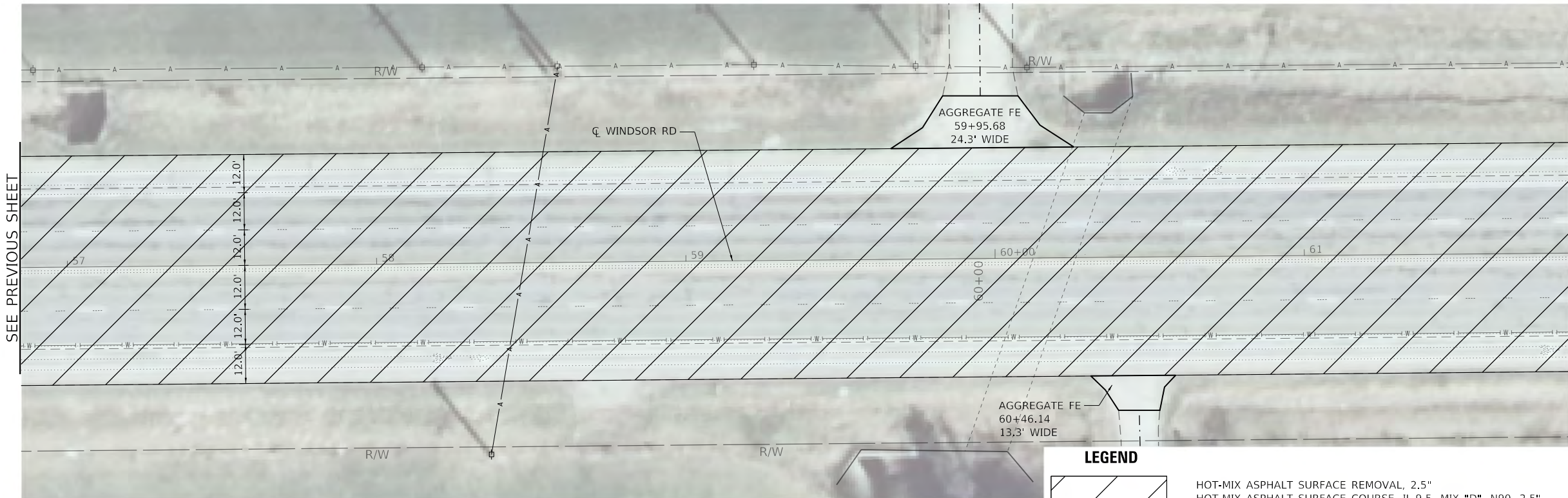

SEE PREVIOUS SHEET

SEE BELOW

LEGEND

	HOT-MIX ASPHALT SURFACE REMOVAL, 2.5"
	HOT-MIX ASPHALT SURFACE COURSE, IL-9.5, MIX "D", N90, 2.5"

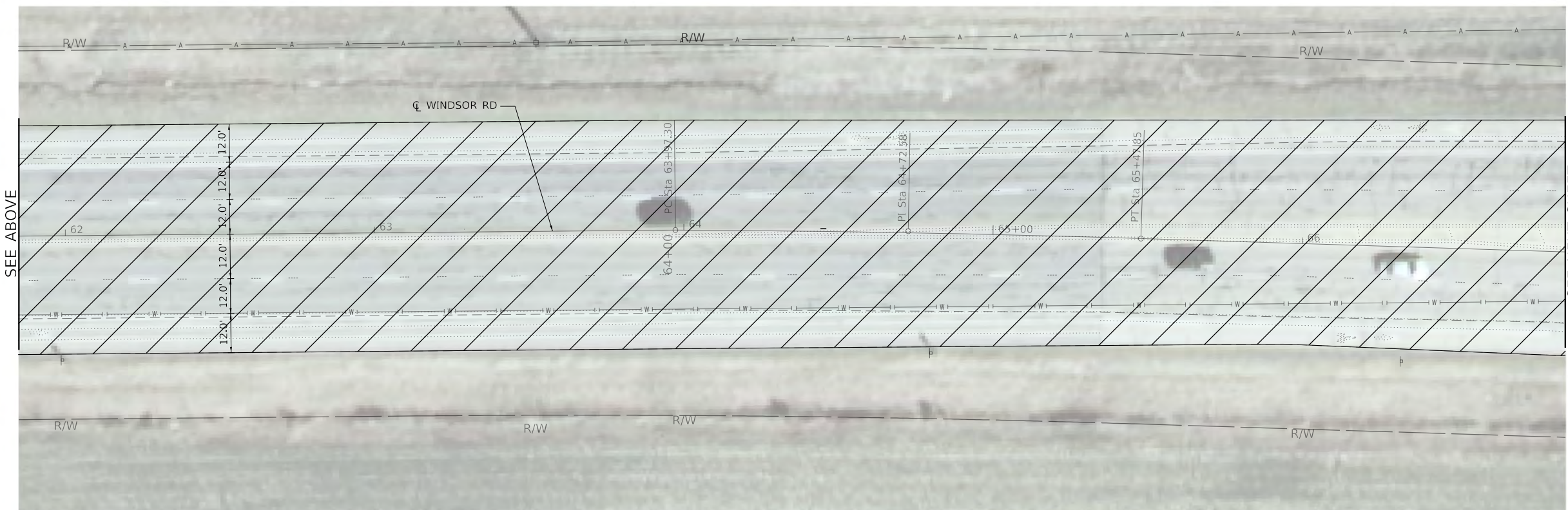
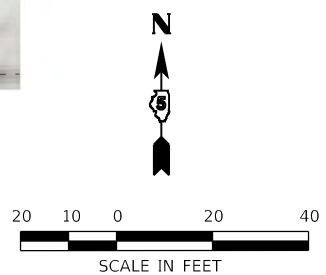

SEE ABOVE

SEE NEXT SHEET

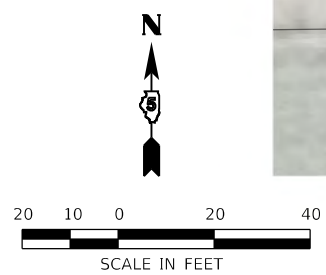

MODEL: C:\EIT\BBS\2022\22-1924_WINDSOR_RD_RESURFACING_CITY_OF_URBANA\CADD\CADD_Sheets\22-1924-07-RPlan.dgn



USER NAME = untitled	DESIGNED - MRS	REVISED -
DRAWN - MRS	REVISIONS	REVISED -
PLOT SCALE = 40.0000 ' / in.	CHECKED - BDS	REVISED -
PLOT DATE = 4/15/2022	DATE - 4/18/2022	REVISED -



PLAN SHEET

SCALE: 1" = 20' SHEET 2 OF 5 SHEETS STA. TO STA.

F.A.U. RTE.	SECTION	COUNTY	TOTAL SHEETS	SHEET NO.
7145	21-00637-00-RS	CHAMPAIGN	20	7
CONTRACT NO.				
ILLINOIS FED. AID PROJECT				

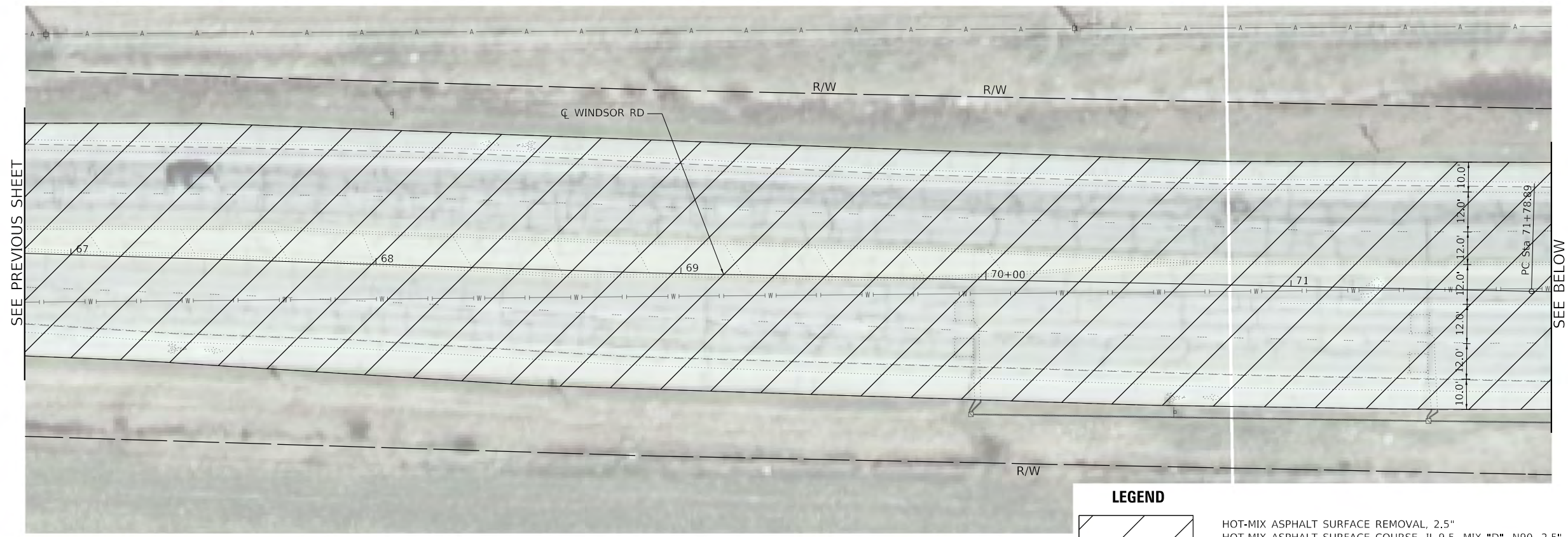

LEGEND

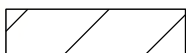
 HOT-MIX ASPHALT SURFACE REMOVAL, 2.5"
HOT-MIX ASPHALT SURFACE COURSE, IL-9.5, MIX "D", N90, 2.5"

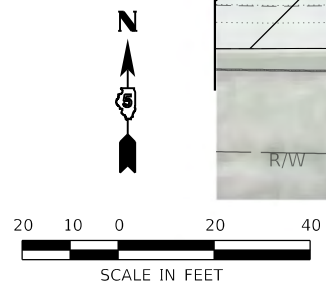
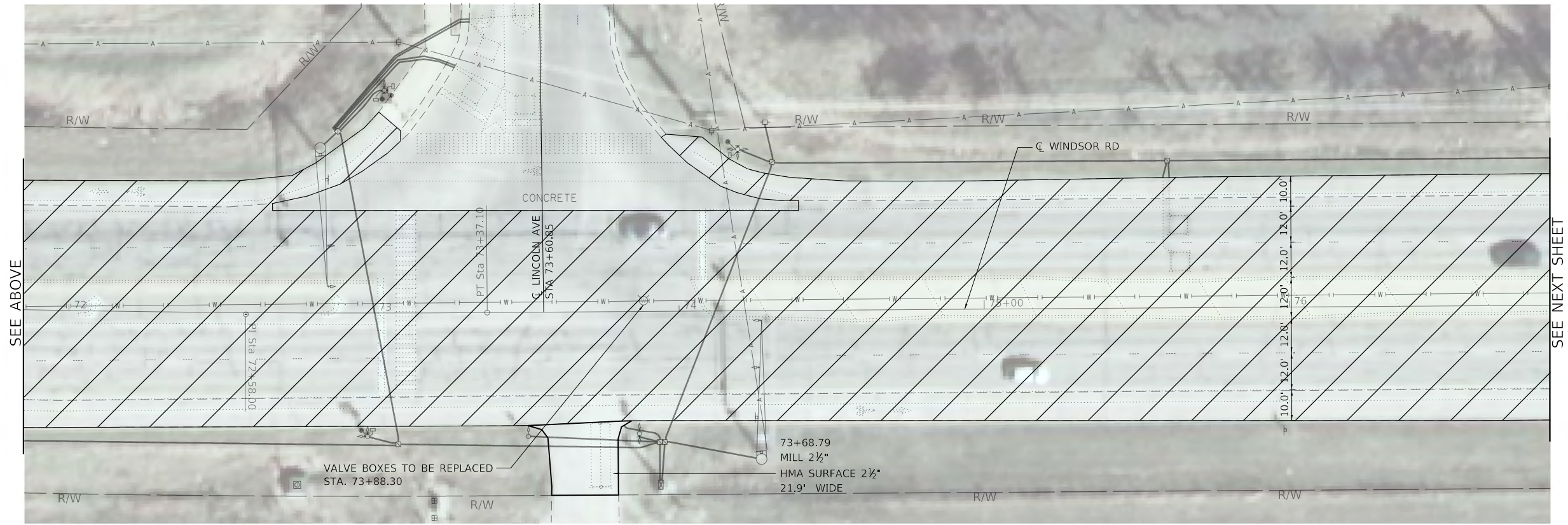
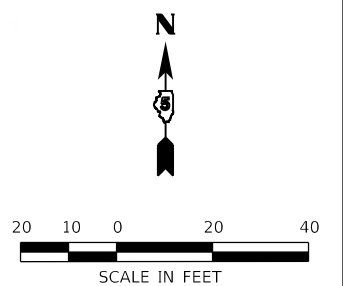

NOTE:
LOCATIONS OF VALVE BOXES IS APPROXIMATE, CONTRACTOR TO FIELD VERIFY.

MODEL: FILE NAME: C:\EIT\Bds\2022\22-1924_WINDSOR_RD_RESURFACING_CITY_OF_URBANA\CADD\CADD_Sheets\22-1924-08-Plan.dgn



USER NAME = untitled	DESIGNED - MRS	REVISED -
DRAWN - MRS	REVISIONS -	
PLOT SCALE = 40.0000' / in.	CHECKED - BDS	REVISED -
PLOT DATE = 4/15/2022	DATE - 4/18/2022	REVISED -



PLAN SHEET	
SCALE: 1" = 20'	SHEET 3 OF 5 SHEETS
STA.	TO STA.

F.A.U. RTE. 7145	SECTION 21-00637-00-RS	COUNTY CHAMPAIGN	TOTAL SHEETS 20	SHEET NO. 8
CONTRACT NO.				
ILLINOIS FED. AID PROJECT				

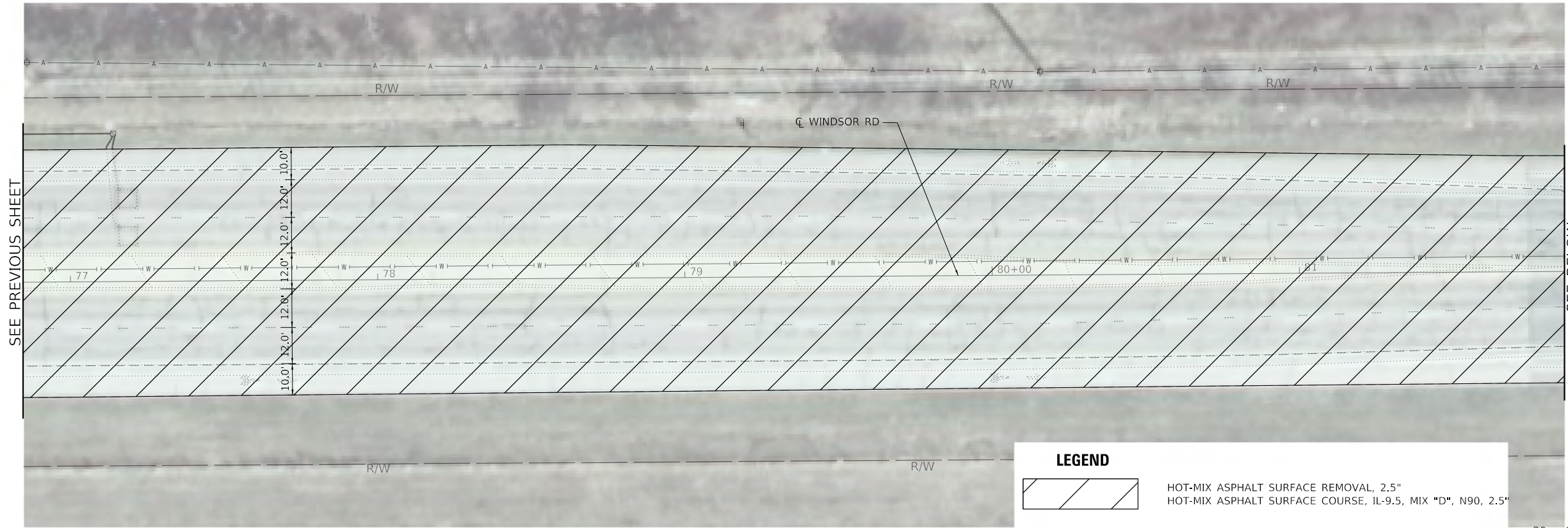

LEGEND	
	HOT-MIX ASPHALT SURFACE REMOVAL, 2.5"
	HOT-MIX ASPHALT SURFACE COURSE, IL-9.5, MIX "D", N90, 2.5"

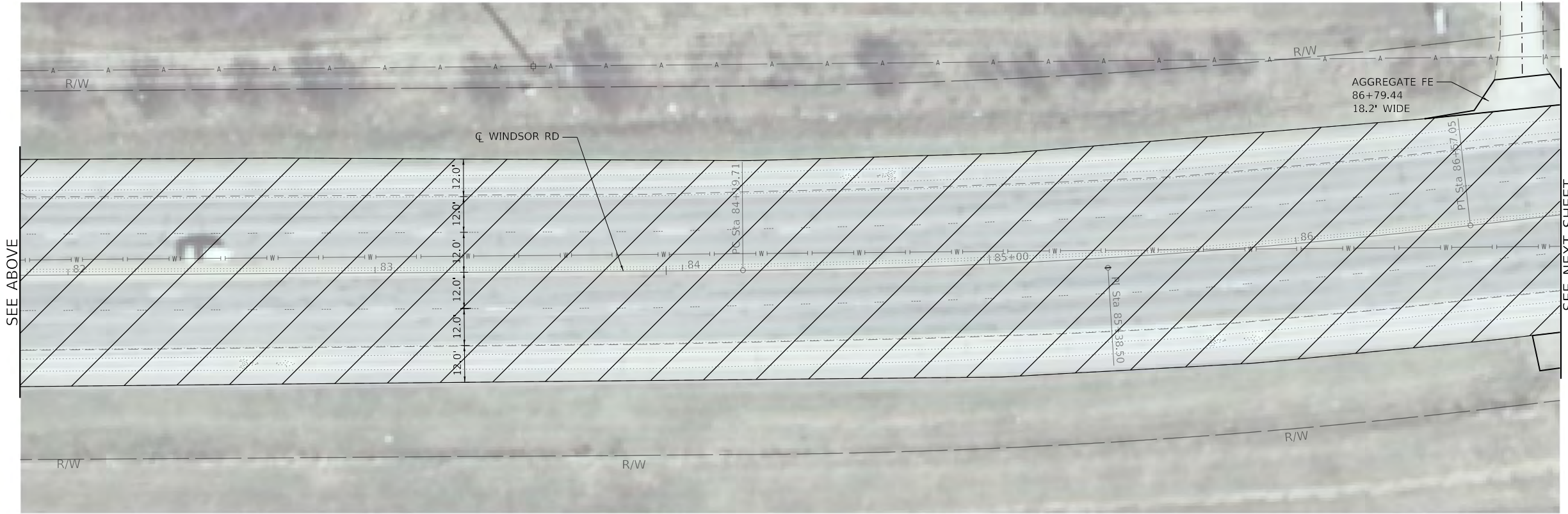

MODEL: C:\EIT\BBS\2022\22-1924_WINDSOR_RD_RESURFACING_CITY_OF_URBANA\CADD\CADD Sheets\22-1924-09-R1a.dgn
 FILE NAME: C:\EIT\BBS\2022\22-1924_WINDSOR_RD_RESURFACING_CITY_OF_URBANA\CADD\CADD Sheets\22-1924-09-R1a.dgn



USER NAME = untitled	DESIGNED - MRS	REVISED -
	DRAWN - MRS	REVISED -
PLOT SCALE = 40.0000 ' / in.	CHECKED - BDS	REVISED -
PLOT DATE = 4/15/2022	DATE - 4/18/2022	REVISED -



PLAN SHEET			
SCALE: 1" = 20'	SHEET 4 OF 5	SHEETS STA.	TO STA.

F.A.U. RTE.	SECTION	COUNTY	TOTAL SHEETS	SHEET NO.
7145	21-00637-00-RS	CHAMPAIGN	20	9
CONTRACT NO.				
ILLINOIS FED. AID PROJECT				

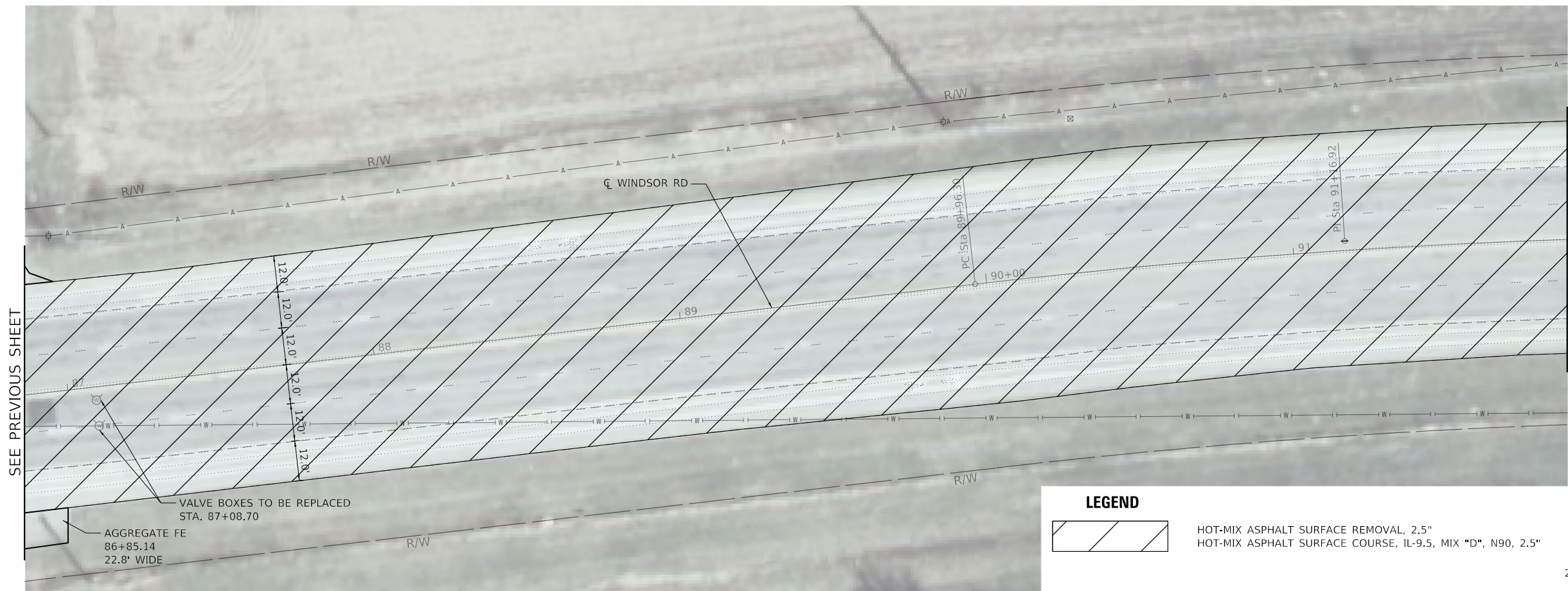

SEE PREVIOUS SHEET

SEE BELOW

VALVE BOXES TO BE REPLACED
STA. 87+08.70

AGGREGATE FE
86+85.14
22.8' WIDE

LEGEND

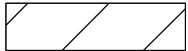
 HOT-MIX ASPHALT SURFACE REMOVAL, 2.5"

 HOT-MIX ASPHALT SURFACE COURSE, IL-9.5, MIX "D", N90, 2.5"

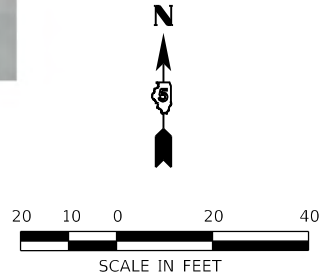

NOTE:
LOCATIONS OF VALVE BOXES IS APPROXIMATE, CONTRACTOR TO FIELD VERIFY.

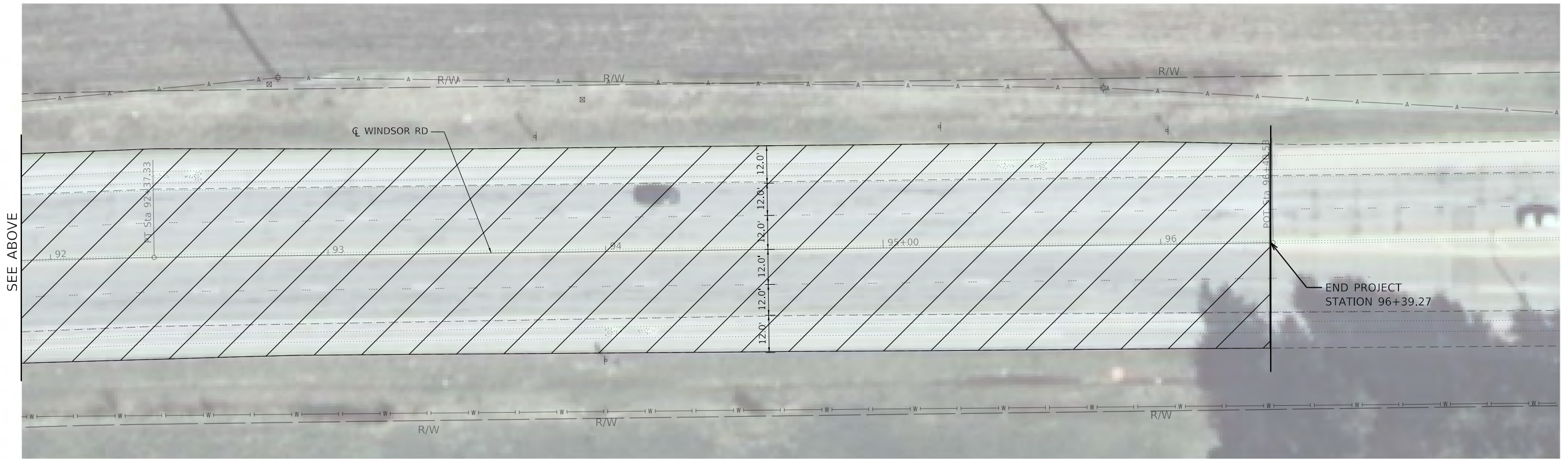

SEE ABOVE

END PROJECT
STATION 96+39.27

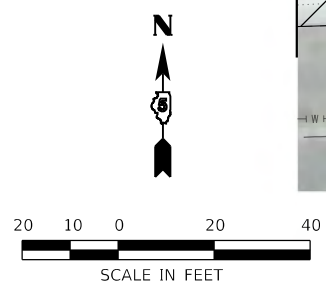

MODEL FILE NAME: C:\EIT\BDS\2022\22-1924-WINDSOR_RD_RESURFACING_CITY_OF_URBANA\CADD\CADD_Sheets\22-1924-10-Plan.dgn



USER NAME = untitled	DESIGNED - MRS	REVISED -
DRAWN - MRS	REVISIONS	
PLOT SCALE = 40.0000 ' / in.	CHECKED - BDS	REVISED -
PLOT DATE = 4/15/2022	DATE - 4/18/2022	REVISED -



PLAN SHEET			
SCALE: 1" = 20'	SHEET 5	OF 5 SHEETS	STA. TO STA.

F.A.U. RTE.	SECTION	COUNTY	TOTAL SHEETS	SHEET NO.
7145	21-00637-00-RS	CHAMPAIGN	20	10
CONTRACT NO.				
ILLINOIS FED. AID PROJECT				

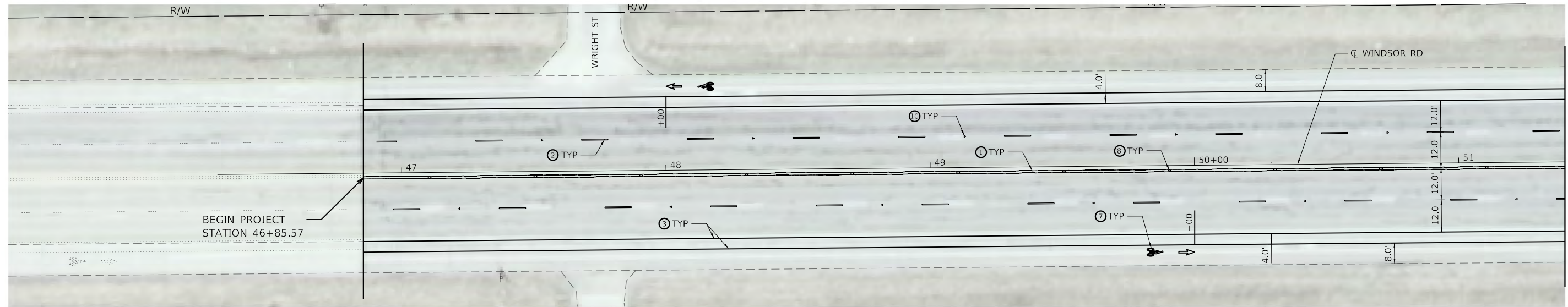

BEGIN PROJECT
STATION 46+85.57

NOTE:
SHOULDER RUMBLE STRIPS, 16 INCH SHALL BE INSTALLED ACCORDING TO
THE "BIKE LANE LAYOUT HIGH VOLUME STREET" DETAIL ON SHEET 20

- ① THERMOPLASTIC PAVEMENT MARKING - LINE 4" (SOLID DOUBLE YELLOW)
- ② THERMOPLASTIC PAVEMENT MARKING - LINE 4" (WHITE, 10'-30' SKIP DASH)
- ③ THERMOPLASTIC PAVEMENT MARKING - LINE 6" (SOLID WHITE)
- ④ THERMOPLASTIC PAVEMENT MARKING - LINE 12" (SOLID YELLOW)
- ⑤ THERMOPLASTIC PAVEMENT MARKING - LINE 12" (SOLID WHITE)
- ⑥ THERMOPLASTIC PAVEMENT MARKING - LINE 24" (SOLID WHITE)
- ⑦ THERMOPLASTIC PAVEMENT MARKING - LETTERS AND SYMBOLS
- ⑧ RAISED REFLECTIVE PAVEMENT MARKERS (TWO-WAY AMBER)
- ⑨ RAISED REFLECTIVE PAVEMENT MARKERS (ONE-WAY AMBER)
- ⑩ RAISED REFLECTIVE PAVEMENT MARKERS (ONE-WAY CRYSTAL)

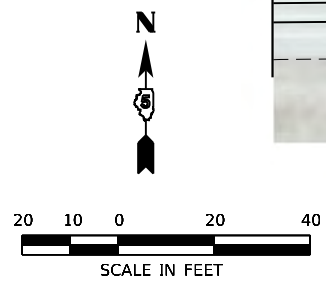
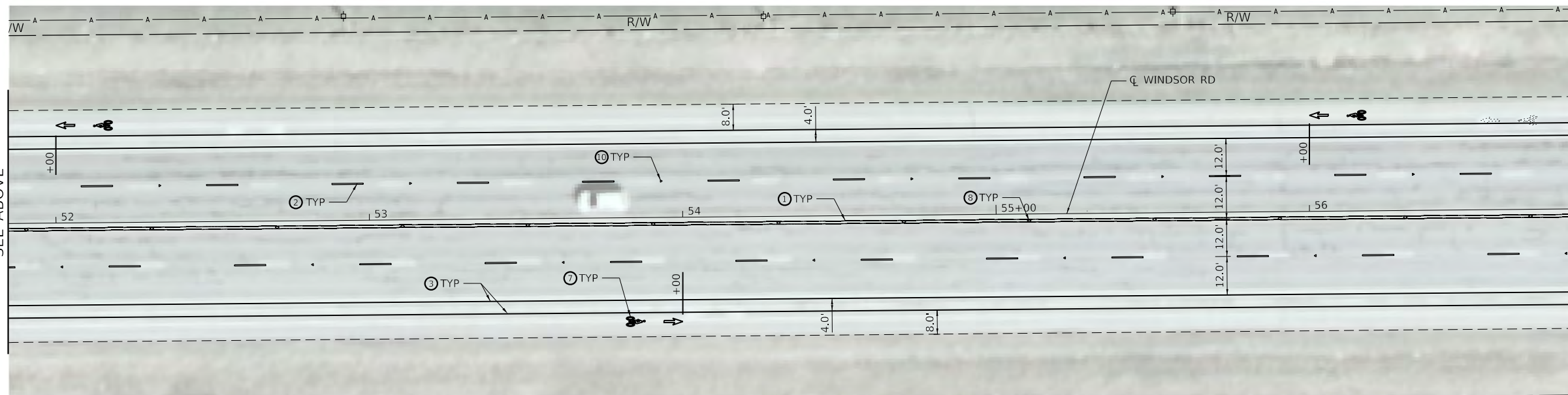
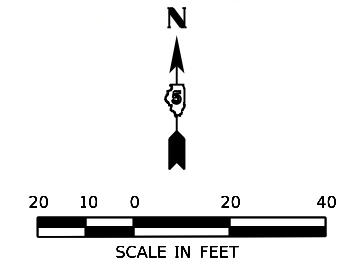

MODEL FILE NAME: C:\EIT\BDS_2022\22-1924_WINDSOR_RD_RESURFACING_CITY_OF_URBANA\CADD\CADD_Sheets\22-1924-11_PMK.dwg



USER NAME = untitled	DESIGNED - MRS	REVISED -
DRAWN - MRS	REVISIONS	REVISED -
PLOT SCALE = 40.0000' / in.	CHECKED - BDS	REVISED -
PLOT DATE = 4/15/2022	DATE - 4/18/2022	REVISED -



PAVEMENT MARKING

SCALE: 1" = 20' SHEET 1 OF 5 SHEETS STA. TO STA.

F.A.U. RTE.	SECTION	COUNTY	TOTAL SHEETS	SHEET NO.
7145	21-00637-00-RS	CHAMPAIGN	20	11
CONTRACT NO.				
ILLINOIS FED. AID PROJECT				

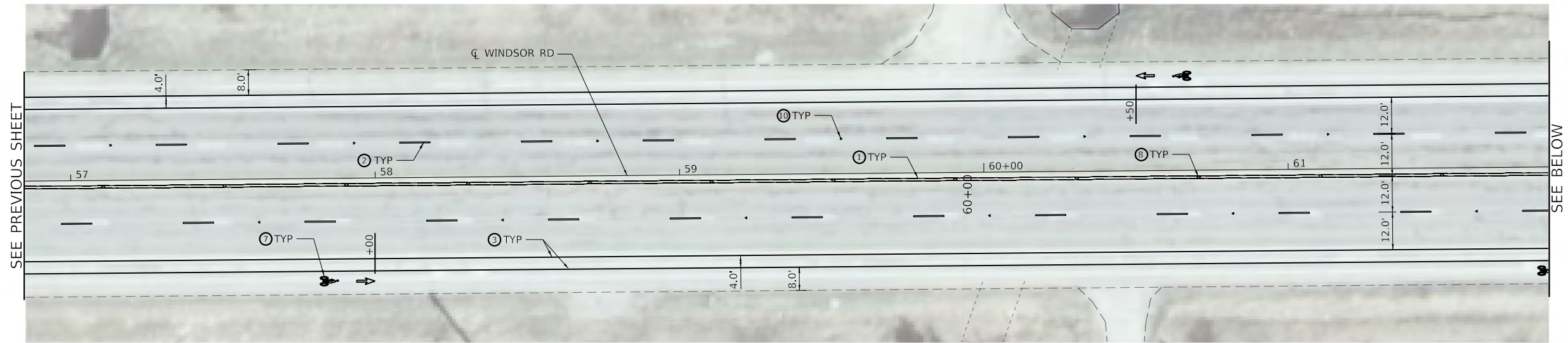

SEE PREVIOUS SHEET

SEE BELOW

- ① THERMOPLASTIC PAVEMENT MARKING - LINE 4" (SOLID DOUBLE YELLOW)
- ② THERMOPLASTIC PAVEMENT MARKING - LINE 4" (WHITE, 10'-30' SKIP DASH)
- ③ THERMOPLASTIC PAVEMENT MARKING - LINE 6" (SOLID WHITE)
- ④ THERMOPLASTIC PAVEMENT MARKING - LINE 12" (SOLID YELLOW)
- ⑤ THERMOPLASTIC PAVEMENT MARKING - LINE 12" (SOLID WHITE)
- ⑥ THERMOPLASTIC PAVEMENT MARKING - LINE 24" (SOLID WHITE)
- ⑦ THERMOPLASTIC PAVEMENT MARKING - LETTERS AND SYMBOLS
- ⑧ RAISED REFLECTIVE PAVEMENT MARKERS (TWO-WAY AMBER)
- ⑨ RAISED REFLECTIVE PAVEMENT MARKERS (ONE-WAY AMBER)
- ⑩ RAISED REFLECTIVE PAVEMENT MARKERS (ONE-WAY CRYSTAL)

NOTE:
SHOULDER RUMBLE STRIPS, 16 INCH SHALL BE INSTALLED ACCORDING TO THE "BIKE LANE LAYOUT HIGH VOLUME STREET" DETAIL ON SHEET 20

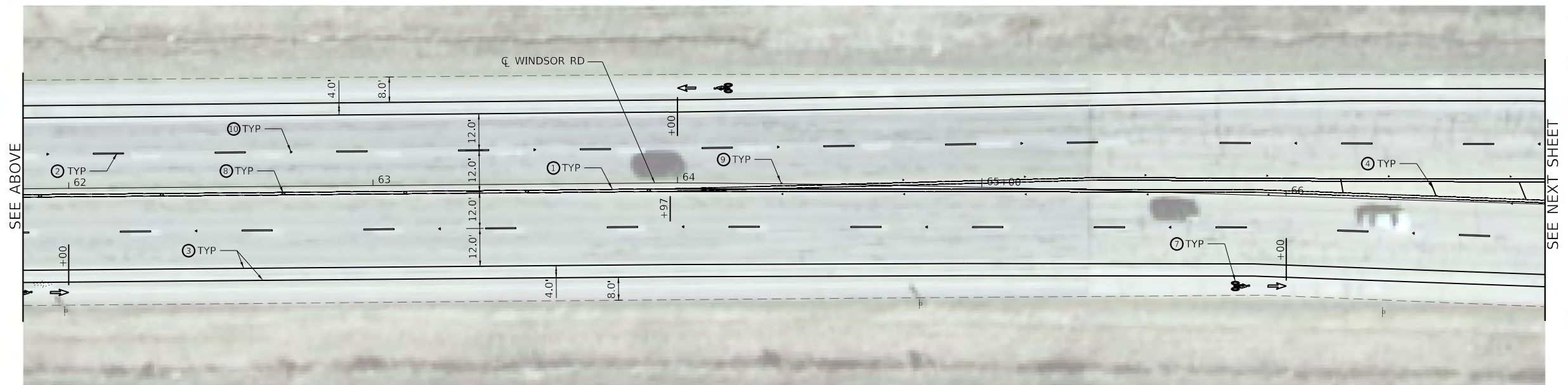
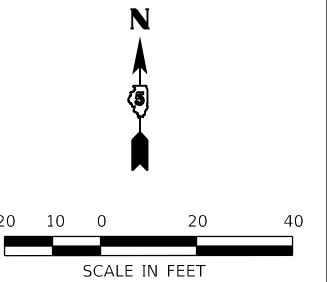

SEE ABOVE

SEE NEXT SHEET

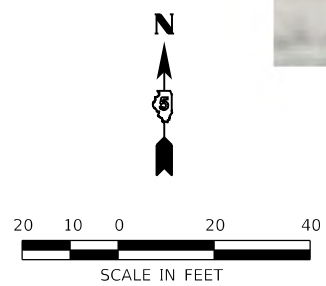

MODEL FILE NAME: C:\EIT\BDS\2022\22-1924-WINDSOR_RD_RESURFACING_CITY_OF_URBANA\CADD\CADD_Sheets\22-1924-12-PMK.dgn



USER NAME = untitled	DESIGNED - MRS	REVISED -
DRAWN - MRS	REVISIONS -	
PLOT SCALE = 40,0000 ' / in.	CHECKED - BDS	REVISED -
PLOT DATE = 4/15/2022	DATE - 4/18/2022	REVISED -



PAVEMENT MARKING

SCALE: 1" = 20' SHEET 2 OF 5 SHEETS STA. TO STA.

F.A.U. RTE.	SECTION	COUNTY	TOTAL SHEETS	SHEET NO.
7145	21-00637-00-RS	CHAMPAIGN	20	12
CONTRACT NO.				
ILLINOIS FED. AID PROJECT				

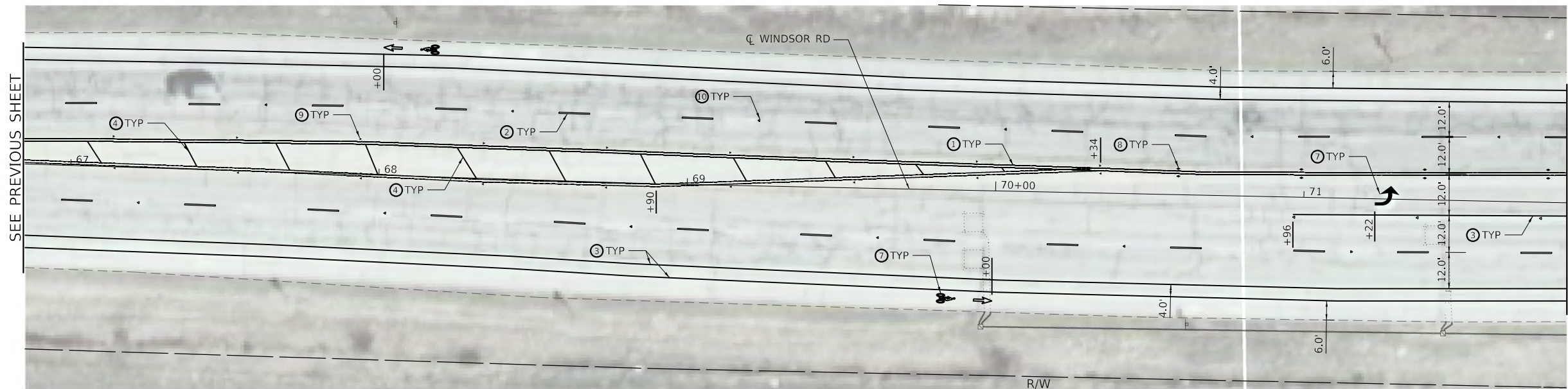

NOTE:
SHOULDER RUMBLE STRIPS, 16 INCH SHALL BE INSTALLED ACCORDING TO THE "BIKE LANE LAYOUT HIGH VOLUME STREET" DETAIL ON SHEET 20

- ① THERMOPLASTIC PAVEMENT MARKING - LINE 4" (SOLID DOUBLE YELLOW)
- ② THERMOPLASTIC PAVEMENT MARKING - LINE 4" (WHITE, 10'-30' SKIP DASH)
- ③ THERMOPLASTIC PAVEMENT MARKING - LINE 6" (SOLID WHITE)
- ④ THERMOPLASTIC PAVEMENT MARKING - LINE 12" (SOLID YELLOW)
- ⑤ THERMOPLASTIC PAVEMENT MARKING - LINE 12" (SOLID WHITE)
- ⑥ THERMOPLASTIC PAVEMENT MARKING - LINE 24" (SOLID WHITE)
- ⑦ THERMOPLASTIC PAVEMENT MARKING - LETTERS AND SYMBOLS
- ⑧ RAISED REFLECTIVE PAVEMENT MARKERS (TWO-WAY AMBER)
- ⑨ RAISED REFLECTIVE PAVEMENT MARKERS (ONE-WAY AMBER)
- ⑩ RAISED REFLECTIVE PAVEMENT MARKERS (ONE-WAY CRYSTAL)

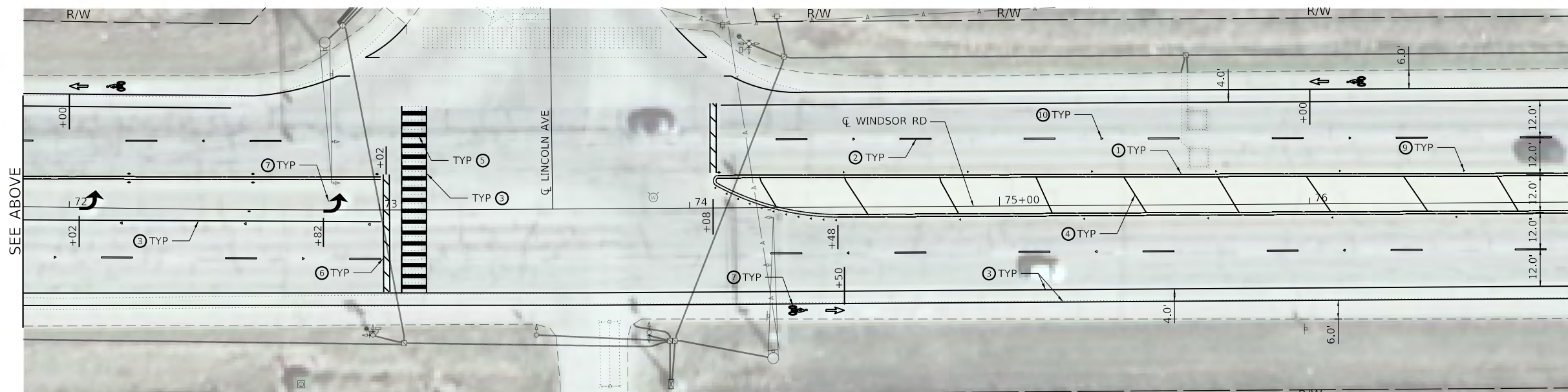
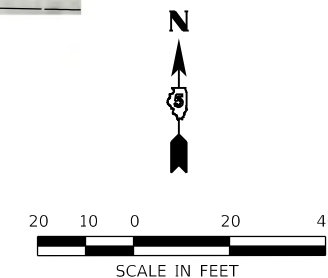

MODEL FILE NAME: C:\EIT\BDS\2022\22-1924-WINDSOR_RD_RESURFACING_CITY_OF_URBANA\CADD\CADD_Sheets\22-1924-13-PMK.dgn



USER NAME = untitled	DESIGNED - MRS	REVISED -
PLOT SCALE = 40.0000 ' / in.	DRAWN - MRS	REVISED -
PLOT DATE = 4/15/2022	CHECKED - BDS	REVISED -
	DATE - 4/18/2022	REVISED -



PAVEMENT MARKING

SCALE: 1" = 20' SHEET 3 OF 5 SHEETS STA. TO STA.

F.A.U. RTE.	SECTION	COUNTY	TOTAL SHEETS	SHEET NO.
7145	21-00637-00-RS	CHAMPAIGN	20	13
CONTRACT NO.				
ILLINOIS FED. AID PROJECT				

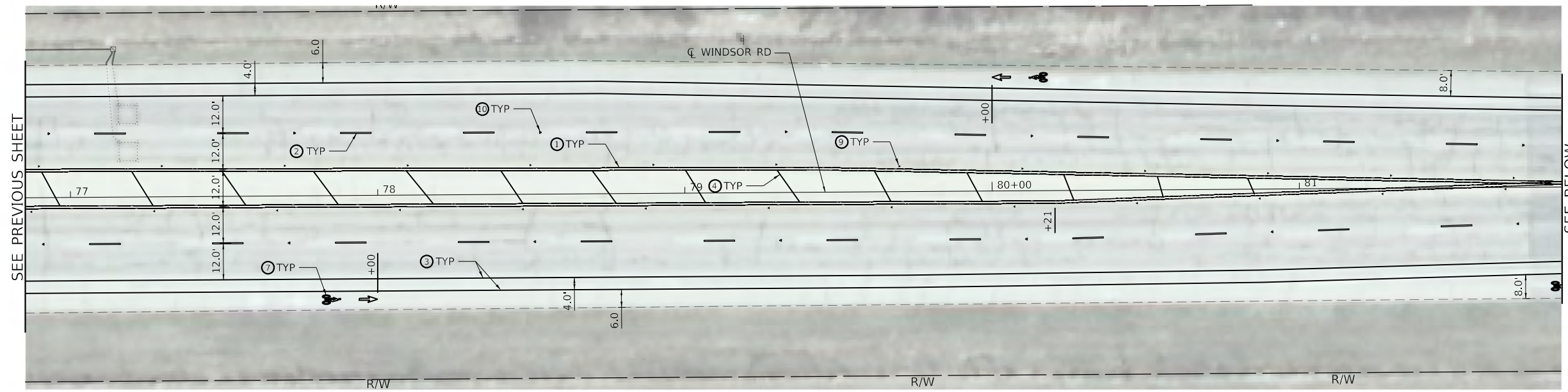

- ① THERMOPLASTIC PAVEMENT MARKING - LINE 4" (SOLID DOUBLE YELLOW)
- ② THERMOPLASTIC PAVEMENT MARKING - LINE 4" (WHITE, 10'-30' SKIP DASH)
- ③ THERMOPLASTIC PAVEMENT MARKING - LINE 6" (SOLID WHITE)
- ④ THERMOPLASTIC PAVEMENT MARKING - LINE 12" (SOLID YELLOW)
- ⑤ THERMOPLASTIC PAVEMENT MARKING - LINE 12" (SOLID WHITE)
- ⑥ THERMOPLASTIC PAVEMENT MARKING - LINE 24" (SOLID WHITE)
- ⑦ THERMOPLASTIC PAVEMENT MARKING - LETTERS AND SYMBOLS
- ⑧ RAISED REFLECTIVE PAVEMENT MARKERS (TWO-WAY AMBER)
- ⑨ RAISED REFLECTIVE PAVEMENT MARKERS (ONE-WAY AMBER)
- ⑩ RAISED REFLECTIVE PAVEMENT MARKERS (ONE-WAY CRYSTAL)

NOTE:
SHOULDER RUMBLE STRIPS, 16 INCH SHALL BE INSTALLED ACCORDING TO THE "BIKE LANE LAYOUT HIGH VOLUME STREET" DETAIL ON SHEET 20

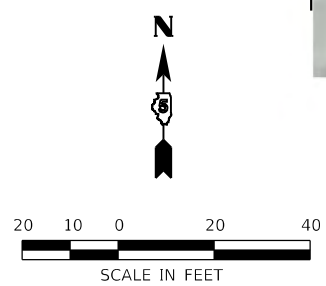
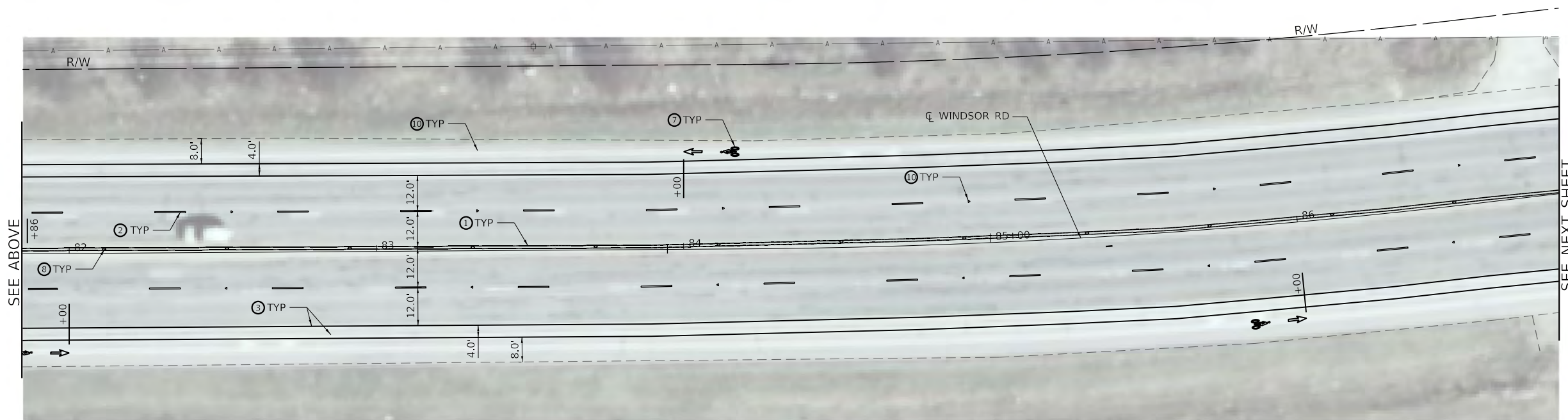
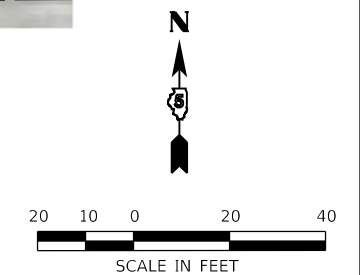

MODEL FILE NAME: C:\EIT\BDS\2022\22-1924-WINDSOR_RD_RESURFACING_CITY_OF_URBANACADD\CADD Sheets\22-1924-14-PMK.dwg



USER NAME = untitled	DESIGNED - MRS	REVISED -
DRAWN - MRS	REVISIONS -	
PLOT SCALE = 40.0000 ' / in.	CHECKED - BDS	REVISED -
PLOT DATE = 4/15/2022	DATE - 4/18/2022	REVISED -



PAVEMENT MARKING

SCALE: 1" = 20' SHEET 4 OF 5 SHEETS STA. TO STA.

F.A.U. RTE.	SECTION	COUNTY	TOTAL SHEETS	SHEET NO.
7145	21-00637-00-RS	CHAMPAIGN	20	14
CONTRACT NO.				
ILLINOIS FED. AID PROJECT				

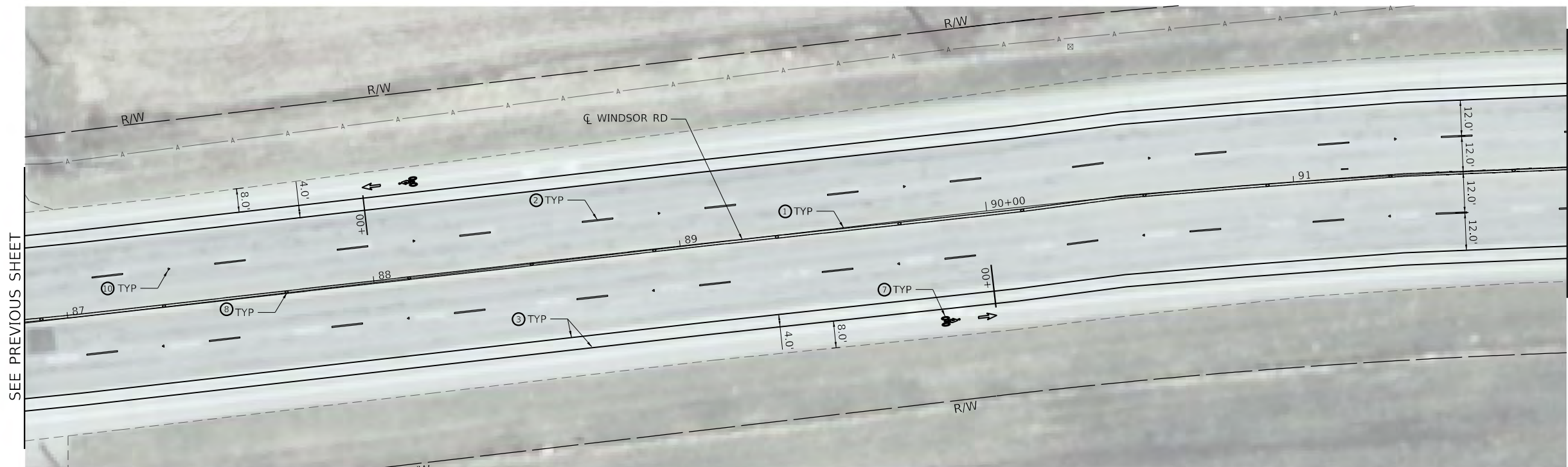

NOTE:
SHOULDER RUMBLE STRIPS, 16 INCH SHALL BE INSTALLED ACCORDING TO
THE "BIKE LANE LAYOUT HIGH VOLUME STREET" DETAIL ON SHEET 20

- ① THERMOPLASTIC PAVEMENT MARKING - LINE 4" (SOLID DOUBLE YELLOW)
- ② THERMOPLASTIC PAVEMENT MARKING - LINE 4" (WHITE, 10'-30' SKIP DASH)
- ③ THERMOPLASTIC PAVEMENT MARKING - LINE 6" (SOLID WHITE)
- ④ THERMOPLASTIC PAVEMENT MARKING - LINE 12" (SOLID YELLOW)
- ⑤ THERMOPLASTIC PAVEMENT MARKING - LINE 12" (SOLID WHITE)
- ⑥ THERMOPLASTIC PAVEMENT MARKING - LINE 24" (SOLID WHITE)
- ⑦ THERMOPLASTIC PAVEMENT MARKING - LETTERS AND SYMBOLS
- ⑧ RAISED REFLECTIVE PAVEMENT MARKERS (TWO-WAY AMBER)
- ⑨ RAISED REFLECTIVE PAVEMENT MARKERS (ONE-WAY AMBER)
- ⑩ RAISED REFLECTIVE PAVEMENT MARKERS (ONE-WAY CRYSTAL)

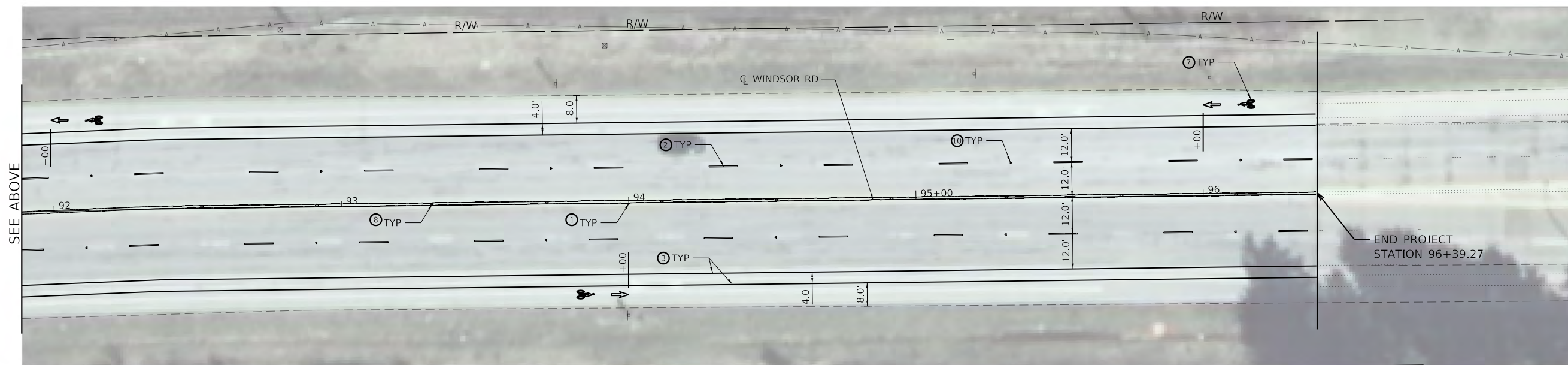

MODEL FILE NAME: C:\Users\BDS_2022\2022-1924_WINDSOR_RD_RESURFACING_CITY_OF_URBANA\CADD\CADD_Sheets\2022-1924-15-PMK.dgn



USER NAME = untitled	DESIGNED - MRS	REVISED -
DRAWN - MRS	REVISIONS -	
PLOT SCALE = 40.0000' / in.	CHECKED - BDS	REVISED -
PLOT DATE = 4/15/2022	DATE - 4/18/2022	REVISED -



PAVEMENT MARKING

SCALE: 1" = 20' SHEET 5 OF 5 SHEETS STA. TO STA.

F.A.U. RTE.	SECTION	COUNTY	TOTAL SHEETS	SHEET NO.
7145	21-00637-00-RS	CHAMPAIGN	20	15
CONTRACT NO.				
ILLINOIS FED. AID PROJECT				

GENERAL NOTES

1. LOOPS (C1, C2), (C3, C4), (D1, D2) & (D3, D4) WILL BE WIRED IN SERIES.
2. THE ADVANCE LOOPS WILL PROVIDE DILEMMA-ZONE PROTECTION DURING PHASE GREEN AND SERVE AS COUNTER LOOPS DURING PHASE RED

HIGHWAY STANDARDS

- 886001-01 DETECTOR LOOP INSTALLATIONS
 886006-01 TYPICAL LAYOUT FOR DETECTION LOOPS

ELECTRICAL SUMMARY OF QUANTITIES			
PAY ITEM	DESCRIPTION	UNIT	QUANTITY
88600600	DETECTOR LOOP REPLACEMENT	FOOT	428

DETECTOR LOOP REPLACEMENT LEGEND

- ☒ EX. HANDHOLE
- ☒ EX. TRAFFIC SIGNAL CONTROLLER
- ☐ ⋯⋯⋯⋯⋯⋯ EX. DETECTOR LOOP
- EXISTING CONDUIT
- ☐ =═══ PROPOSED DETECTOR LOOP

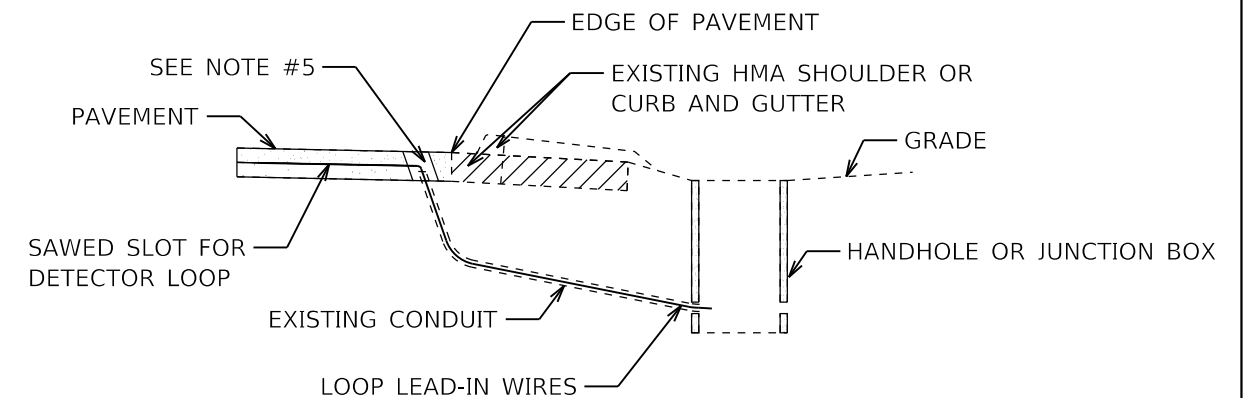

DETAIL A
(NO SCALE)

INSTALLING DETECTOR LOOP WIRES IN EXISTING CONDUIT

1. DRILL OUT PAVEMENT SEALANT AND CLEAN EXISTING CONDUIT.
2. REMOVE EXISTING DETECTOR LOOP WIRES TO HANDHOLE OR JUNCTION BOX.
3. INSTALL NEW LOOP-IN WIRES TO EXISTING CONDUIT.
4. SPLICE NEW DETECTOR LOOP WIRES TO EXISTING LOOP LEAD-IN CABLE IN HANDHOLE OR JUNCTION BOX.
5. FILL HOLE WITH APPROVED SEALER. PREVENT SEALER FROM ENTERING CONDUIT.
6. LOCATE UNDERGROUND CABLE WILL NOT BE PAID FOR SEPARATELY.

NOT A PAY ITEM. THE COST OF THIS WORK SHALL BE INCLUDED IN THE PAY ITEM "DETECTOR LOOP REPLACEMENT"

MODEL: C:\EIT\BBS\2022\22-1924\WINDSOR_RD_RESURFACING_CITY_OF_URBANA\CADD\CADD_Sheets\22-1924-16-TS-1.dgn



USER NAME = untitled	DESIGNED - MRS	REVISED -
	DRAWN - MRS	REVISED -
PLOT SCALE = 40.0000 ' / in.	CHECKED - BDS	REVISED -
PLOT DATE = 4/15/2022	DATE - 4/18/2022	REVISED -



TRAFFIC SIGNAL GENERAL NOTES AND DETAILS		F.A.U. RTE.	SECTION	COUNTY	TOTAL SHEETS	SHEET NO.
		7145	21-00637-00-R5	CHAMPAIGN	20	16
		CONTRACT NO.				
SCALE: NTS	SHEET 1 OF 2 SHEETS	STA.	TO STA.			
		ILLINOIS FED. AID PROJECT				

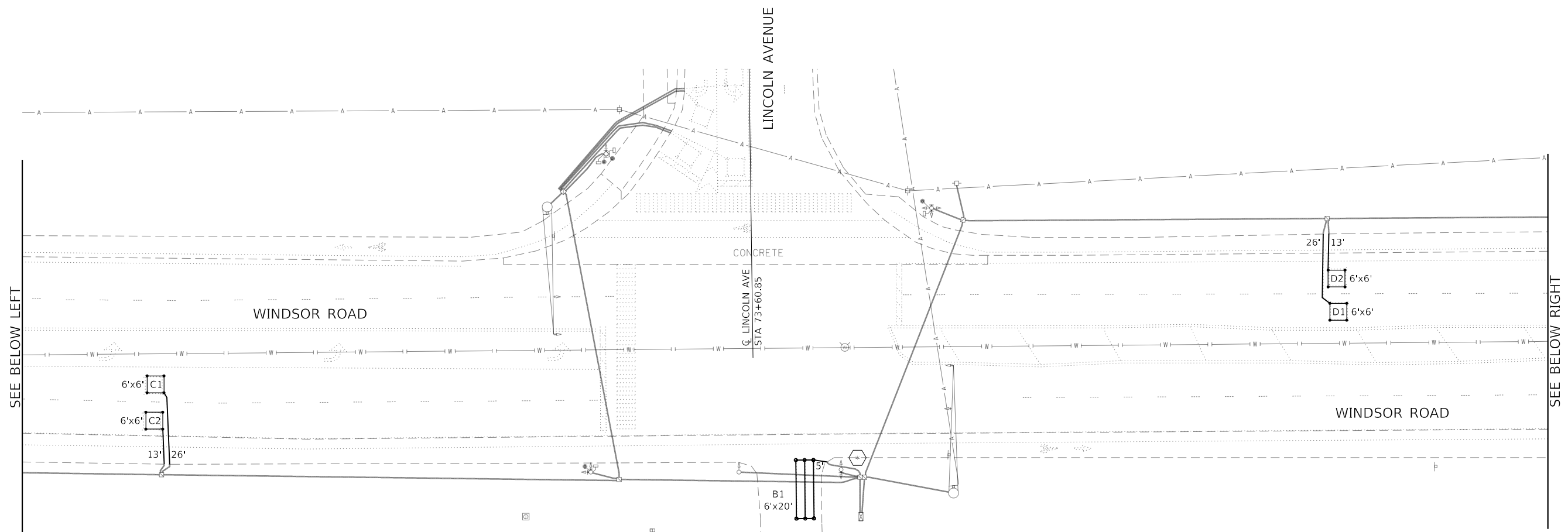

NOTES:
 SEE "DETAIL A" FOR INSTALLING DETECTOR LOOP WIRES IN EXISTING CONDUITS.
 * = SEE DETAIL A

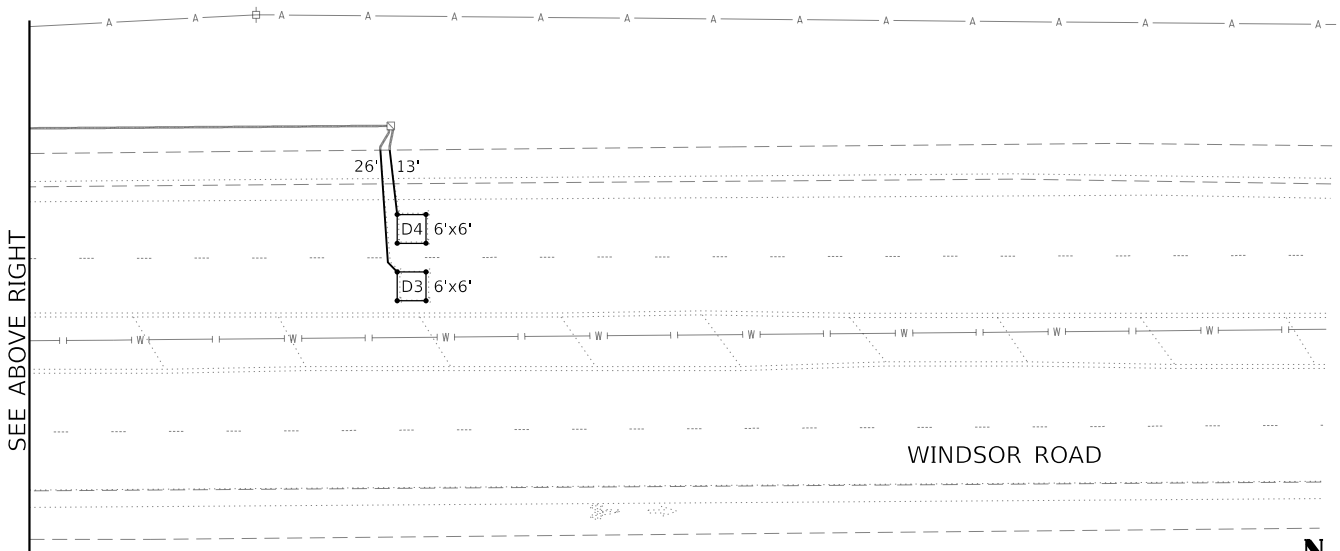
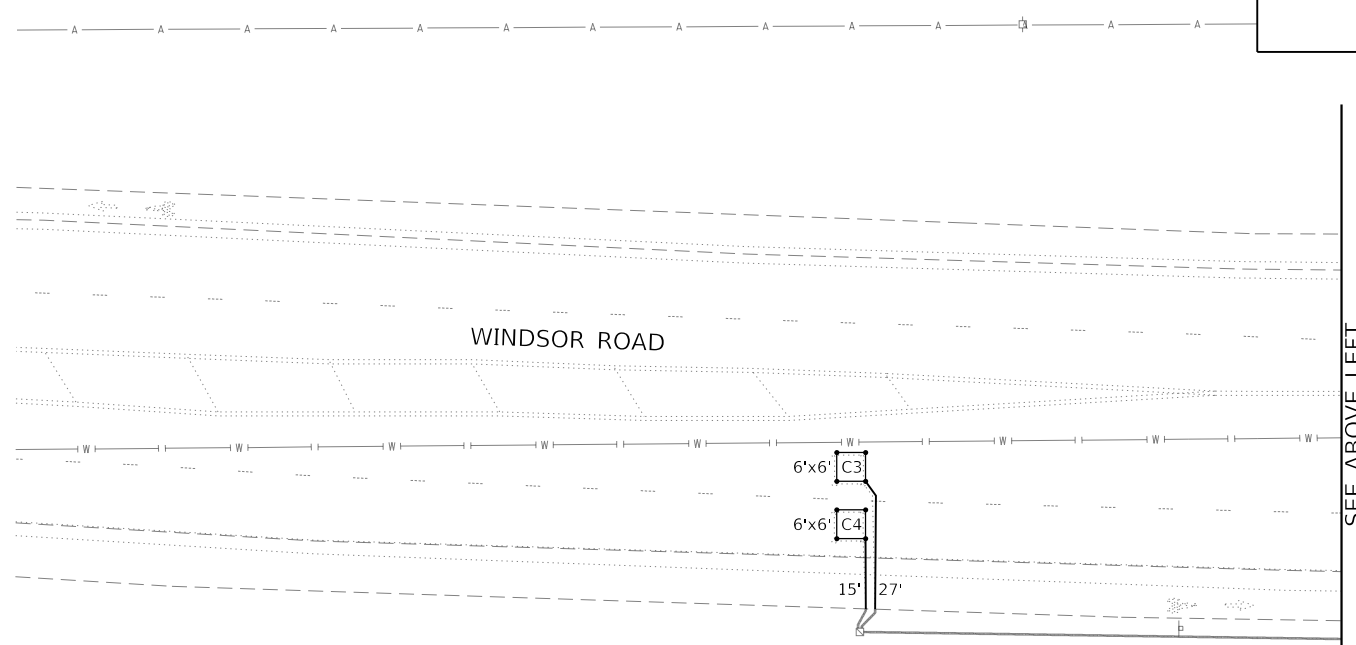

MODEL: C:\EIT\BIS_2022\2022-1924_WINDSOR_RD_RESURFACING_CITY_OF_URBANA\CADD\CADD_Sheets\22-1924-17-15-2.dwg
 FILE NAME: C:\EIT\BIS_2022\2022-1924_WINDSOR_RD_RESURFACING_CITY_OF_URBANA\CADD\CADD_Sheets\22-1924-17-15-2.dwg



USER NAME = untitled	DESIGNED - MRS	REVISED -
PLOT SCALE = 40,0000 ' / in.	DRAWN - MRS	REVISED -
PLOT DATE = 4/15/2022	CHECKED - BDS	REVISED -
	DATE - 4/18/2022	REVISED -



**WINDSOR ROAD AND LINCOLN AVENUE
 DETECTOR LOOP REPLACEMENT PLAN**

SCALE: 1" = 20' SHEET 2 OF 2 SHEETS STA. TO STA.

F.A.U. RTE.	SECTION	COUNTY	TOTAL SHEETS	SHEET NO.
7145	21-00637-00-R5	CHAMPAIGN	20	17
CONTRACT NO.				
ILLINOIS FED. AID PROJECT				



TYPICAL PAVEMENT MARKING LEGEND

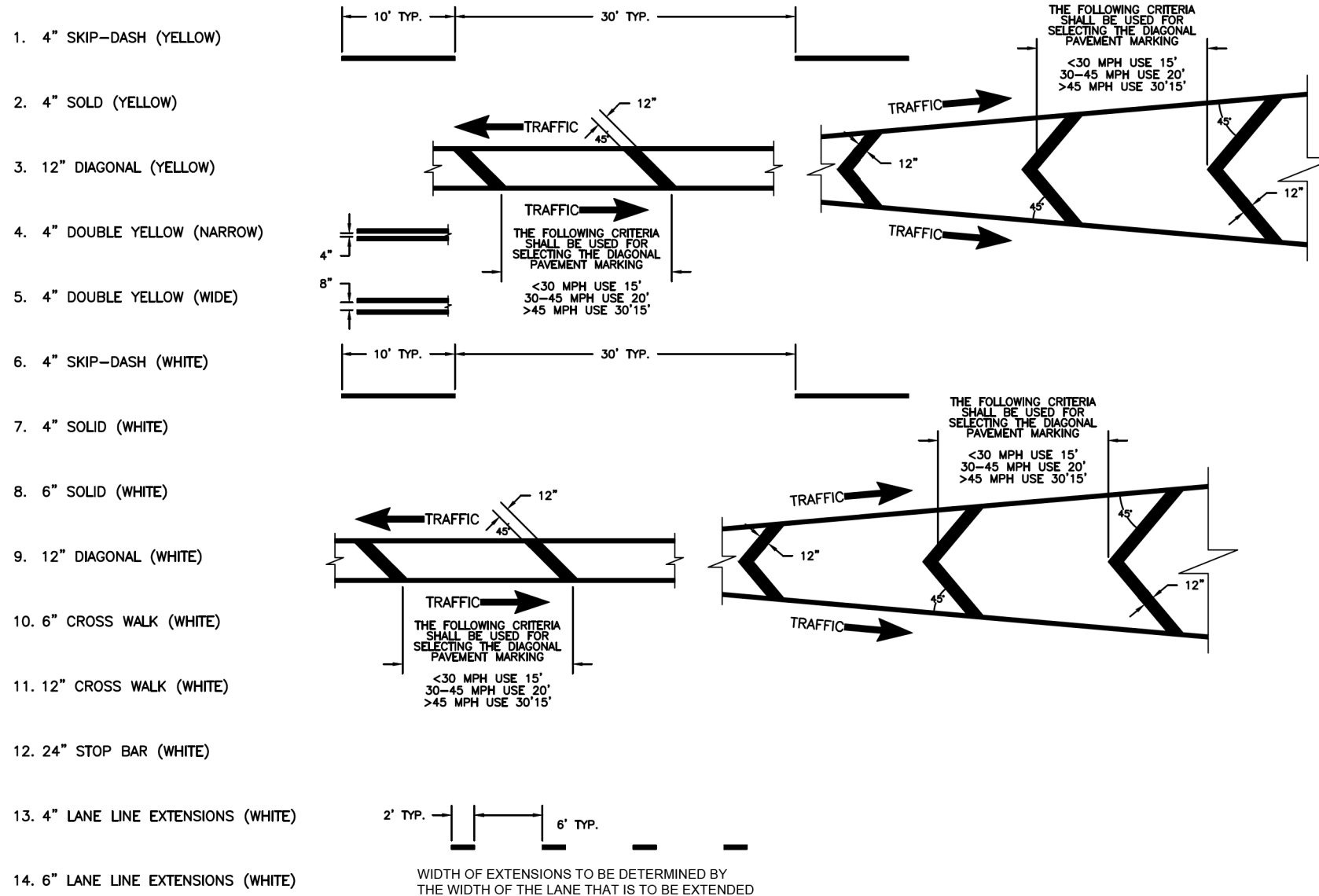

GENERAL NOTES:

1. WHEN PAVEMENT MARKINGS ARE TO BE PLACED ADJACENT TO MEDIANS, SPECIAL DETAILS WILL BE INCLUDED ELSEWHERE IN THE PLANS.
2. SOME INFORMATION INCLUDED IN THIS DETAIL MAY NOT BE APPLICABLE.
3. PAVEMENT MARKINGS ARE TO BE EXTENDED THROUGH OMISSIONS WHEN APPLICABLE.
4. A STRIPING KEY IS AVAILABLE ELSEWHERE AND SHALL BE SHOWN WHERE THE QUANTITIES ARE LISTED.
5. FINAL PAVEMENT MARKINGS SHALL BE IN PLACE PRIOR TO PLACING ANY RAISED REFLECTING PAVEMENT MARKERS.

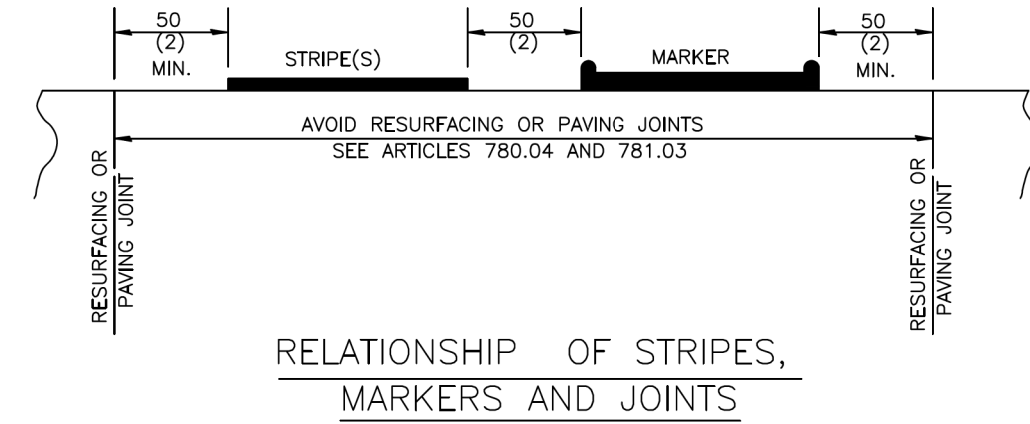

RELATIONSHIP OF STRIPES,
MARKERS AND JOINTS

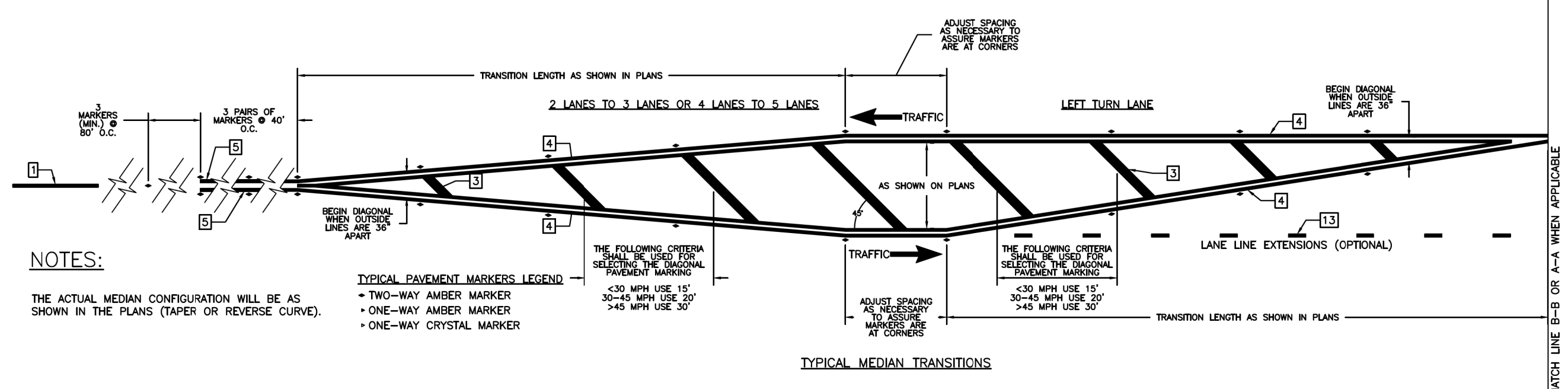

NOTES:

THE ACTUAL MEDIAN CONFIGURATION WILL BE AS SHOWN IN THE PLANS (TAPER OR REVERSE CURVE).

TYPICAL PAVEMENT MARKERS LEGEND

- TWO-WAY AMBER MARKER
- ONE-WAY AMBER MARKER
- ONE-WAY CRYSTAL MARKER

THE FOLLOWING CRITERIA SHALL BE USED FOR SELECTING THE DIAGONAL PAVEMENT MARKING

<30 MPH USE 15'
30-45 MPH USE 20'
>45 MPH USE 30'

THE FOLLOWING CRITERIA SHALL BE USED FOR SELECTING THE DIAGONAL PAVEMENT MARKING

<30 MPH USE 15'
30-45 MPH USE 20'
>45 MPH USE 30'

TYPICAL MEDIAN TRANSITIONS

MODEL: FILE NAME: C:\EIT\BIS_2022\22-1924_WINDSOR_RD_RESURFACING_CITY_OF_URBANA\CADD\CADD_Sheets\22-1924-18-20-Detail.dgn



USER NAME = untitled	DESIGNED - MRS	REVISED -
PLOT SCALE = 40.0000 ' / in.	DRAWN - MRS	REVISED -
PLOT DATE = 4/15/2022	CHECKED - BDS	REVISED -
	DATE - 4/18/2022	REVISED -



CITY OF URBANA DETAIL

SCALE: NTS SHEET 1 OF 3 SHEETS STA. TO STA.

F.A.U. RTE.	SECTION	COUNTY	TOTAL SHEETS	SHEET NO.
7145	21-00637-00-R5	CHAMPAIGN	20	18
CONTRACT NO.				
ILLINOIS FED. AID PROJECT				



SPECIAL NOTES:

TURN ARROW PAIRS SHALL BE PLACED AT 250' INTERVALS AND SHALL BE EVENLY SPACED BETWEEN BOTH ENDS OF THE BIDIRECTIONAL LEFT TURN LANE.

THE SOLID YELLOW PAVEMENT MARKINGS SHOULD GENERALLY START OR END NEAR RADIUS POINT OF EACH STREET RETURN EXCEPT WHERE ONE OR BOTH ENDS WOULD INCLUDE STOP BARS.

THE SKIP-DASH PAVEMENT MARKINGS 1 OR 6 SHOULD BE CENTERED BETWEEN BOTH ENDS OF EACH CITY BLOCK AND SHALL BE PLACED SO THEY LINE UP ACROSS FROM EACH OTHER.

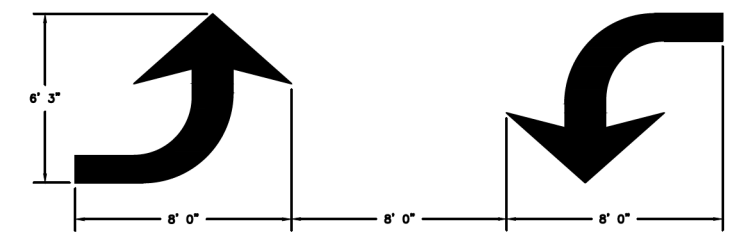

TYPICAL DOUBLE TURN ARROWS (WHITE)

CROSS WALK NOTES:

1.) IF TRANSVERSE LINES ARE USED TO MARK A CROSSWALK, THE GAP BETWEEN THE LINES SHOULD NOT BE LESS THAN 6 FEET. IF DIAGONAL OR LONGITUDINAL LINES ARE USED WITHOUT TRANSVERSE LINES TO MARK A CROSSWALK, THE CROSSWALK SHOULD BE NOT LESS THAN 6 FEET WIDE.

2.) IF USED, THE DIAGONAL OR LONGITUDINAL LINES SHOULD BE 12 TO 24 INCHES WIDE AND SEPARATED BY GAPS OF 12 TO 60 INCHES. THE DESIGN OF THE LINES AND GAPS SHOULD AVOID THE WHEEL PATHS IF POSSIBLE, AND THE GAP BETWEEN THE LINES SHOULD NOT EXCEED 2.5 TIMES THE WIDTH OF THE DIAGONAL OR LONGITUDINAL LINES.

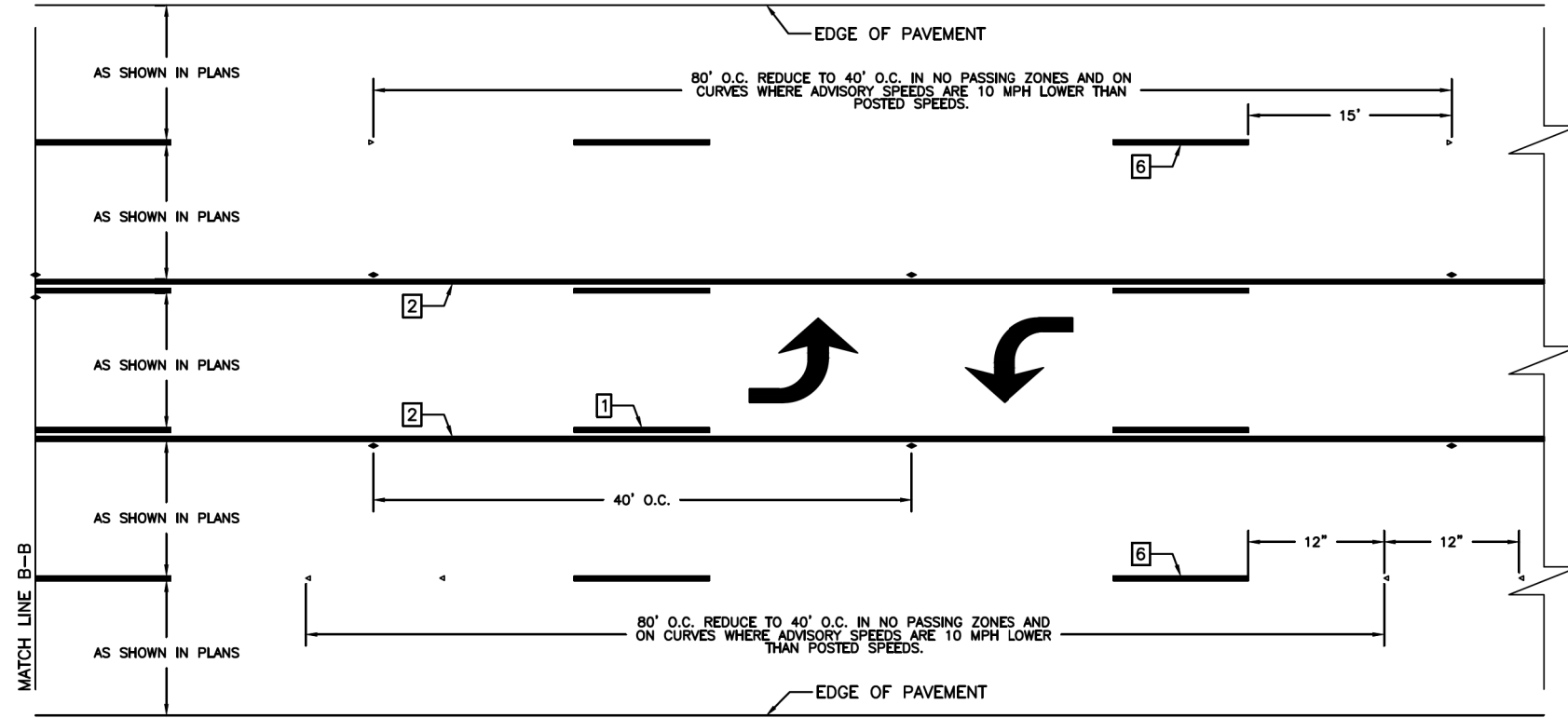

TYPICAL MULTI-LANE WITH BI-DIRECTIONAL LEFT TURN LANE

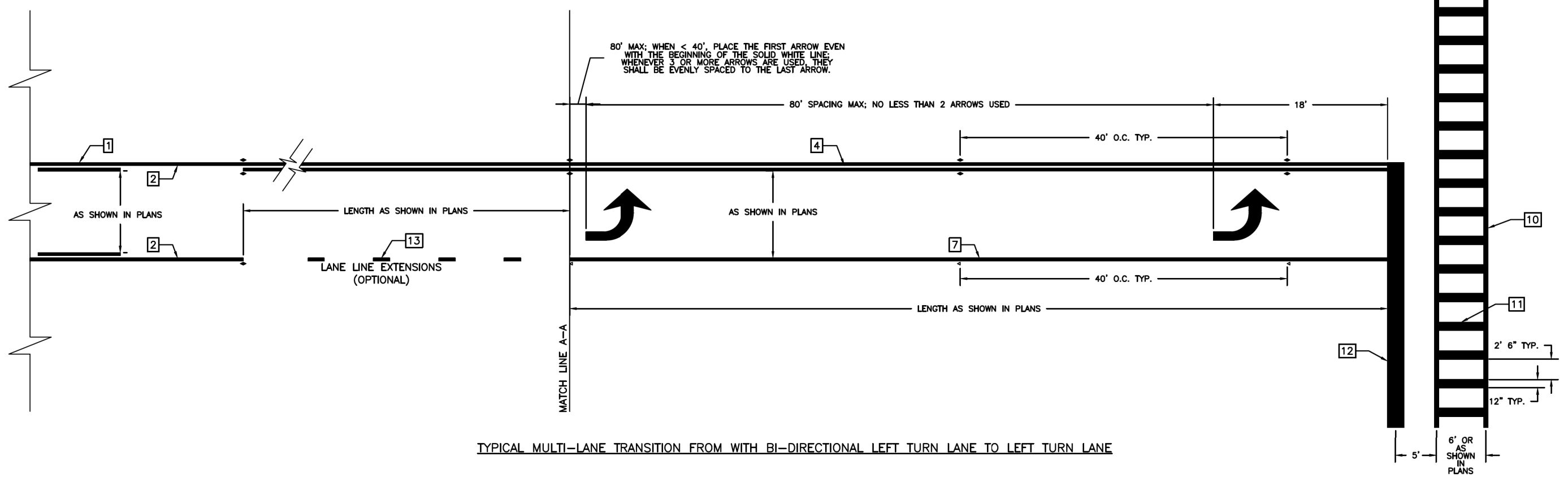

TYPICAL MULTI-LANE TRANSITION FROM WITH BI-DIRECTIONAL LEFT TURN LANE TO LEFT TURN LANE

MODEL: FILE NAME: C:\EIT\BDS\2022\22-1924-WINDSOR_RD_RESURFACING_CITY_OF_URBANA\CADD\CADD_SHEET\22-1924-18-20-Detail.dwg



USER NAME = untitled	DESIGNED - MRS	REVISED -
PLOT SCALE = 40,0000 ' / in.	DRAWN - MRS	REVISED -
PLOT DATE = 4/15/2022	CHECKED - BDS	REVISED -
	DATE - 4/18/2022	REVISED -



CITY OF URBANA DETAIL

SCALE: NTS SHEET 2 OF 3 SHEETS STA. TO STA.

F.A.U. RTE.	SECTION	COUNTY	TOTAL SHEETS	SHEET NO.
7145	21-00637-00-RS	CHAMPAIGN	20	19
CONTRACT NO.				
ILLINOIS FED. AID PROJECT				

BIKE LANE ARROW DETAIL
AREA = 4.25 SQ FT

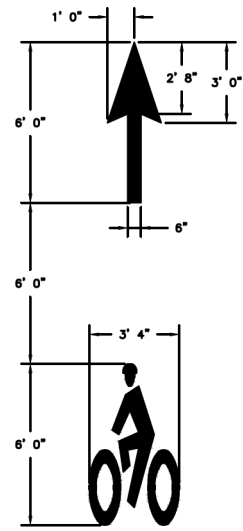

BIKE RIDER SYMBOL DETAIL
AREA = 6.5 SQ FT

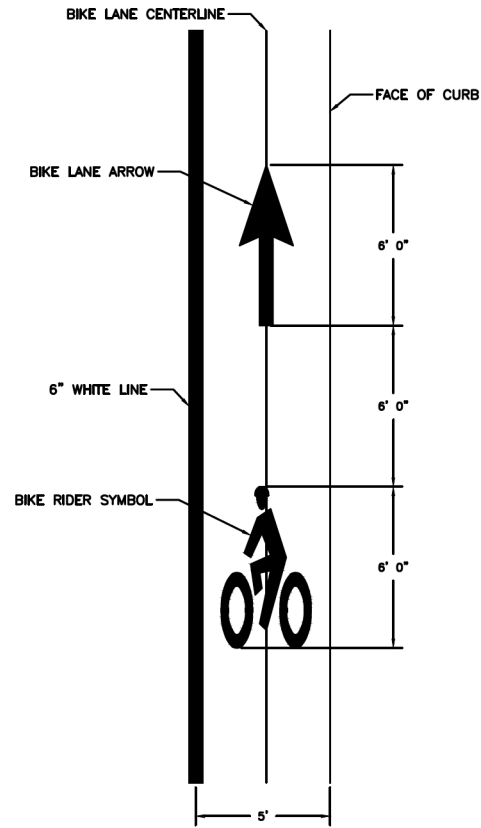

TYPICAL BIKE LANE LAYOUT

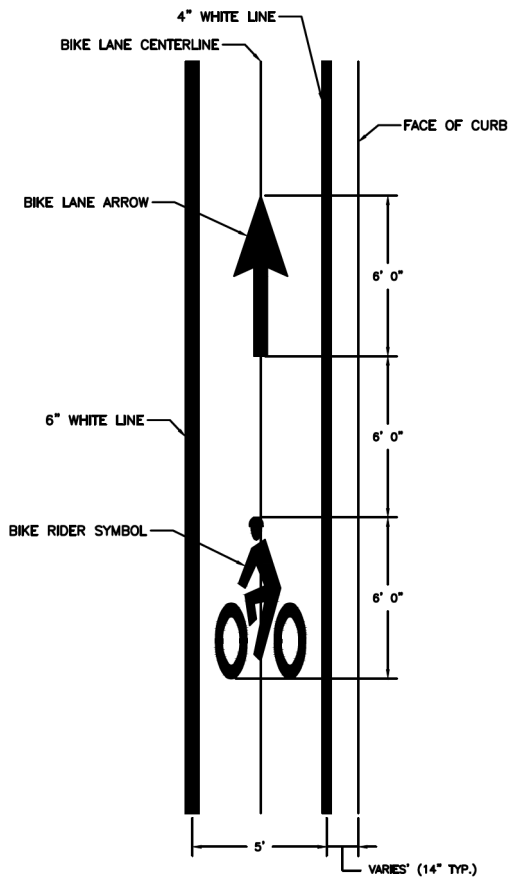

BIKE LANE LAYOUT OFFSET FROM EDGE OF PAVEMENT

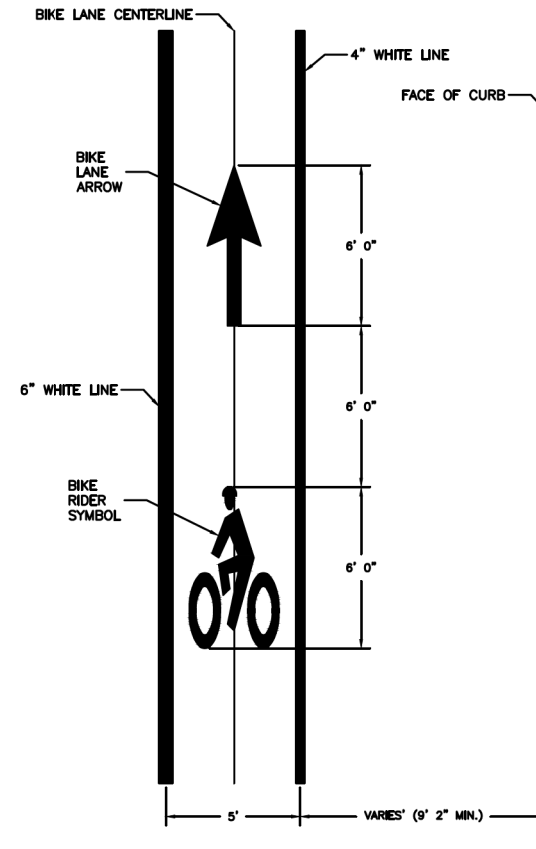

BIKE LANE LAYOUT WITH ON STREET PARKING

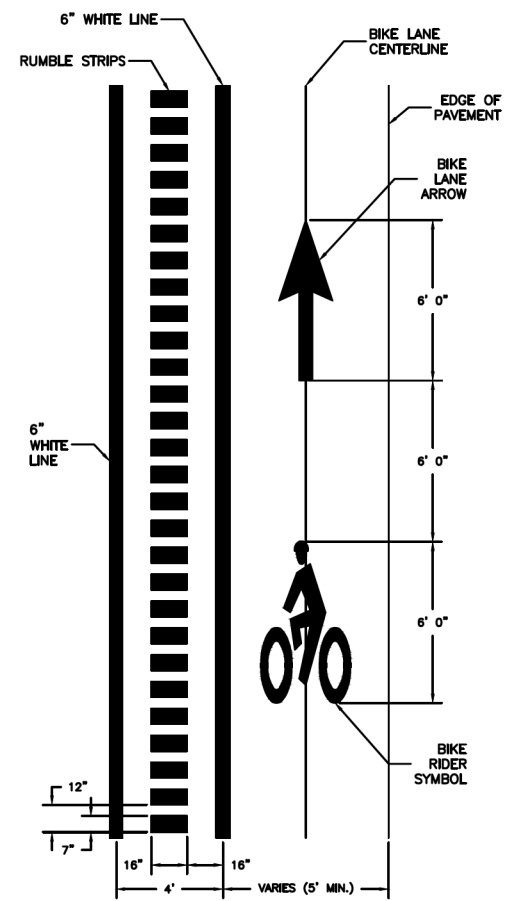

BIKE LANE LAYOUT HIGH VOLUME STREET

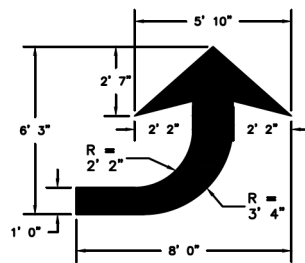

LEFT TURN ARROW
(REVERSE FOR RIGHT ARROW)
AREA = 14.8 SQ FT (WHITE)

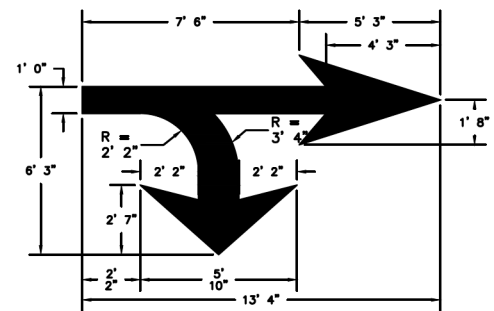

2 ARROW COMBINATION RIGHT AND THROUGH
(REVERSE FOR LEFT ARROW)
AREA = 26.3 SQ FT (WHITE)

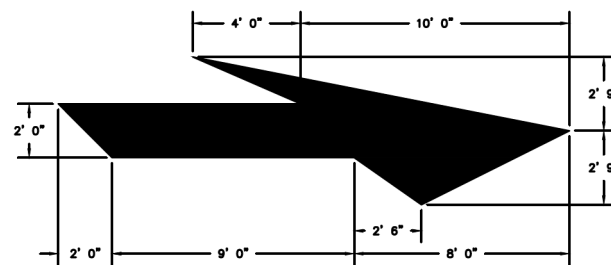

LANE DROP ARROW
AREA = 42.0 SQ FT (WHITE)

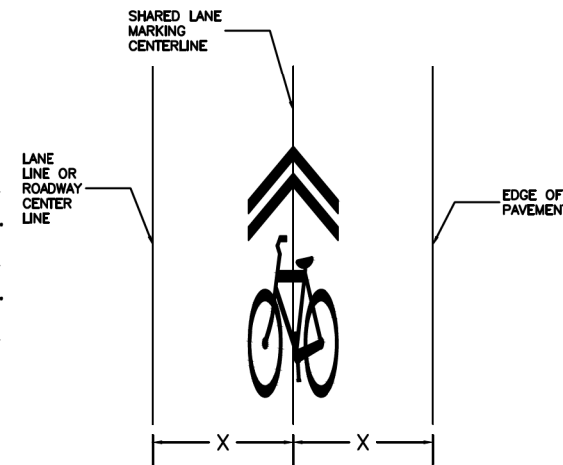

SHARED LANE MARKING LAYOUT

NOTES:

PLACE SHARED LANE MARKING IN THE CENTER OF THE TRAVEL LANE

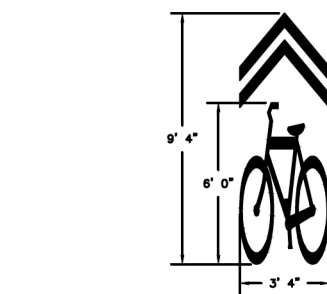

SHARED LANE MARKING DETAIL
AREA = 8.0 SQ FT

MODEL FILE NAME: C:\EIT\BIS\2022\22-1924-WINDSOR_RD_RESURFACING_CITY_OF_URBANA\CADD\CADD_Sheets\22-1924-18-20-Detail.dgn