

NOTES

1. BEARINGS BASED ON ILLINOIS STATE PLANE COORDINATE SYSTEM, EAST ZONE. HORIZONTAL COORDINATES ARE BASED ON A LOCAL GROUND DATUM.
2. HORIZONTAL CENTERLINE CONTROL POINTS ARE SHOWN FOR THE CONTRACTOR TO PHYSICALLY LOCATE MONUMENTATION IN THE FIELD. IT IS THE CONTRACTOR'S RESPONSIBILITY TO MAINTAIN CENTERLINE CONTROL POINTS AND SET ADDITIONAL POINTS AND TIES AS NECESSARY TO INSURE THAT CONTROL POINTS CAN BE ACCURATELY REPLICATED DURING CONSTRUCTION.

BENCHMARKS

- #10 TOP CENTER CAP BOLT OF FH IN THE N.E. QUAD OF GREEN ST. AND WRIGHT ST. ELEV. = 724.20
- "H" N.N.W. CAP BOLT OF FH AT THE NORTH SIDE OF GREEN ST. AT THE ILLINOIS UNION. ELEV. = 723.49
- "I" N.N.W. CAP BOLT OF FH IN THE S.E. QUAD OF GREEN ST. AND MATHEWS AVE. ELEV. = 720.46
- "J" N.N.E. CAP BOLT OF FH IN THE N.W. QUAD OF GREEN ST. AND GOODWIN AVE. ELEV. = 717.94
- "K" N. CAP BOLT OF FH ON THE SOUTH SIDE OF 1107 GREEN ST. ELEV. = 721.48
- "L" N.W. CAP BOLT OF FH IN THE S.W. QUAD OF GREEN ST. AND LINCOLN AVE. ELEV. = 720.36
- "M" TOP CENTER CAP BOLT OF FH ON THE S. SIDE OF GREEN ST. AND GREGORY AVE. (N. HYDRANT). ELEV. = 718.66
- "N" TOP CENTER CAP BOLT OF FH IN THE S.W. QUAD OF GREEN ST. AND BUSEY AVE. ELEV. = 719.07

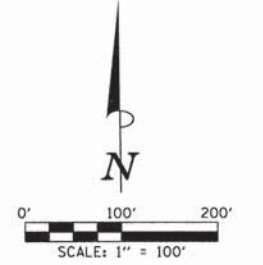

| | | |
|----------|-----|----------|
| LAYOUT | RLA | 11/24/15 |
| DRAWN | RLA | 2/4/16 |
| REVIEWED | MGD | 3/22/16 |

| | |
|-------------|---|
| FILE NAME = | Z:\Plans\sheets\Project1\P1-sht-atb01.dgn |
| PLOT DATE = | 8/25/2016 1:26:22 PM |

| | | | |
|------------|-----------|-----------|--|
| DESIGNED - | RLA | REVISED - | |
| DRAWN - | RLA | REVISED - | |
| CHECKED - | MGD | REVISED - | |
| DATE - | 8/26/2016 | REVISED - | |

STATE OF ILLINOIS
DEPARTMENT OF TRANSPORTATION

PROJECT 1 - GREEN STREET
HORIZONTAL ALIGNMENT LAYOUT AND CONTROL

SCALE: 1"=100' SHEET NO. OF SHEETS STA. TO STA.

| | | | | |
|--|----------------|--------------------|--------------|-----------|
| F.A.U. RTE. | SECTION | COUNTY | TOTAL SHEETS | SHEET NO. |
| 7126 | 15-00304-01-PV | CHAMPAIGN | 236 | 22 |
| MCORE PROJECT 1 | | CONTRACT NO. 91539 | | |
| JOB NO. C-95-305-16 ILLINOIS FED. AID PROJECT TIC-51810571 | | | | |

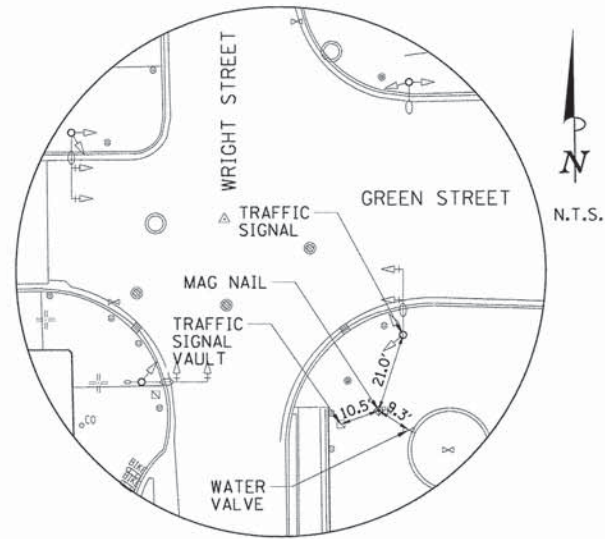

CONTROL POINT #1
 STA. 1001+87.58, 50.64' RT.
 MAG NAIL

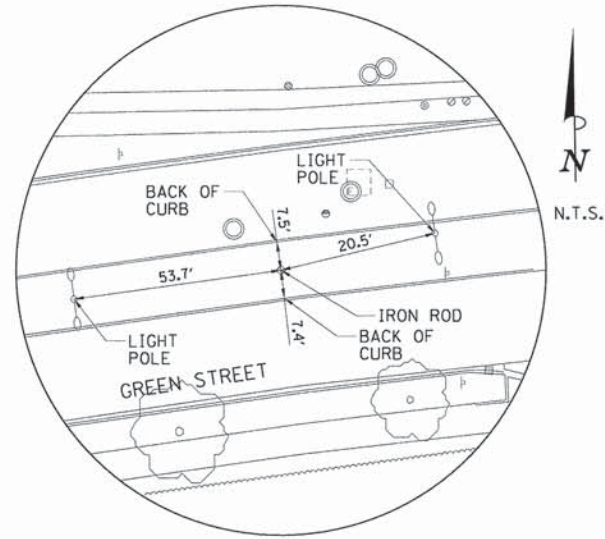

CONTROL POINT #77
 STA. 1007+17.19, 13.52' RT.
 IRON ROD

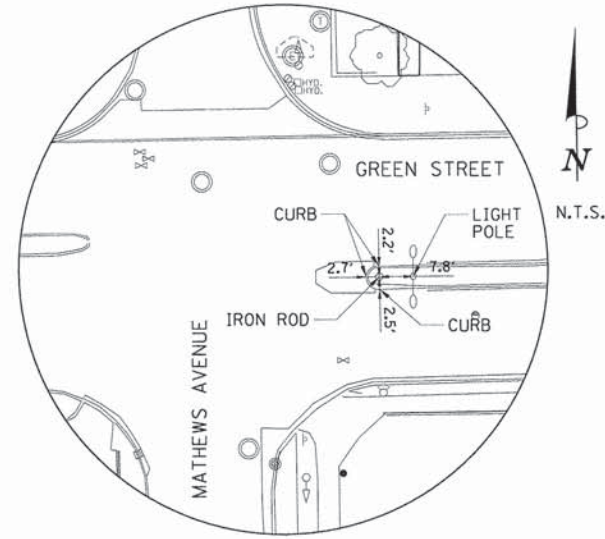

CONTROL POINT #76
 STA. 1011+19.87, 4.76' RT.
 IRON ROD

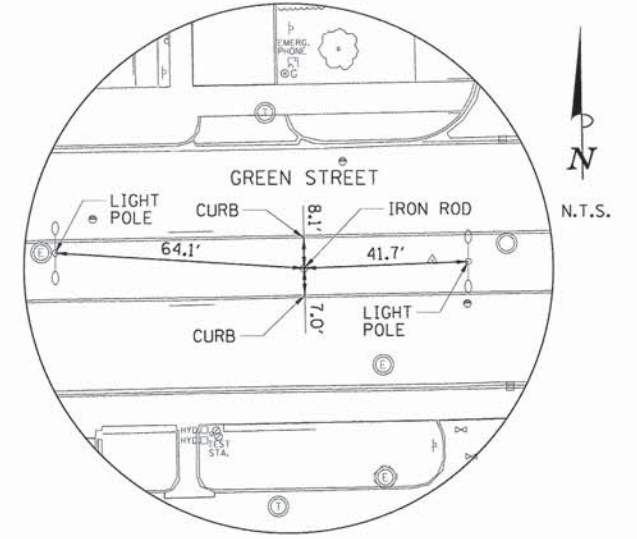

CONTROL POINT #78
 STA. 1019+22.04, 0.46' RT.
 IRON ROD

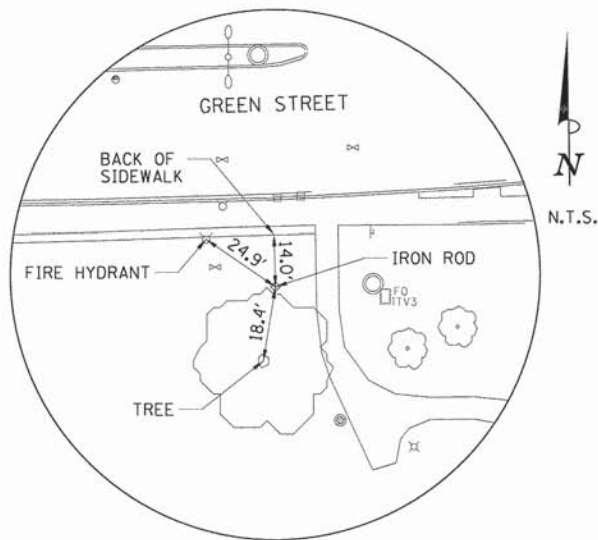

CONTROL POINT #79
 STA. 1024+52.10, 55.01' RT.
 IRON ROD

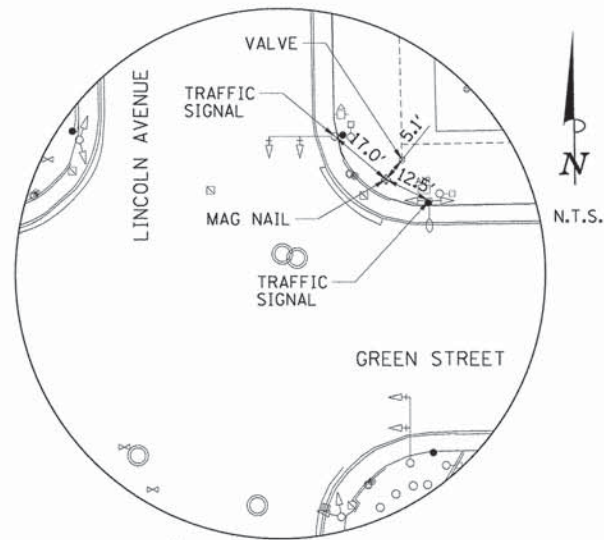

CONTROL POINT #80
 STA. 1028+82.03, 43.48' LT.
 MAG NAIL

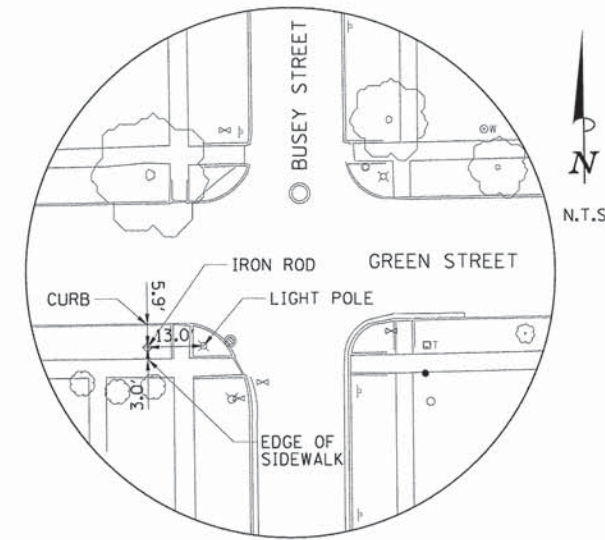

CONTROL POINT #81
 STA. 1032+33.73, 21.60' RT.
 IRON ROD

NOTES:

- SEE HORIZONTAL ALIGNMENT LAYOUT AND CONTROL SHEETS FOR NORTHING AND EASTING COORDINATES.
- STATION AND OFFSETS ARE APPROXIMATE AND FOR REFERENCE ONLY.

| | | |
|----------|-----|----------|
| LAYOUT | RLA | 11/24/15 |
| DRAWN | RLA | 2/4/16 |
| REVIEWED | MGD | 3/22/16 |

FILE NAME = Z:\Plans\sheets\Project1\P1-sht-atb02.dgn
 PLOT DATE = 8/25/2016 1:26:27 PM

DESIGNED - RLA
 DRAWN - RLA
 CHECKED - MGD
 DATE - 8/26/2016

REVISED -
 REVISED -
 REVISED -
 REVISED -

STATE OF ILLINOIS
 DEPARTMENT OF TRANSPORTATION

PROJECT 1 - GREEN STREET
 SURVEY CONTROL TIES

SCALE: N/A SHEET NO. OF SHEETS STA. TO STA.

| F.A.U. RTE. | SECTION | COUNTY | TOTAL SHEETS | SHEET NO. |
|---|----------------|-----------|--------------------|-----------|
| 7126 | 15-00304-01-PV | CHAMPAIGN | 236 | 23 |
| MCORE PROJECT 1 | | | CONTRACT NO. 91539 | |
| JOB NO. C-95-305-16 ILLINOIS FED. AID PROJECT TIG-5181057 | | | | |