

SEE GREEN STREET PLAN AND PROFILES FOR ADDITIONAL INFORMATION.

SEE PAVEMENT JOINTS AND INTERSECTION DETAILS FOR ADDITIONAL INFORMATION.

SEE DRAINAGE PLANS AND SCHEDULES FOR ADDITIONAL INFORMATION.

GOODWIN AVENUE STEAM TUNNEL NOTE: STA. 1016+00 TO STA. 1016+20 EXISTING BRICK STEAM TUNNEL CROSSING UNDER GREEN STREET.

GOODWIN AVENUE STEAM TUNNEL NOTE: SOUTH OF STA. 1201+70 EXISTING BRICK STEAM TUNNEL CROSSING UNDER GOODWIN AVENUE.

EXTREME CAUTION SHALL BE EXERCISED BY ALL CONTRACTORS TO AVOID DISTURBING OR DAMAGING THE TUNNEL. BREAKERS SHALL NOT BE USED WITHIN 10 FEET EAST AND WEST OF THE TUNNEL AND ONCE THE EXISTING PAVEMENT IS REMOVED NO EQUIPMENT OR TRUCKS SHALL BE ALLOWED TO DRIVE OVER THE TUNNEL UNTIL THE FINAL PAVEMENT HAS BEEN CONSTRUCTED.

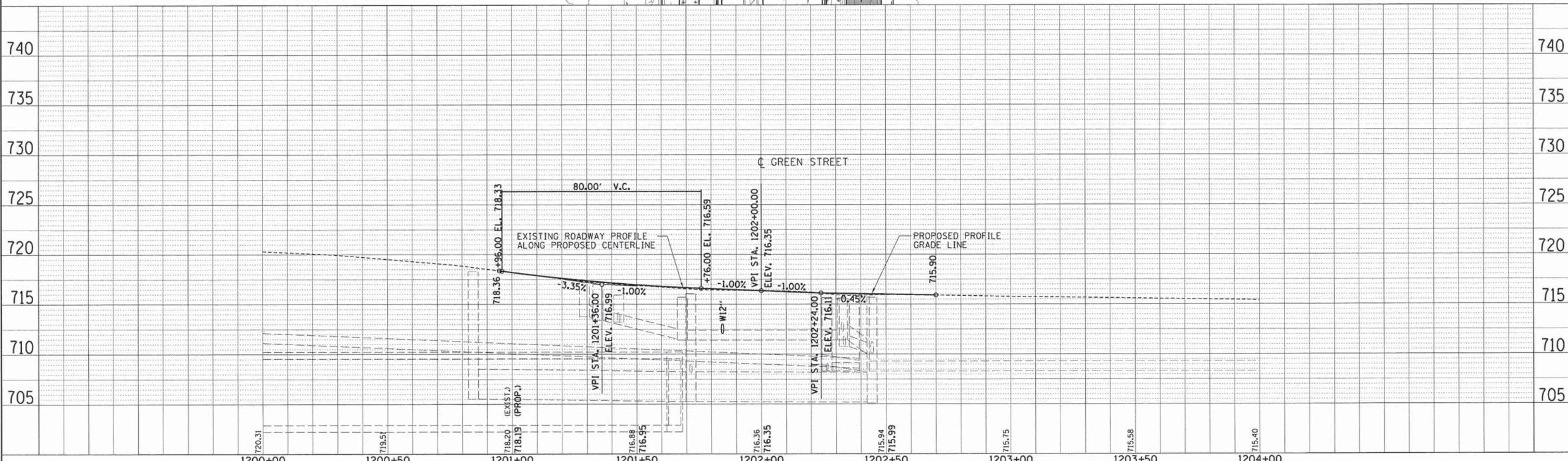

FILE NAME = Z:\Plans\sheets\Project1\PI-sht-GWN-plnprof01.dgn	DESIGNED - DLC	REVISED -	PROJECT 1 - GOODWIN AVENUE		F.A.U. R.T.E. 7126	SECTION 15-00304-01-PV	COUNTY CHAMPAIGN	TOTAL SHEETS 236	SHEET NO. 44
PLOT DATE = 8/25/2016 12:19:28 PM	DRAWN - RLA	REVISED -	STATE OF ILLINOIS DEPARTMENT OF TRANSPORTATION		MCORE PROJECT 1		CONTRACT NO. 91539		
	CHECKED - MGD	REVISED -	SCALE: 1"=20'		SHEET NO.	OF SHEETS	STA. 1200+95.00 TO STA. 1202+70.00	JOB NO. C-95-305-16 ILLINOIS FED. AID PROJECT TIG-51810571	
	DATE - 8/26/2016	REVISED -							

PLAN	DATE
BY	
DATE	
NO.	
NO.	
NO.	

PROFILE	DATE
BY	
DATE	
NO.	
NO.	
NO.	

LAYOUT	DLC	11/24/15
DRAWN	RLA	2/4/16
REVIEWED	MGD	3/22/16

